

**OHIO TURNPIKE AND
INFRASTRUCTURE COMMISSION**

ADDENDUM NO. 2

PROJECT NO. 59-16-02

**REPAIRS AND RESURFACING
EASTBOUND AND WESTBOUND ROADWAYS
MILEPOST 55.45 TO MILEPOST 69.30
LUCAS AND WOOD COUNTIES, OHIO**

OPENING DATE: *EXTENDED TO 2:00 P.M. (EASTERN TIME), FEBRUARY 17 24, 2016*

ALL BIDS MUST BE ELECTRONICALLY SUBMITTED

**RESPONSES TO QUESTIONS RECEIVED
THROUGH 5:00 P.M. FEBRUARY 10, 2016**

AND

**CHANGES TO THE
PLAN SHEET NOS. 2, 3, 18 AND 19
BID SCHEDULE OF ITEMS**

AND

**CHANGES TO THE
COVER PAGE AND NOTICE TO BIDDERS**

Issued by the Ohio Turnpike and Infrastructure Commission on February 11, 2016. Issuance authorized by Anthony D. Yacobucci, Chief Engineer, and Mark R. Musson, Director of Contract Administration.

Anthony D. Yacobucci Date 2/11/16

Mark R. Musson Date 2/11/16

**OHIO TURNPIKE AND INFRASTRUCTURE COMMISSION
ADDENDUM NO. 2
PROJECT NO. 59-16-02**

ANSWERS TO QUESTIONS RECEIVED THROUGH 5:00 P.M., FEBRUARY 10, 2016

Q#1 Can the resurfacing limits of both interchange ramps be specified or clarified. There are no work limits shown on the plans.

A#1 A Plan Note has been added to Plan Sheet 2 of 19 and 3 of 19 providing the approximate ramp milling and paving limits for Interchange 59 and Interchange 64. The revised Plan Sheets are incorporated into the Contract Documents with this Addendum No. 2.

Q#2 On sheet 19/19 the table in the left corner, has both the LFT/CNTR lanes listed. Please clarify if these repairs are in the center and left lanes, or just the center lane or just the left lane.

A#2 For clarification, the table on sheet 19 of 19 has been revised to show repairs occurring in the **CENTER** lane. The revised Plan Sheet 19 of 19 is incorporated into the Contract Documents with this Addendum No. 2.

The following changes are made to the Contract Documents for Contract No. 59-16-02:

Modifications to the Plan Drawings: Additions are called out with a cloud and deletions are marked with a revision triangle as thus:



Plan Sheets 2, 3 and 19 are modified as described in the responses to Q#1 and Q#2 above.

Plan Sheet 18 of 19 and the Bid Schedule are modified to insert a pay item Ref. No. 67 and estimated quantity of **6,200 Gallons** for **ITEM SPECIAL - LONGITUDINAL JOINT STABILIZER, POLYMER EMULSION**.

The Plan Sheet Nos. 2, 3, 18 and 19 of 19 and the revised Bid Form are provided and incorporated into this Contract Documents with this Addendum No. 2

The Notice to Bidders and Cover Page are modified to extend the bid opening date one week from 2:00PM on February ~~4~~7, 2016 to 2:00PM on February **24**, 2016

Addendum No. 2 to Contract 59-16-02 is hereby acknowledged:

(Firm Name)

(Signature)

(Printed Name)

Date: _____

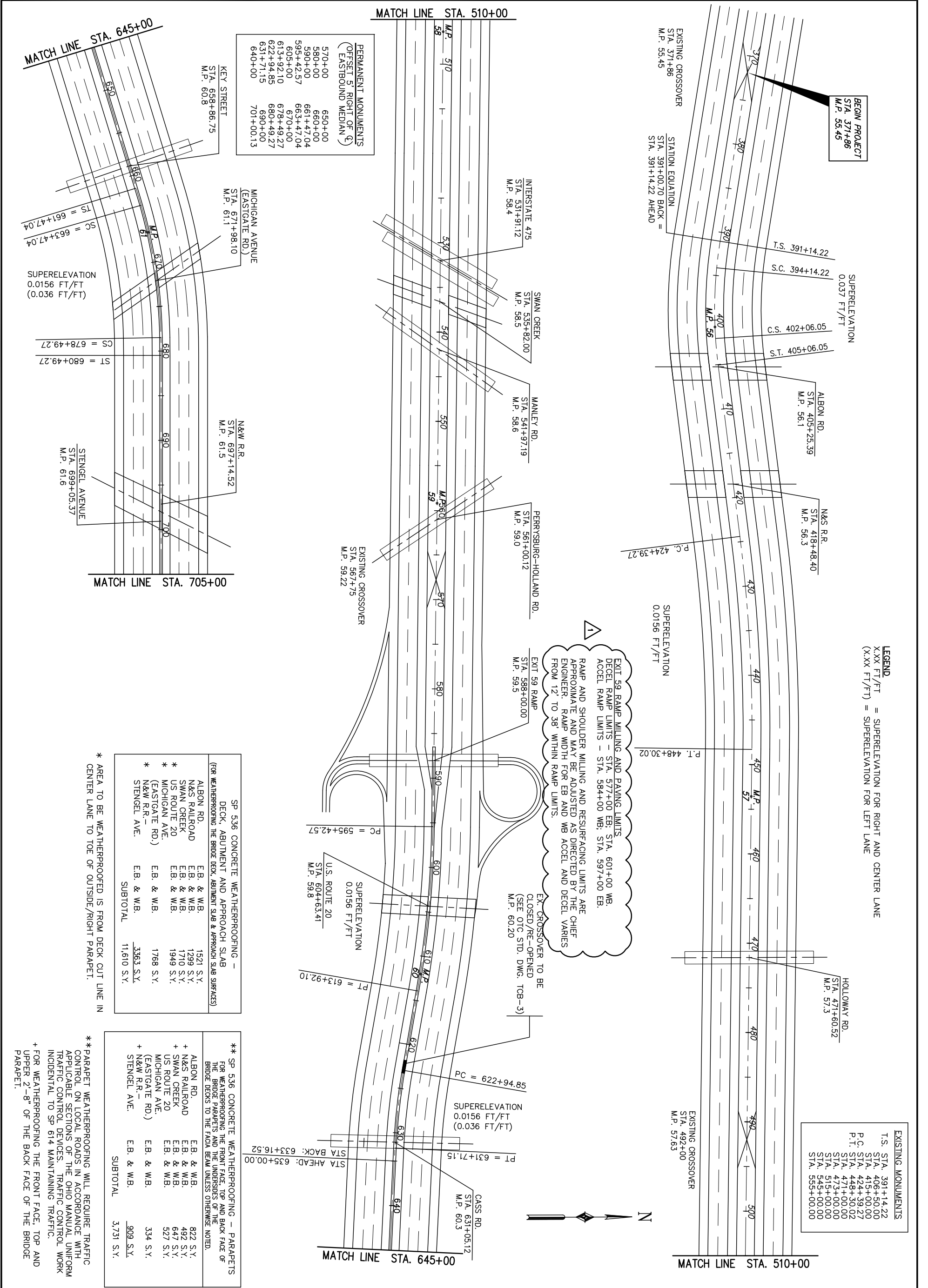

BEGIN PROJECT
STA. 371+86
M.P. 55.45

SUPERELEVATION
0.037 FT/FT

LEGEND
X.XX FT/FT = SUPERELEVATION FOR RIGHT AND CENTER LANE
(X.XX FT/FT) = SUPERELEVATION FOR LEFT LANE

EXISTING MONUMENTS

T.S.	STA. 391+14.22
	STA. 406+50.00
	STA. 415+00.00
P.C.	STA. 424+39.27
P.T.	STA. 448+30.02
	STA. 471+00.00
	STA. 473+00.00
	STA. 515+00.00
	STA. 545+00.00
	STA. 555+00.00

PERMANENT MONUMENTS
(OFFSET ST. RIGHT OF EASTBOUND MEDIAN)

570+00	650+00
580+00	660+00
590+00	661+47.04
595+42.57	663+47.04
605+00	670+00
613+92.10	678+49.27
622+94.85	680+49.27
631+71.15	690+00
640+00	701+00.13

KEY STREET
STA. 658+86.75
M.P. 60.8

MICHIGAN AVENUE
(EASTGATE RD.)
STA. 671+98.10
M.P. 61.1

N&W R.R.
STA. 697+14.52
M.P. 61.5

STENDEL AVENUE
STA. 699+05.37
M.P. 61.6

SP 536 CONCRETE WEATHERPROOFING - DECK, ABUTMENT AND APPROACH SLAB (FOR WEATHERPROOFING THE BRIDGE DECK, ABUTMENT SLAB & APPROACH SLAB SURFACES)

ALBON RD.	E.B. & W.B.	1521 S.Y.
N&S RAILROAD	E.B. & W.B.	1299 S.Y.
SWAN CREEK	E.B. & W.B.	1710 S.Y.
US ROUTE 20	E.B. & W.B.	1949 S.Y.
MICHIGAN AVE.	E.B. & W.B.	1768 S.Y.
(EASTGATE RD.)	E.B. & W.B.	1768 S.Y.
N&W R.R.	E.B. & W.B.	3363 S.Y.
STENDEL AVE.	E.B. & W.B.	11,610 S.Y.
	SUBTOTAL	33,633 S.Y.

** SP 536 CONCRETE WEATHERPROOFING - PARAPETS FOR WEATHERPROOFING THE FRONT FACE, TOP AND BACK FACE OF THE BRIDGE DECKS TO THE FACE BEAM UNLESS OTHERWISE NOTED.

ALBON RD.	E.B. & W.B.	822 S.Y.
N&S RAILROAD	E.B. & W.B.	492 S.Y.
SWAN CREEK	E.B. & W.B.	647 S.Y.
US ROUTE 20	E.B. & W.B.	527 S.Y.
MICHIGAN AVE.	E.B. & W.B.	334 S.Y.
(EASTGATE RD.)	E.B. & W.B.	334 S.Y.
N&W R.R.	E.B. & W.B.	909 S.Y.
STENDEL AVE.	E.B. & W.B.	3,731 S.Y.
	SUBTOTAL	3,731 S.Y.

* AREA TO BE WEATHERPROOFED IS FROM DECK CUT LINE IN CENTER LANE TO TOE OF OUTSIDE/RIGHT PARAPET.

** PARAPET WEATHERPROOFING WILL REQUIRE TRAFFIC CONTROL ON LOCAL ROADS IN ACCORDANCE WITH APPLICABLE SECTIONS OF THE OHIO MANUAL UNIFORM TRAFFIC CONTROL DEVICES. TRAFFIC CONTROL WORK INCIDENTAL TO SP 614 MAINTAINING TRAFFIC.

+ FOR WEATHERPROOFING THE FRONT FACE, TOP AND UPPER 2'-8" OF THE BACK FACE OF THE BRIDGE PARAPET.

DESIGNED	JJS	CHECKED	TWB	NO.	1	REVISIONS	ADDENDUM NO. 1	BY	JJS	DATE	2/10/16	DESIGN AGENCY	
DRAWN	JJS	IN CHARGE	DCA										

RESURFACING PLAN
STA. 371+86 TO STA. 705+00

PROJECT 59-16-02

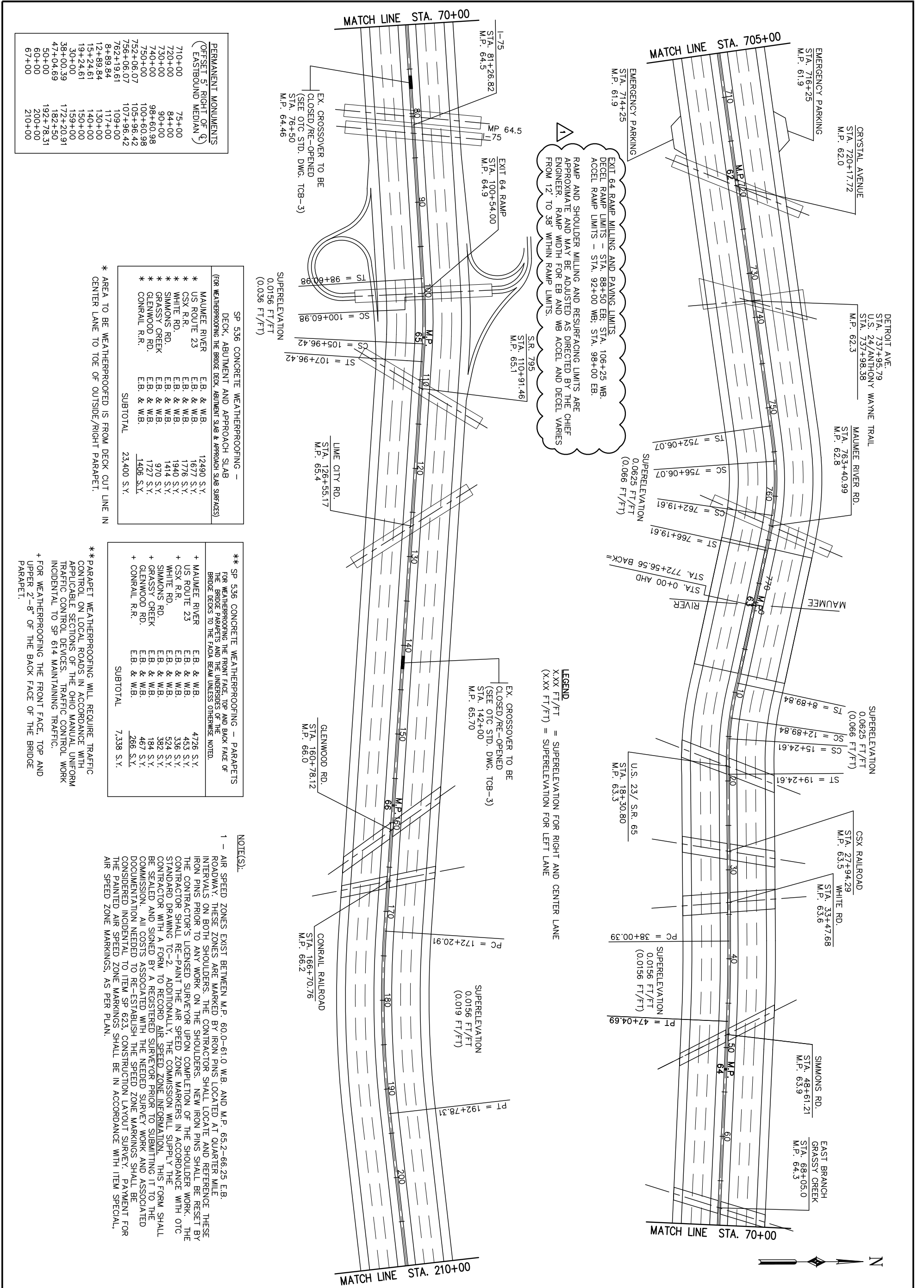

PERMANENT MONUMENTS
(OFFSET 5' RIGHT OF Q
EASTBOUND MEDIAN)

710+00	75+00
720+00	84+00
730+00	90+00
740+00	98+60.98
750+00	100+60.98
752+06.07	105+96.42
756+06.07	107+96.42
762+19.61	109+00
8+89.84	117+00
12+89.84	130+00
15+24.61	140+00
19+24.61	150+00
30+00	159+00
38+00.39	172+20.91
47+04.69	182+50
50+00	192+78.31
60+00	200+00
67+00	210+00

SP 536 CONCRETE WEATHERPROOFING -
DECK, ABUTMENT AND APPROACH SLAB
(FOR WEATHERPROOFING THE BRIDGE DECK, ABUTMENT SLAB & APPROACH SLAB SURFACES)

MAUMEE RIVER	EB. & WB.	12490 S.Y.
US ROUTE 23	EB. & WB.	1677 S.Y.
CSX R.R.	EB. & WB.	1776 S.Y.
WHITE RD.	EB. & WB.	1940 S.Y.
SIMMONS RD.	EB. & WB.	1414 S.Y.
GRASSY CREEK	EB. & WB.	970 S.Y.
GLENWOOD RD.	EB. & WB.	1727 S.Y.
CONRAIL R.R.	EB. & WB.	1406 S.Y.
SUBTOTAL		23,400 S.Y.

** SP 536 CONCRETE WEATHERPROOFING - PARAPETS
FOR WEATHERPROOFING THE FRONT FACE, TOP AND BACK FACE OF
THE BRIDGE TO THE FACIL BEAM UNLESS OTHERWISE NOTED.

MAUMEE RIVER	EB. & WB.	4726 S.Y.
US ROUTE 23	EB. & WB.	453 S.Y.
CSX R.R.	EB. & WB.	336 S.Y.
WHITE RD.	EB. & WB.	524 S.Y.
SIMMONS RD.	EB. & WB.	382 S.Y.
GRASSY CREEK	EB. & WB.	184 S.Y.
GLENWOOD RD.	EB. & WB.	467 S.Y.
CONRAIL R.R.	EB. & WB.	266 S.Y.
SUBTOTAL		7,338 S.Y.

NOTES:

1 - AIR SPEED ZONES EXIST BETWEEN M.P. 60.0-61.0 WB. AND M.P. 65.2-66.25 EB. ROADWAY. THESE ZONES ARE MARKED BY IRON PINS LOCATED AT QUARTER MILE INTERVALS ON BOTH SHOULDERS. THE CONTRACTOR SHALL LOCATE AND REFERENCE THESE IRON PINS PRIOR TO ANY WORK ON THE SHOULDERS. NEW IRON PINS SHALL BE RESET BY THE CONTRACTOR'S LICENSED SURVEYOR UPON COMPLETION OF THE SHOULDER WORK. THE CONTRACTOR SHALL RE-PAINT THE AIR SPEED ZONE MARKERS IN ACCORDANCE WITH OTC STANDARD DRAWING TC-2. ADDITIONALLY, THE COMMISSION WILL SUPPLY THE CONTRACTOR WITH A FORM TO RECORD AIR SPEED ZONE INFORMATION. THIS FORM SHALL BE SEALED AND SIGNED BY A REGISTERED SURVEYOR PRIOR TO SUBMITTING IT TO THE COMMISSION. ALL COSTS ASSOCIATED WITH THE NEEDED SURVEY WORK AND ASSOCIATED DOCUMENTATION NEEDED TO RE-ESTABLISH THE SPEED ZONE MARKINGS SHALL BE CONSIDERED INCIDENTAL TO ITEM SP 623. CONSTRUCTION LAYOUT SURVEY. PAYMENT FOR THE PAINTED AIR SPEED ZONE MARKINGS SHALL BE IN ACCORDANCE WITH ITEM SPECIAL, AIR SPEED ZONE MARKINGS, AS PER PLAN.

* AREA TO BE WEATHERPROOFED IS FROM DECK CUT LINE IN CENTER LANE TO TOE OF OUTSIDE/RIGHT PARAPET.
* PARAPET WEATHERPROOFING WILL REQUIRE TRAFFIC CONTROL ON LOCAL ROADS IN ACCORDANCE WITH APPLICABLE SECTIONS OF THE OHIO MANUAL UNIFORM TRAFFIC CONTROL DEVICES. TRAFFIC CONTROL WORK INCIDENTAL TO SP 614 MAINTAINING TRAFFIC.
+ FOR WEATHERPROOFING THE FRONT FACE, TOP AND UPPER 2'-8" OF THE BACK FACE OF THE BRIDGE PARAPET.

	PROJECT 59-16-02	RESURFACING PLAN STA. 705+00 TO STA. 210+00	DESIGNED JJS	CHECKED TWB	NO. 1	REVISIONS ADDENDUM NO. 1	BY JJS	DATE 2/10/16	DESIGN AGENCY
				DRAWN JJS	IN CHARGE DCA				

OHIO TURNPIKE AND INFRASTRUCTURE COMMISSION

1

ESTIMATED QUANTITY		ITEM DESCRIPTION	
ITEM	TOTAL	UNIT	
IB. ART.6	1	LUMP	PREMIUM FOR CONTRACT PERFORMANCE BOND AND PAYMENT BOND
202	1,000	FOOT	GUARDRAIL REMOVED FOR REUSE
202	3,000	FOOT	GUARDRAIL REMOVED
202	460	SQ.YD.	APPROACH SLAB REMOVED
SP 202B	2,000	CU.YD.	CRACK REPAIR, 1" OR LESS, USING SAND ASPHALT
SP 202B	20	CU.YD.	CRACK REPAIR, 1" OR LESS, USING HOT JOINT SEALER
SP 202B	20	CU.YD.	CRACK REPAIR, WIDER THAN 1" AND LESS THAN 1" IN DEPTH, USING ITEM SP 404 (PG 64-22)
SP 202B	20	CU.YD.	CRACK REPAIR, WIDER THAN 1" AND GREATER THAN 1" IN DEPTH, USING SP 402 (PG 64-22)
SP 202B	20	CU.YD.	REPAIR EXISTING EXPANSION JOINT, USING ITEM SP 402 (PG64-22)
SP 202B	20	CU.YD.	REPAIR EXISTING EXPANSION JOINT, USING ITEM SP 404 (PG64-22)
204	383	CU.YD.	EXCAVATION OF SUBGRADE
204	50	CU.YD.	EMBANKMENT
204	1,300	SQ.YD.	SUBGRADE COMPACTION
254	459,490	SQ.YD.	PAVEMENT PLANING, ASPHALT CONCRETE (T=2")
254	3,626	SQ.YD.	PAVEMENT PLANING, PORTLAND CEMENT CONCRETE, AS PER PLAN
SP 304	217	CU.YD.	AGGREGATE BASE
SP 403	5,392	CU.YD.	ASPHALT CONCRETE LEVELING COURSE, USING CRUSHED STONE, PG 70-22(FR)
SP 402	1,000	CU.YD.	ASPHALT CONCRETE INTERMEDIATE COURSE, USING CRUSHED STONE, PG 64-22
SP 404	3,713	CU.YD.	ASPHALT CONCRETE SURFACE COURSE, USING CRUSHED STONE, PG 64-22
SP 404	16,275	CU.YD.	ASPHALT CONCRETE SURFACE COURSE, USING CRUSHED SLAG, PG 70-22(FR)
SP 404A	157,817	FOOT	JOINT SEALER
SPECIAL	73,090	GALLON	TRACKLESS TACK
SP 451	526.67	SQ.YD.	FULL DEPTH PAVEMENT REPAIRS (ASPHALT)
SP 526	480	SQ.YD.	CLASS C CONCRETE, APPROACH SLAB, USING TYPE 1 CEMENT (T=12")
SP 536	38,990	SQ.YD.	CONCRETE WEATHERPROOFING, DECK, ABUTMENT SLABS AND APPROACH SLABS
SP 536	12,067	SQ.YD.	CONCRETE WEATHERPROOFING, PARAPETS
604	5	EACH	CATCH BASIN, ADJUSTED TO GRADE, LESS THAN 4", AS PER PLAN
604	5	EACH	CATCH BASIN, ADJUSTED TO GRADE, 4" - 12", AS PER PLAN
604	5	EACH	CATCH BASIN, ADJUSTED TO GRADE, GREATER THAN 12", AS PER PLAN
604	5	EACH	CATCH BASIN, GRATE AND CASTING, AS PER PLAN
SP 605	1,800	FOOT	AGGREGATE DRAINS, TYPE II
606	3,000	FOOT	GUARDRAIL, TYPE MGS, USING LONG STEEL POSTS
606	1,000	FOOT	GUARDRAIL REBUILT, TYPE 5, USING STEEL POSTS
609	500	FOOT	ASPHALT CONCRETE CURB, TYPE I, PG 64-22
SP 614	1	LUMP	MAINTAINING TRAFFIC, AS PER PLAN
SP 614	3,744	HOURS	ZONE PERSON
614	80	CU.YD.	ASPHALT CONCRETE FOR MAINTAINING TRAFFIC, AS PER PLAN
614	41,43	MI	WORK ZONE EDGE LINE, CLASS 1, 740.02 TYPE 1
614	16,50	MI	WORK ZONE LANE LINE, CLASS 1, 740.02 TYPE 1
614	14,362	FOOT	WORK ZONE CHANNELIZING LINE, CLASS 1, 740.02 TYPE 1
614	20,604	FOOT	WORK ZONE CHANNELIZING LINE, CLASS 1, 740.06 TYPE 1
617	36,000	SQ.YD.	SHOULDER PREPARATION
617	3,000	CU.YD.	COMPACTED AGGREGATE
617	50	M. GAL.	WATER
619	1	LUMP	FIELD OFFICE, AS PER PLAN
621	2,834	EACH	RAISED PAVEMENT MARKERS REMOVED
SP 621	2,834	EACH	RAISED PAVEMENT MARKERS
SP 623	1	LUMP	CONSTRUCTION LAYOUT SURVEY
624	1	LUMP	MOBILIZATION
SP 626	500	EACH	BARRIER REFLECTOR, TYPE A (WHITE)
SP 626	3,331	EACH	BARRIER REFLECTOR, TYPE B (YELLOW)
SP 626A	960	EACH	CONSTRUCTION ZONE MARKERS, ONE WAY MODEL, WHITE
SP 626A	480	EACH	CONSTRUCTION ZONE MARKERS, ONE WAY MODEL, YELLOW
SP 627	2,000	CU.YD.	STONE SHOULDER PROTECTION
SP 641A	0.65	MI	TEMPORARY REMOVAL OF EXISTING PAVEMENT MARKINGS
SP 641C	55.50	MI	REMOVAL OF PAVEMENT MARKING
642	50.60	MI	6" WHITE LANE LINE, TYPE 1
642	30.50	MI	6" WHITE EDGE LINE, TYPE 1
642	30.50	MI	6" YELLOW EDGE LINE, TYPE 1
642	6,000	FOOT	12" WHITE CHANNELIZING LINE, TYPE 1
642	4,000	FOOT	WHITE DOTTED LINE, 6" WHITE, TYPE 1
SPECIAL	25.65	MI	SNAP MILL AND FILL
SPECIAL	48.22	MI	SONIC NAP ALERT PATTERN (SNAP)
SPECIAL	8	EACH	SECURING MANHOLE LID
SPECIAL	20	EACH	AIR SPEED ZONE MARKINGS, AS PER PLAN
SPECIAL	4	EACH	EXISTING CROSSOVER TO BE CLOSED/RE OPENED, AS PER PLAN
SPECIAL	6,200	GALLON	LONGITUDINAL JOINT STABILIZER, POLYMER EMULSION

* CONTINGENCY QUANTITY TO BE USED AS DIRECTED BY CHIEF ENGINEER (SEE GENERAL NOTES),
 ** PORTION OF THIS ITEM IS CONTINGENCY QUANTITY (SEE PLANS AND GENERAL NOTES).

APPROX MILEPOST	LANE	SP 451
		FULL DEPTH PAVEMENT REPAIRS (ASPHALT)
EB	RIGHT	S.Y.
61.2	X	13.33
61.7	X	13.33
64.9		13.33
65.25		13.33
65.3	X	26.67
65.41	X	20.00
65.45	X	13.33
65.69	X	13.33
66.1	X	13.33
66.2	X	13.33
66.25	X	13.33
67.45	X	26.67
68	X	13.33
68.05	X	13.33
68.08	X	13.33
68.09	X	13.33
68.1	X	13.33
68.12	X	13.33
68.13	X	13.33
68.25	X	26.67
68.5	X	13.33
WB		
61.55	X	26.67
63.4	X	13.33
64.3	X	13.33
64.5	X	13.33
64.51	X	13.33
64.55	X	13.33
64.56	X	13.33
64.58	X	13.33
65.15	X	26.67
66.6	X	13.33
67.65	X	13.33
67.9	X	13.33
68.41	X	13.33
	TOTAL	526.67

FULL DEPTH REPAIR NOTE(S):

1--ALL FULL DEPTH REPAIRS EXCAVATED DURING A WORK SHIFT SHALL BE FILLED TO THE MILLED SURFACE DURING THAT SAME WORK SHIFT. NO REPAIR SHALL BE LEFT OPEN BEYOND THE END OF THE SHIFT. THE CONTRACTOR SHALL PLAN ITS OPERATIONS ACCORDINGLY.
 2--ALL FULL DEPTH REPAIRS ARE APPROXIMATE AND MAY BE ADJUSTED BY THE CHIEF ENGINEER.

APPROX MILEPOST OF BRIDGE	APPROACH SLAB LOCATION IN DIRECTION OF TRAVEL	SP 526	202
		CLASS C CONCRETE, APPROACH SLAB, USING TYPE 1 CEMENT (T=12")	APPROACH SLAB REMOVED
	LEAD	S.Y.	S.Y.
	TRAIL	S.Y.	S.Y.
56.08(EB)	X	63.33	63.33
59.8(EB)	X	56.67	56.67
61.1(EB)	X	56.67	56.67
63.37(EB)	X	56.67	56.67
63.5(EB)	X	56.67	56.67
63.65(EB)	X	56.67	56.67
63.35(WB)	X	56.67	56.67
63.4(WB)	X	56.67	56.67
	TOTAL	460.00	460.00

APPROACH SLAB REPAIR NOTE(S):

APPROACH SLAB REMOVAL AND REPLACEMENT PERFORMED DURING A WORK SHIFT SHALL BE COMPLETED DURING THAT SAME WORK SHIFT. NO REPAIR SHALL BE LEFT OPEN BEYOND END OF THE SHIFT. ALL PLANNING, LABOR, EQUIPMENT, MATERIALS AND INCIDENTALS NEEDED TO INSURE THE WORK IS COMPLETED DURING THE WORK SHIFT SHALL BE CONSIDERED INCIDENTAL TO THE ITEM.

LEFT LANE PAVEMENT REPAIRS
 THE FOLLOWING CONTINGENCY ITEM HAVE BEEN ADDED TO THE PROJECT FOR REPAIR OF 3RD LANE (LEFT LANE) PAVEMENT. REPAIR AREAS WILL BE LOCATED APPROXIMATELY BETWEEN MP 64.1 TO MP 69.3 EB AND WB. THE REPAIR AREAS WILL BE APPROXIMATELY 13' WIDE AND 100' IN LENGTH BUT MAY BE ADJUSTED AS DIRECTED BY THE CHIEF ENGINEER. LOCATIONS WILL BE PROVIDED PRIOR TO COMMENCING STAGE 1 PHASE 1 WORK SO THAT THE CONTRACTOR CAN INCORPORATE THE REPAIRS. PAYMENT FOR THE ABOVE MENTIONED WORK SHALL BE INCLUDED IN THE RESPECTIVE BID ITEMS AND SHALL INCLUDE ALL LABOR, EQUIPMENT, MATERIALS, INCIDENTALS, AND PLANNING NEEDED TO COMPLETE THE WORK.

ITEM 254 - PAVEMENT PLANING, ASPHALT CONCRETE (T=2") 1733 SQ.YD.
 ITEM SP 404 - ASPHALT CONCRETE SURFACE COURSE, USING CRUSHED 100 CU.YD.
 ITEM SPECIAL - TRACKLESS TACK 150 GALLON

ITEM SPECIAL - LONGITUDINAL JOINT STABILIZER, POLYMER EMULSION

THIS ITEM SHALL CONSIST OF SUPPLYING AND PLACING APPROXIMATELY 6,200 GALLON OF A POLYMERIZED EMULSION. THE POLYMERIZED EMULSION SHALL BE JOINTBOND AS MANUFACTURED BY D & D EMULSIONS OR APPROVED EQUAL BY THE CHIEF ENGINEER.



THE POLYMERIZED EMULSION SHALL BE APPLIED 36" WIDE AND CENTERED ON THE LONGITUDINAL JOINT BETWEEN THE RIGHT AND LEFT LANE (ORIGINAL CROWN LINE) AND ALSO ON THE LONGITUDINAL JOINT BETWEEN THE CENTER AND LEFT LANE IN THE 3 LANE AREA. THE POLYMERIZED EMULSION SHALL BE PLACED AFTER THE SP 404 SURFACE COURSE IS COMPLETE AND IN PLACE (BOTH LANES PAVED) AND SHALL BE APPLIED TO THE LONGITUDINAL JOINT IN ACCORDANCE WITH THE MANUFACTURERS RECOMMENDATIONS AND SPECIFICATIONS. CONTRACTOR SHALL ALSO PERFORM ANY MANUFACTURER RECOMMENDED TEST SECTIONS TO VERIFY APPLICATION RATE TO THE EXISTING PAVEMENT FOR THE 3 LANE SECTION. THE APPROXIMATE APPLICATION RATE OF 0.08 GALLON/SQ.YD. SHALL BE USED UNLESS MODIFIED BY THE MANUFACTURER AFTER FIELD TESTING. PAYMENT FOR THIS ITEM SHALL BE AT THE CONTRACT UNIT PRICE PER GALLON FURNISHED, INSTALLED AND ACCEPTED BY THE CHIEF ENGINEER, AND SHALL INCLUDE ALL LABOR, EQUIPMENT AND MATERIALS, TRAFFIC CONTROL, AND INCIDENTALS NECESSARY TO COMPLETE THIS ITEM.

SPECIAL - TRACKLESS TACK
 DESCRIPTION: THIS WORK CONSISTS OF PREPARING AND TREATING A PAVED SURFACE WITH NTSS-1HM TRACKLESS TACK PRODUCED BY BLACKLIDGE EMULSIONS, INC., AE-NIT NO TRACK TACK PRODUCED BY K-TECH SPECIALTY COATINGS, INC., OR APPROVED EQUAL BY THE CHIEF ENGINEER. THE PRODUCT SHALL MEET ALL REQUIREMENTS OF ITEM 407 TACK COAT EXCEPT AS NOTED BELOW;

MATERIAL: CONFORM TO THE FOLLOWING TYPICAL PHYSICAL PROPERTIES:

PARAMETER	TEST METHOD	MIN.	MAX.
SAYBOLT FUROL VISCOSITY, SFS @ 25C	AASHTO T59	15	100
STORAGE STABILITY, 5 DAYS, %	AASHTO T59	--	5
RESIDUE BY DISTILLATION, %	AASHTO T59	50	--
OIL DISTILLATE, %	AASHTO T59	--	1
SIEVE TEST, %	AASHTO T59	--	0.30
TEST ON RESIDUE:			
PENETRATION, @ 25C	AASHTO T19	--	25
SOFTENING POINT RANGE DEG C	AASHTO T53	65	--
SOLUBILITY, %	AASHTO T14	97.5	--

NOTE: PRODUCT SHOULD NOT CONTAIN FILLER SUCH AS CLAY, ETC. KEEP FROM FREEZING. SUPPLY CERTIFIED TEST DATA FROM AN INDEPENDENT LAB TO THE ENGINEER SHOWING THE MATERIAL SUPPLIED WAS TESTED FOR AND MEETS THE ABOVE PROPERTIES.

EQUIPMENT: ALL REQUIREMENTS OF 407.03 APPLY. SEE MANUFACTURER'S REPRESENTATIVE FOR CORRECT DISTRIBUTOR SETTINGS. THOROUGHLY CLEAN ALL EQUIPMENT IF CATIONIC EMULSION WAS PREVIOUSLY USED.

WEATHER LIMITATIONS: ALL REQUIREMENTS OF 407.04 APPLY.

PREPARATION OF SURFACE: ALL REQUIREMENTS OF 407.05 APPLY.

APPLICATION OF ASPHALT MATERIAL: UNIFORMLY APPLY THE ASPHALT MATERIAL WITH A DISTRIBUTOR PER THE REQUIREMENTS OF 407.06 EXCEPT AS NOTED. IF PRODUCT IS STORED FOR AN EXTENDED PERIOD OF TIME, PRIOR TO APPLICATION, AGITATE OR GENTLY CIRCULATE THE MATERIAL. ALL NOZZLES AND SPRAY PATTERNS SHALL BE IDENTICAL TO ONE ANOTHER ALONG THE DISTRIBUTOR SPRAY BAR. THE ANGLE OF THE NOZZLE SHOULD BE A 15 TO 30 DEGREE ANGLE TO THE SPRAY BAR AXIS TO MAXIMIZE OVERLAP OR AS RECOMMENDED BY THE NOZZLE MANUFACTURER. CONTACT THE MANUFACTURER'S REPRESENTATIVE FOR REQUIRED SPRAY NOZZLE SIZE, AND DISTRIBUTOR AND NOZZLE SETTINGS. APPLY AT A RATE OF 0.075 GALLONS PER SQUARE YARD TO ALL MILLED SURFACES AND AT A RATE OF 0.06 GALLONS PER SQUARE YARD TO ALL SMOOTH PAVED SURFACES AND BETWEEN COURSES OF ASPHALT. RECOMMENDED APPLICATION TEMPERATURE IS 160 F TO 180 F. DO NOT EXCEED 180 F. DILUTION IS NOT ALLOWED.

THE ENGINEER AND MANUFACTURER'S REPRESENTATIVE WILL APPROVE RATE OF APPLICATION, TEMPERATURE, DISTRIBUTOR SETTINGS, AND AREAS TO BE TREATED BEFORE APPLICATION OF THE TACK COAT. THE ENGINEER WILL DETERMINE THE ACTUAL APPLICATION IN GALLONS PER SQUARE YARD BY A CHECK ON THE PROJECT. THE APPLICATION IS CONSIDERED SATISFACTORY WHEN THE MATERIAL IS APPLIED UNIFORMLY WITH NO VISIBLE EVIDENCE OF STREAKING OR RIDGING AND THE APPLICATION RATE IS ±10% OF THE SPECIFIED RATE.

METHOD OF MEASUREMENT: ALL REQUIREMENTS OF 407.07 APPLY.

BASIS OF PAYMENT: ALL REQUIREMENTS OF 407.08 APPLY.

ITEM 254 - PAVEMENT PLANING, PORTLAND CEMENT CONCRETE, AS PER PLAN

THIS CONTINGENCY ITEM CONSISTS OF PAVEMENT PLANING OF CONCRETE APPROACH AND/OR ABUTMENT SLABS WITH DIAMOND BLADES ONLY. THIS QUANTITY IS INTENDED TO BE UTILIZED TO MEET PAVEMENT SMOOTHNESS. A QUANTITY OF 3626 SQ.YD. IS INCLUDED IN THE ESTIMATED QUANTITIES TO BE USED AS DIRECTED BY THE CHIEF ENGINEER OR AS INDICATED IN THE PLANS.

PAYMENT FOR ALL LABOR, EQUIPMENT AND MATERIALS NECESSARY FOR THE ABOVE MENTIONED WORK SHALL BE DEPENDANT ON AND IN ACCORDANCE WITH EITHER ITEM 254--PAVEMENT PLANING, PORTLAND CEMENT CONCRETE, AS PER PLAN.

ITEM SP 626 - BARRIER REFLECTOR

ITEM SP 626--BARRIER REFLECTOR, TYPE B(YELLOW) SHALL CONSIST OF INSTALLING REFLECTORS ON THE MEDIAN CONCRETE BARRIER WALL AS SPECIFIED IN SP 626 EXCEPT THAT THE REFLECTORS SHALL BE INSTALLED AT A 25' NORMAL SPACING AND AT 10' SPACING IN ALL LOCATIONS WHERE THE MEDIAN SHOULDER NARROWS (MEDIAN BRIDGE PIERS AND SIGN FOUNDATIONS). UPON COMPLETION OF THE PROJECT, THE CONTRACTOR SHALL CAREFULLY REMOVE, SO AS NOT TO OVERLY DAMAGE THE BARRIER FACE, THE APPROPRIATE NUMBER OF INSTALLED BARRIER REFLECTORS SO THAT THE NUMBER AND SPACING COMPLY WITH THE REQUIREMENTS OF SP 626. THIS WORK SHALL BE INCIDENTAL TO THE COST OF THE BARRIER REFLECTORS.

THIS ITEM SHALL ALSO CONSIST OF REMOVING EXISTING BARRIER REFLECTORS THAT ARE NOT PLACED AT THE APPROPRIATE LOCATION ON THE MEDIAN WALL AS SPECIFIED IN SP 626. THE COST OF REMOVAL SHALL BE CONSIDERED INCIDENTAL TO ITEM SP 626--BARRIER REFLECTOR, TYPE B.

ITEM SP 626--BARRIER REFLECTOR, TYPE A (WHITE) SHALL CONSIST OF INSTALLING REFLECTORS AT GUARDRAIL LOCATIONS IDENTIFIED BY THE CHIEF ENGINEER, WITHIN PROJECT LIMITS, THAT REQUIRE INSTALLATION, REPAIR, OR REPLACEMENT OF BARRIER REFLECTORS. FOR THIS PURPOSE, A CONTINGENCY QUANTITY IS INCLUDED IN THE ESTIMATED QUANTITIES FOR USE AS DIRECTED BY THE CHIEF ENGINEER.

DESIGNED JJS	CHECKED TWB	NO. 1	REVISIONS ADDENDUM NO. 1	BY JJS	DATE 2/10/16	DESIGN AGENCY
DRAWN JJS	IN CHARGE DCA	

PROJECT 59-16-02

SUB-SUMMARIES AND MISCELLANEOUS NOTES

19