

OHIO TURNPIKE AND  
INFRASTRUCTURE COMMISSION

ADDENDUM NO. 1

PROJECT NO. 43-16-05  
SCOPE OF WORK – PART A  
BRIDGE REHABILITATION

SLAGLE ROAD (T.R. 231) OVER OHIO TURNPIKE, M.P. 200.2,  
STATE ROUTE 303 OVER OHIO TURNPIKE, M.P. 207.3,  
STATE ROUTE 534 OVER OHIO TURNPIKE, M.P. 207.6,  
OHIO TURNPIKE RAMP OVER OHIO TURNPIKE (EXIT 209), M.P. 209.2,  
OHIO TURNPIKE RAMP OVER STATE ROUTE 5 (EXIT 209), M.P. 209.6,  
LYNTZ-TOWNLINE ROAD (C.R. 89) OVER OHIO TURNPIKE, M.P. 214.3,  
OHIO TURNPIKE RAMP OVER OHIO TURNPIKE (EXIT 215), M.P. 215.0,  
HERBERT ROAD (C.R. 110) OVER OHIO TURNPIKE, M.P. 225.0,  
STATE ROUTE 46 (U.S. ROUTE 62) OVER OHIO TURNPIKE, M.P. 225.2,  
RACCOON ROAD (C.R. 109) OVER OHIO TURNPIKE, M.P. 226.7,  
U.S. RT. 224 (BOARDMAN-CANFIELD RD) OVER OHIO TURNPIKE, M.P. 227.6,  
BEARD ROAD (C.R. 167) OVER OHIO TURNPIKE, M.P. 236.7,  
PORTAGE, TRUMBULL & MAHONING COUNTIES, OHIO

SCOPE OF WORK – PART B  
BRIDGE DECK REPLACEMENT AND REHABILITATION  
ASBURY ROAD (C.R. 223) OVER OHIO TURNPIKE M.P. 197.8,  
STATE ROUTE 700 (FREEDOM ROAD) OVER OHIO TURNPIKE M.P. 198.5,  
PORTAGE COUNTY, OHIO

OPENING DATE: 2:00 P.M. (EASTERN TIME), JANUARY 6, 2016

ALL BIDS MUST BE ELECTRONICALLY SUBMITTED

ATTENTION OF BIDDERS IS DIRECTED TO:

ANSWERS TO QUESTIONS RECEIVED THROUGH 12:00 PM ON DECEMBER 29, 2015

REVISIONS TO THE CONTRACT DOCUMENTS

Cover Page  
Plan Sheet Nos. 22, 44 and 57  
Bid Schedule of Items at Ref. No. 16

Issued by the Ohio Turnpike and Infrastructure Commission on December 29, 2015. Issuance authorized by Anthony Yacobucci, Chief Engineer, and Mark R. Musson, Director, Contracts Administration and Compliance.

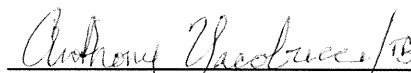
  
Anthony Yacobucci Date 12/29/15

  
Mark R. Musson Date 12/29/15

**OHIO TURNPIKE AND INFRASTRUCTURE COMMISSION  
ADDENDUM NO. 1  
PROJECT NO. 43-16-05**

**ANSWERS TO QUESTIONS RECEIVED THROUGH 12:00 PM ON DECEMBER 29, 2015**

**Q#1 Can Asbury Road (MP 197.8) & State Route 700 (MP 198.5) be closed concurrently and use the same closure detour as State Route 700 depicted on sheet 8/32?**

*A#1 Asbury Road (MP 197.8) and State Route 700 (MP 198.5) may be closed concurrently, but if they are, the signed closure for Asbury Road cannot use the same detour as the State Route 700 shown on Sheet 8 of 32. Portage County requires the signed detour route to utilize Streeter Road and Limeridge Road if the two bridges are closed concurrently.*

**Q#2 For MP 227.6, Plan Sheet 57/77, note 4. states "Replace existing Rear abutment, Pier 1, Pier 4 and Forward abutment bearings with new elastomeric bearings in accordance with SP 516G and SP 516J". However, Plan sheet 71/77, bearing details-2, does not include bearing data for Pier bearings.**

*A#2 For MP 227.6, replace the existing Rear and Forward Abutment bearings with elastomeric bearings and no replacement of bearings is required at Pier 1 and Pier 4. This Addendum modifies the quantities and notes appearing on Sheet 22 of 77 and Sheet 57 of 77, and the bid schedule of items is modified to reflect the resulting approximate quantity of elastomeric bearings in the project being reduced by 40. Further, Plan Sheet 44 of 77 is revised to correct a plan error.*

**Q#3 I am working on putting a quote together on the SP533 items and I cannot locate a couple of Standard Drawings. Part A says we need DJ-1, DJ-2, DJ-3, and DJ-5 and Part B says we need DJ-1 and DJ-2. The BX has provided me with DJ-1, DJ-2,DJ-3, DJ-5, DJ-7 and DJ-8, however, I still believe I am in need of DJ-9 and DJ-10. Can you please make these accessible via the BX and/or Bid Express?**

*A#3 Yes, the Commission is providing access to the Standard Drawings DJ-9 and DJ-10 through BidExpress.*

**Q#4 I have a concern about the structure 227.6 on project 43-16-05 Part A, Per drawing No. 22 and 57, there are 40 ea. expansion bearings need to be replaced, But there is no detail about these bearings on drawing No. 71. I was wondering if you have chance to look at it and forward the detail?**

*A#4 See the response to Q#2.*

**Q#5 I am unable to identify the full complement of expansion bearings required on Structure No. M.P. 227.6. The "Estimated Quantities" on sheet 22/77, indicate a total of 40 expansion bearings required for replacement. Note 4 of the "Proposed Rehabilitation Scope of Work" on Sheet 57/77 indicates that the bearings at the Rear and Forward Abutments, and Piers 1 and 4 are to be replaced, per sheet 71/77 (Bearing Details). However, sheet 71/77 indicates**

**only the bearing data for the fixed bearings (Rear and Forward Abutments). Nothing is indicated regarding the bearing date for Piers 1 and 4. I am also unable to locate any other information that would indicate how those bearings are replaced. Can you please clarify the correct number of bearings to be replaced on this structure, and if the numbers as presented are accurate, how the 40 expansion bearings are to be replaced?**

A#5 See the response to Q#2

**MODIFICATIONS TO THE CONTRACT DOCUMENTS**

Changes to the Plan Drawing Sheet Nos. 22, 44 and 57 are called out with a cloud and deletions are marked with a revision triangle as thus:



Changes to the Bid Schedule of Items at Ref. No. 16 are highlighted in yellow and contained in **bold italicized text** in the excel worksheet provided with this Addendum No. 1 in accordance with IB 2.6.2.3.

Cover Sheet is modified to correctly state the advertised Bid Opening at 2:00 P.M. (Eastern Time) on January 6, 2016.

Addendum No. 1 to Contract 43-16-05:

\_\_\_\_\_  
(Firm Name)

\_\_\_\_\_  
(Signature)

\_\_\_\_\_  
(Printed Name)

Date: \_\_\_\_\_

**ESTIMATED QUANTITIES**

ITEM NO.	QUANTITY.	UNIT	ITEM DESCRIPTION	M.P. 200.2	M.P. 207.3	M.P. 207.6	M.P. 209.2	M.P. 209.6	M.P. 214.3	M.P. 215.0	M.P. 225.0	M.P. 225.2	M.P. 226.7	M.P. 227.6	M.P. 236.7
<b>GENERAL</b>															
IB.ART.6	LUMP	LUMP	PREMIUM FOR CONTRACT PERFORMANCE BOND AND PAYMENT BOND												
SP 614	LUMP	LUMP	MAINTAINING TRAFFIC												
SP 619	LUMP	LUMP	FIELD OFFICE												
SP 623	LUMP	LUMP	CONSTRUCTION LAYOUT SURVEY												
624	LUMP	LUMP	MOBILIZATION												
<b>STRUCTURES</b>															
SP 202	LUMP	LUMP	PORTIONS OF STRUCTURE REMOVED												
203	19	CU. YD.	EMBANKMENT, USING NATURAL SOILS, 703.16.A					10					9		
SP 509	681	POUND	EPOXY COATED REINFORCING STEEL, GRADE 60				320			320		28			13
510	40	EACH	DOWEL HOLES WITH NONSHRINK, NONMETALLIC GROUT				40								
SP 511B	5	CU. YD.	CLASS S CONCRETE, BARRIERS AND PARAPETS, USING TYPE 1 CEMENT							5					
SP 511B	4	CU. YD.	CLASS HP4 CONCRETE, SUPERSTRUCTURE DECK SLAB				1						1	1	1
513	1	EACH	STRUCTURAL STEEL, MISC.: BEARING STIFFENER RETROFIT					1							
513	1	EACH	STRUCTURAL STEEL, MISC.: STRUCTURAL STEEL REPAIR												1
SP 516A	93	FOOT	CRACK REPAIR USING EPOXY INJECTION				34	8						35	16
SP 516B	8243	FOOT	SEALING OF CONSTRUCTION JOINTS	507	561	543	720	481	591	766	746	782	645	1332	569
SP 516G	114	EACH	REPLACE EXPANSION BEARING DEVICE	8	10	10		10	20	10	10		20	16	
SP 516J	58	EACH	REPLACE FIXED BEARING DEVICE						10		10		10	20	8
518	2	EACH	DOWNSPOUT MODIFICATION										2		
SP 519	2422	SQ. FT.	PATCHING CONCRETE STRUCTURES		76		752	138	128		114	348	126	276	464
SP 527	LUMP	LUMP	FALSEWORK, TEMPORARY BRACING AND PROTECTIVE STRUCTURES												
SP 533D	34	FOOT	CONTINUOUS ELASTOMER SEAL IN A PORTLAND CEMENT CONCRETE JOINT				34								
SP 533E	422	FOOT	CONTINUOUS ELASTOMER SEAL IN ELASTOMERIC CONCRETE JOINT				102							320	
SP 533F	189	FOOT	REPLACEMENT OF COMPRESSION SEAL WITH CONTINUOUS ELASTOMER SEAL		70						88				31
SP 533G	638	FOOT	REPLACEMENT OF STRIP SEAL WITH CONTINUOUS ELASTOMER SEAL	58							44	164		372	
SP 536	6,227	SQ. YD.	CONCRETE WEATHERPROOFING, SUBSTRUCTURE	328	424	424	409	427	341	380	550	912	484	1,200	348
SP 536	11,801	SQ. YD.	CONCRETE WEATHERPROOFING, DECK, ABUTMENT SLABS, AND APPROACH SLABS	618	765	784	679	686	628	1,064	965	2,134	776	2,086	616
SP 536	6,790	SQ. YD.	CONCRETE WEATHERPROOFING, BARRIERS AND PARAPETS	562	477	520	541	455	545	766	479	702	534	731	478
SP 607	33	FOOT	TYPE 1 FENCE, ALL ALUMINUM (9'-0" CHAIN LINK WITH SPECIALS)								33				
849	LUMP	LUMP	HEAT STRAIGHTENING MEMBER			LUMP									
SPECIAL	34	SQ. YD.	PATCHING CONCRETE BRIDGE DECKS, TYPE B		2		7					2	18	5	
<b>ROADWAY</b>															
202	540	FOOT	CONCRETE MEDIAN REMOVED				300	240							
452	120	SQ. YD.	11" NON-REINFORCED CONCRETE PAVEMENT				67	53							
614	1.20	MILE	WORK ZONE CENTER LINE, CLASS 1							0.30				0.90	
614	1.40	MILE	WORK ZONE EDGE LINE, CLASS 1				0.10	0.10		0.30				0.90	
614	60	FOOT	WORK ZONE STOP LINE, CLASS 1				30	30							
642	0.70	MILE	EDGE LINE, 4", TYPE 1				0.10	0.10		0.20				0.30	
642	0.50	MILE	LANE LINE, 4", TYPE 1											0.50	
642	0.70	MILE	CENTER LINE, TYPE 1				0.10	0.10		0.20				0.30	
642	2	EACH	LANE ARROW, TYPE 1											2	

Bridge\_COMMON\_EQ001.dwg: 12/28/15 - 7:17am

PROJECT 43-16-05A  
 DATE: 10/09/15

ESTIMATED QUANTITIES  
 M.P. 200.2 TP M.P. 236.7

DESIGN AGENCY  
**TranSystems**

OHIO TURNPIKE

REVISIONS  
 ADDENDUM 1

NO. 1

CHECKED  
 NRF  
 IN CHARGE

BY DATE  
 ZTW 12/23/15

22  
77

OHIO TURNPIKE

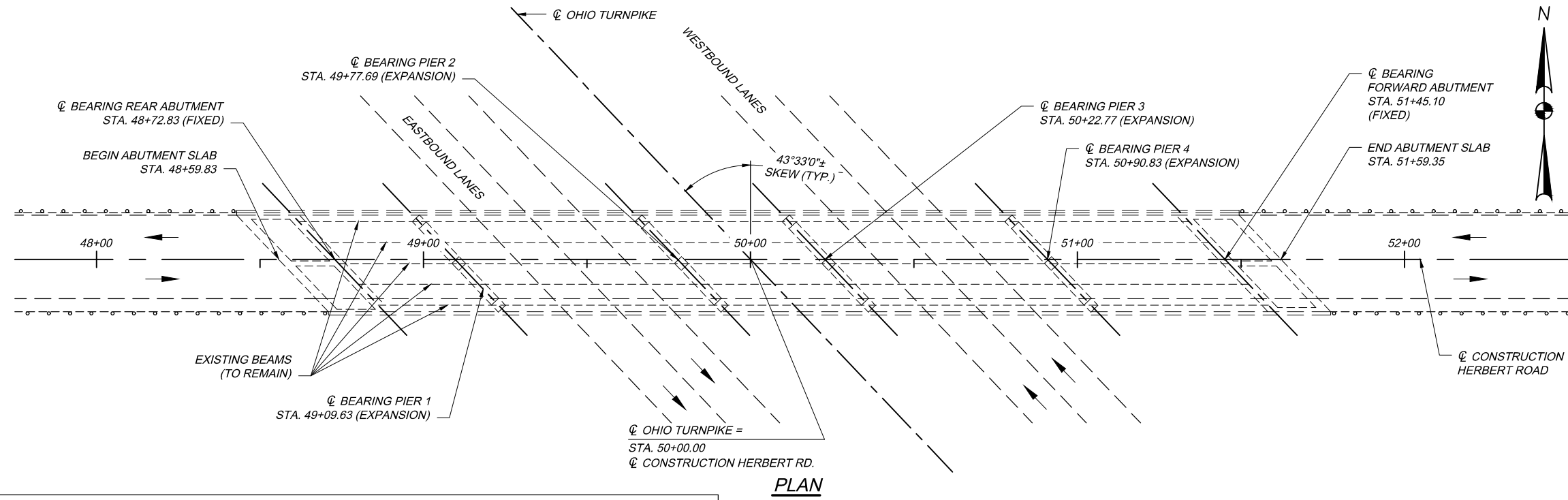

**EXISTING/PROPOSED STRUCTURE**

TYPE: CONTINUOUS STEEL BEAM WITH COMPOSITE CONCRETE DECK ON REINFORCED CONCRETE PIERS WITH CELLULAR ABUTMENTS

SPANS: 36'-9 1/2"±, 68'-0 13/16"±, 45'-0 13/16"±, 68'-0 13/16"±, 54'-3 1/4"± C/C BEARING

ROADWAY: 25'-6" TOE OF PARAPET TO TOE OF SIDEWALK

SKEW: 43°33'00"± RIGHT FORWARD

WEARING SURFACE: 1" LATEX MODIFIED CONCRETE

APPROACH SLABS: NONE

ALIGNMENT: TANGENT

BUILT: 1954

STRUCTURE FILE NUMBER: 5029422

OTIC MILEPOST: 225.0

BRIDGE COORDINATES:

LATITUDE 41°02'39" N

LONGITUDE 80°45'48" W

MP 225.0 - HERBERT ROAD (C.R. 110) OVER OHIO TURNPIKE ESTIMATED QUANTITIES

ITEM	TOTAL	UNIT	DESCRIPTION
SP 202	LUMP	LUMP	PORTIONS OF STRUCTURE REMOVED
SP 516B	746	LIN. FT.	SEALING OF CONSTRUCTION JOINTS
SP 516G	10	EACH	REPLACE EXPANSION BEARING DEVICE
SP 516J	10	EACH	REPLACE FIXED BEARING DEVICE
SP 519	114	SQ. FT.	PATCHING CONCRETE STRUCTURES
SP 527	LUMP	LUMP	FALSEWORK, TEMPORARY BRACING, AND PROTECTIVE STRUCTURES
SP 533F	88	LIN. FT.	REPLACEMENT OF COMPRESSION SEAL WITH CONTINUOUS ELASTOMER SEAL
SP 533G	44	LIN. FT.	REPLACEMENT OF STRIP SEAL WITH CONTINUOUS ELASTOMER SEAL
SP 536	550	SQ. YD.	CONCRETE WEATHERPROOFING, SUBSTRUCTURE
SP 536	965	SQ. YD.	CONCRETE WEATHERPROOFING, DECK, ABUTMENT SLABS, AND APPROACH SLABS
SP 536	479	SQ. YD.	CONCRETE WEATHERPROOFING, BARRIERS AND PARAPETS
SP 607	33	LIN. FT.	TYPE 1 FENCE, ALL ALUMINUM (9'-0" CHAIN LINK WITH SPECIALS)

**TRAFFIC DATA**

ADT = 17,000

ADTT = 3,700

- PROPOSED REHABILITATION SCOPE OF WORK:
- HERBERT ROAD OVER OHIO TURNPIKE**
- PATCH ALL AREAS OF UNSOUND CONCRETE ON ABUTMENTS, PARAPETS, AND PIERS IN ACCORDANCE WITH SP 519.
  - REPLACE THE EXISTING FIXED BEARINGS AT THE FORWARD AND REAR ABUTMENTS AND THE EXPANSION BEARINGS AT PIER 1 WITH NEW ELASTOMERIC BEARINGS IN ACCORDANCE WITH SP 516G AND SP 516J (SEE NOTE 2).
  - WEATHERPROOF THE SUBSTRUCTURE, PARAPETS, DECK, AND ABUTMENT SLABS WITH NON-EPOXY WEATHERPROOFING SEALER IN ACCORDANCE WITH SP 536 (SEE NOTE 3).
  - REMOVE ALL AREAS OF UNSOUND CONCRETE ON THE UNDERSIDE OF THE DECK IN ACCORDANCE WITH SP 202.
  - SEAL ALL CONSTRUCTION JOINTS IN ACCORDANCE WITH SP 516B (SEE NOTE 3).
  - REPLACE EXISTING COMPRESSION SEAL JOINTS AT BOTH ABUTMENTS IN ACCORDANCE WITH SP 533F PER OTIC STANDARD DRAWING DJ-9.
  - REPLACE EXISTING STRIP SEAL JOINT AT PIER 1 IN ACCORDANCE WITH SP 533G PER OTIC STANDARD DRAWING DJ-10.
  - REPLACE MISSING PORTION OF TYPE I FENCING ON THE SOUTH PARAPET AT THE FORWARD ABUTMENT. REPLACE AND REPAIR THE SHEARED FENCE POST AND FENCING ON THE RIGHT PARAPET OF SPAN 4 IN ACCORDANCE WITH SP 607.

- NOTES:
- THE PLAN AND PROFILE WERE DRAWN BASED ON THE EXISTING PLANS AND THE REHABILITATION PLANS. SEE THE GENERAL NOTES, FOR THE EXISTING STRUCTURE VERIFICATION NOTE.
  - FOR BEARING REPLACEMENT DETAILS, SEE SHEET 71.
  - FOR CONCRETE SEALING DETAILS, SEE SHEET 69.

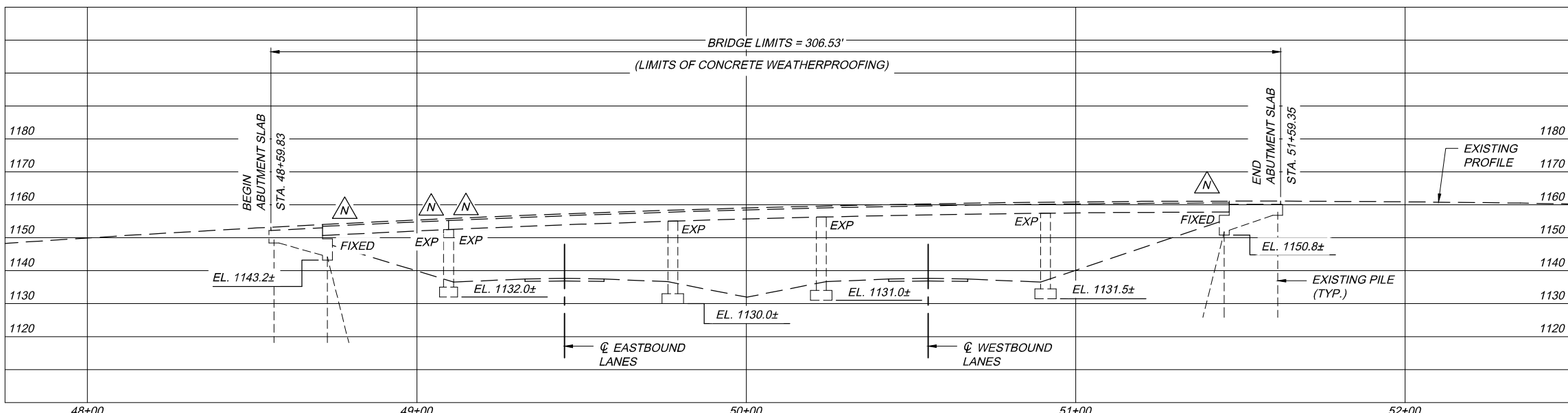

PROFILE ALONG  $\phi$  CONSTRUCTION HERBERT ROAD

$\triangle$  - NEW ELASTOMERIC BEARINGS (REMOVE EXISTING) (SEE NOTE 2)

OHIO TURNPIKE

DESIGN AGENCY: **TranSystems**

BY DATE: ZTW 12/23/15

REVISIONS: ADDENDUM 1

CHECKED: NRF IN CHARGE: NFF

DESIGNED: ZTW DRAWN: GJZ

SITE PLAN: HERBERT ROAD (C.R. 110) OVER OHIO TURNPIKE, MAHONING COUNTY, M.P. 225.0

PROJECT 43-16-05A DATE: 10/09/15

44  
77

OHIO TURNPIKE

Bridge\_225.0\_SFP001.dwg: 12/28/15 - 7:19am

**EXISTING/PROPOSED STRUCTURE**

TYPE: THREE SPAN CONTINUOUS CENTER SPAN WITH A SIMPLY SUPPORTED SPAN ON EACH END WITH STEEL BEAM SUPERSTRUCTURE AND A COMPOSITE REINFORCED CONCRETE DECK AT SPANS 1 AND 5 AND A REINFORCED CONCRETE DECK AT SPANS 2-4 SUPPORTED BY CELLULAR REINFORCED CONCRETE ABUTMENTS AND REINFORCED CONCRETE CAP AND COLUMN PIERS

SPANS: 49'-6<sup>13</sup>/<sub>16</sub>" ±, 73'-9<sup>1</sup>/<sub>2</sub>" ±, 48'-5<sup>7</sup>/<sub>16</sub>" ±, 73'-9<sup>1</sup>/<sub>2</sub>" ±, 40'-11<sup>15</sup>/<sub>16</sub>" ± C/C BEARING

ROADWAY: 59'-4" TOE TO TOE OF PARAPETS

SKEW: 47°52'20" ± RIGHT FORWARD

WEARING SURFACE: 1" MONOLITHIC CONCRETE

APPROACH SLABS: 15'-0" LONG

ALIGNMENT: TANGENT

BUILT: 1954

STRUCTURE FILE NUMBER: 5029481

OTIC MILEPOST: 227.6

BRIDGE COORDINATES:

LATITUDE 41°01'29" N

LONGITUDE 80°43'23" W

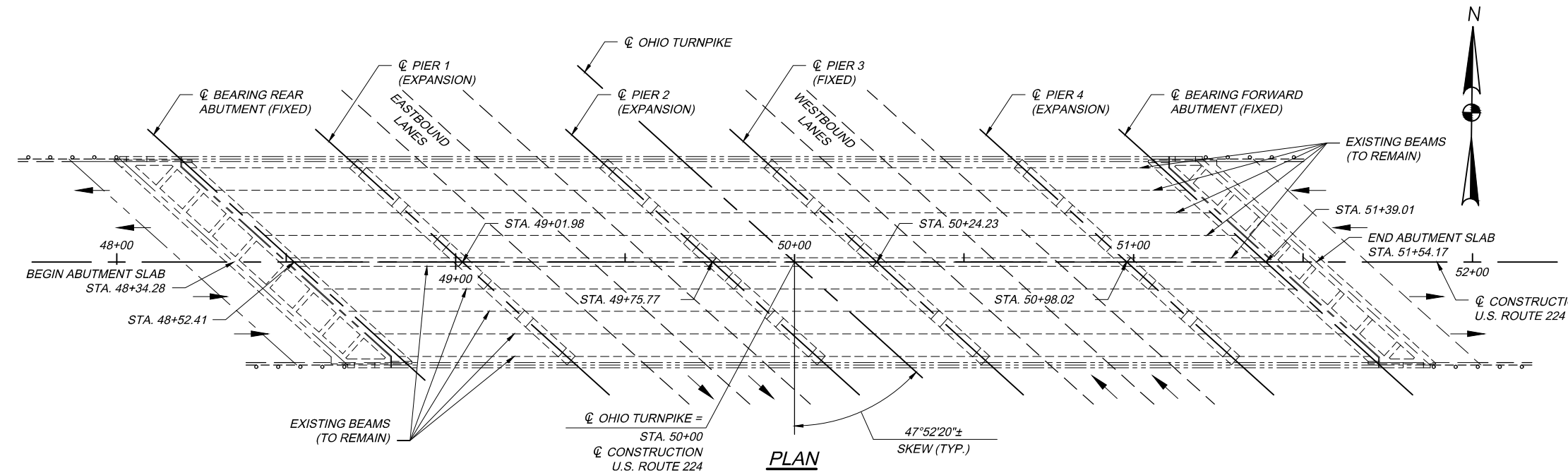

MP 227.6 - U.S. RT. 224 (BOARDMAN-CANFIELD RD.) OVER OHIO TURNPIKE ESTIMATED QUANTITIES			
ITEM	TOTAL	UNIT	DESCRIPTION
SP 202	LUMP	LUMP	PORTIONS OF STRUCTURE REMOVED
SP 511B	1	CU. YD.	CLASS HP4 CONCRETE, SUPERSTRUCTURE DECK SLAB
SP 516A	35	LIN. FT.	CRACK REPAIR USING EPOXY INJECTION
SP 516B	1332	LIN. FT.	SEALING OF CONSTRUCTION JOINTS
SP 516J	20	EACH	REPLACE FIXED BEARING DEVICE
SP 519	276	SQ. FT.	PATCHING CONCRETE STRUCTURES
SP 527	LUMP	LUMP	FALSEWORK, TEMPORARY BRACING AND PROTECTIVE STRUCTURES
SP 533E	320	LIN. FT.	CONTINUOUS ELASTOMER SEAL IN ELASTOMERIC CONCRETE JOINT
SP 533G	372	LIN. FT.	REPLACEMENT OF STRIP SEAL WITH CONTINUOUS ELASTOMER SEAL
SP 536	1200	SQ. YD.	CONCRETE WEATHERPROOFING, SUBSTRUCTURE
SP 536	2086	SQ. YD.	CONCRETE WEATHERPROOFING, DECK, ABUTMENT SLABS, AND APPROACH SLABS
SP 536	731	SQ. YD.	CONCRETE WEATHERPROOFING, BARRIERS AND PARAPETS
SPECIAL	5	SQ. YD.	PATCHING CONCRETE BRIDGE DECKS, TYPE B

**TRAFFIC DATA**

ADT = 26,650  
ADTT = 1,500

**PROPOSED REHABILITATION SCOPE OF WORK:**

**U.S. ROUTE 224 OVER OHIO TURNPIKE**

- REPLACE EXISTING STRIP SEAL JOINTS AT BOTH ABUTMENTS AND PIERS 1 AND 4 IN ACCORDANCE WITH SP 533G PER OTIC STANDARD DRAWING DJ-10.
- REMOVE EXISTING LONGITUDINAL JOINT SEAL AND NOSING AND REPLACE IN ACCORDANCE WITH SP 533E. LONGITUDINAL JOINT REPLACEMENT SHALL FOLLOW THE REQUIREMENTS PRESENTED BY OTIC STANDARD DRAWING DJ-8.
- PATCH ALL AREAS OF UNSOUND CONCRETE ON PARAPETS, ABUTMENTS, AND PIERS IN ACCORDANCE WITH SP 519.
- REPLACE EXISTING REAR ABUTMENT AND FORWARD ABUTMENT BEARINGS WITH NEW ELASTOMERIC BEARINGS IN ACCORDANCE WITH SP 516J (SEE NOTE 2).
- WEATHERPROOF THE SUBSTRUCTURE, PARAPETS, DECK, AND ABUTMENT SLABS WITH A NON-EPOXY WEATHERPROOFING SEALER IN ACCORDANCE WITH SP 536 (SEE NOTE 3).
- SEAL ALL CONSTRUCTION JOINTS IN ACCORDANCE WITH SP 516B (SEE NOTE 3).
- REPAIR CRACKS IN THE ABUTMENTS THAT ARE GREATER THAN 1/16" WIDE USING EPOXY INJECTION IN ACCORDANCE WITH SP 516A.
- REPLACE DETERIORATED PEDESTALS AT REAR AND FORWARD ABUTMENTS (3 TOTAL).
- REMOVE ALL AREAS OF UNSOUND CONCRETE ON THE UNDERSIDE OF THE DECK IN ACCORDANCE WITH SP 202.

**NOTES:**

- THE PLAN AND PROFILE WERE DRAWN BASED ON THE EXISTING PLANS AND THE REHABILITATION PLANS. SEE THE GENERAL NOTES, FOR THE EXISTING STRUCTURE VERIFICATION NOTE.
- FOR BEARING REPLACEMENT DETAILS, SEE SHEET 71.
- FOR CONCRETE WEATHERPROOFING DETAILS, SEE SHEET 69.

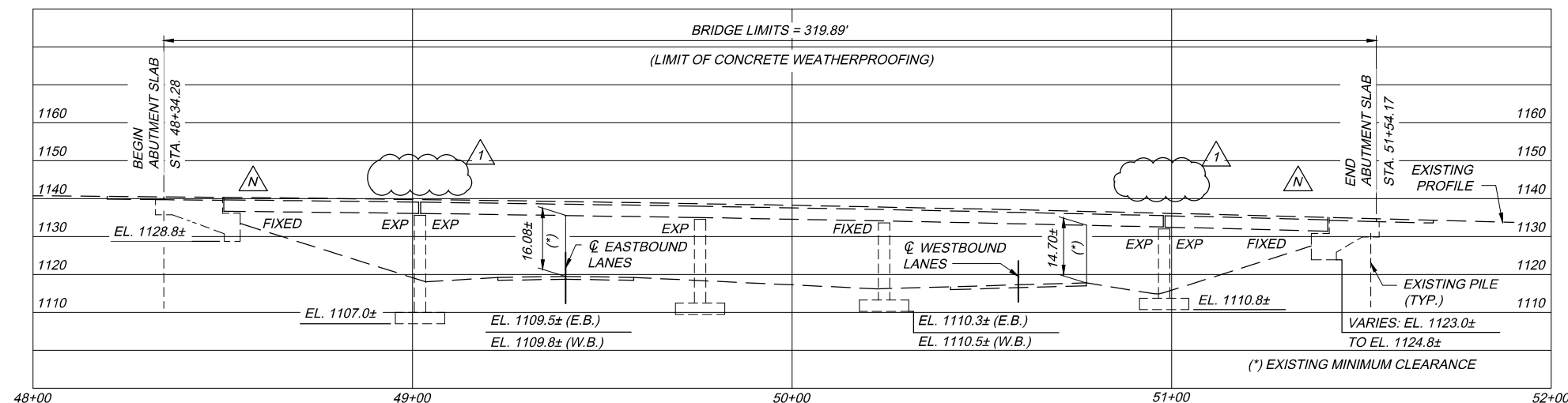

**PROFILE ALONG C CONSTRUCTION U.S. ROUTE 224**

  
**OHIO TURNPIKE AND INFRASTRUCTURE COMMISSION**

**PROJECT 43-16-05A**  
 U.S. RT. 224 (BOARDMAN-CANFIELD RD.) OVER OHIO TURNPIKE  
 MAHONING COUNTY  
 M.P. 227.6

DATE: 10/09/15

DESIGN AGENCY: TranSystems  
 BY DATE: ZTW 10/23/15  
 REVISIONS: ADDENDUM 1  
 NO. 1  
 CHECKED: NRF  
 IN CHARGE: JLV  
 DESIGNED: ZTW  
 DRAWN: JLV

57  
 77

**BID FORM PROJECT NO. 43-16-05**

Ref. No.	Item No.	Item Description	Approx. Quantity	Unit	Unit Cost	Extended Bid Amount
<b>PART A AND PART B - GENERAL (Ref. Nos. 1 - 5)</b>						
1	IB.ART.6	PREMIUM FOR CONTRACT PERFORMANCE BOND AND PAYMENT BOND	1	LUMP		
2	SP 614	MAINTAINING TRAFFIC	1	LUMP		
3	SP 619	FIELD OFFICE	1	LUMP		
4	SP 623	CONSTRUCTION LAYOUT SURVEY	1	LUMP		
5	624	MOBILIZATION	1	LUMP		
<b>TOTAL - GENERAL</b>						

<b>PART A - BRIDGE REHABILITATION (Ref. Nos. 6 - 39)</b>						
6	SP 202	PORTIONS OF STRUCTURE REMOVED	1	LUMP		
7	203	EMBANKMENT, USING NATURAL SOILS, 703.16.A	19	CU. YD.		
8	SP 509	EPOXY COATED REINFORCING STEEL, GRADE 60	681	POUND		
9	510	DOWEL HOLES WITH NONSHRINK, NONMETALLIC GROUT	40	EACH		
10	SP 511B	CLASS S CONCRETE, BARRIERS AND PARAPETS, USING TYPE 1 CEMENT	5	CU. YD.		
11	SP 511B	CLASS HP4 CONCRETE, SUPERSTRUCTURE DECK SLAB	4	CU. YD.		
12	513	STRUCTURAL STEEL, MISC.: BEARING STIFFENER RETROFIT	1	EACH		
13	513	STRUCTURAL STEEL, MISC.: STRUCTURAL STEEL REPAIR	1	EACH		
14	SP 516A	CRACK REPAIR USING EPOXY INJECTION	93	FOOT		
15	SP 516B	SEALING OF CONSTRUCTION JOINTS	8,243	FOOT		
16	SP 516G	REPLACE EXPANSION BEARING DEVICE	114	EACH		
17	SP 516J	REPLACE FIXED BEARING DEVICE	58	EACH		
18	518	DOWNSPOUT MODIFICATION	2	EACH		
19	SP 519	PATCHING CONCRETE STRUCTURES	2,422	SQ. FT.		
20	SP 527	FALSEWORK, TEMPORARY BRACING AND PROTECTIVE STRUCTURES	1	LUMP		
21	SP 533D	CONTINUOUS ELASTOMER SEAL IN A PORTLAND CEMENT CONCRETE JOINT	34	FOOT		
22	SP 533E	CONTINUOUS ELASTOMER SEAL IN ELASTOMERIC CONCRETE JOINT	422	FOOT		
23	SP 533F	REPLACEMENT OF COMPRESSION SEAL WITH CONTINUOUS ELASTOMER SEAL	189	FOOT		
24	SP 533G	REPLACEMENT OF STRIP SEAL WITH CONTINUOUS ELASTOMER SEAL	638	FOOT		
25	SP 536	CONCRETE WEATHERPROOFING, SUBSTRUCTURE	6,227	SQ. YD.		
26	SP 536	CONCRETE WEATHERPROOFING, DECK, ABUTMENT SLABS, AND APPROACH SLABS	11,801	SQ. YD.		
27	SP 536	CONCRETE WEATHERPROOFING, BARRIERS AND PARAPETS	6,790	SQ. YD.		
28	SP 607	TYPE 1 FENCE, ALL ALUMINUM (9'-0" CHAIN LINK WITH SPECIALS)	33	FOOT		
29	849	HEAT STRAIGHTENING MEMBER	1	LUMP		
30	SPECIAL	PATCHING CONCRETE BRIDGE DECKS, TYPE B	34	SQ. YD.		
31	202	CONCRETE MEDIAN REMOVED	540	FOOT		
32	452	11" NON-REINFORCED CONCRETE PAVEMENT	120	SQ. YD.		
33	614	WORK ZONE CENTER LINE, CLASS 1	1.20	MILE		
34	614	WORK ZONE EDGE LINE, CLASS 1	1.40	MILE		
35	614	WORK ZONE STOP LINE, CLASS 1	60	FOOT		
36	642	EDGE LINE, 4", TYPE 1	0.70	MILE		
37	642	LANE LINE, 4", TYPE 1	0.50	MILE		
38	642	CENTER LINE, TYPE 1	0.70	MILE		
39	642	LANE ARROW, TYPE 1	2	EACH		
<b>TOTAL - PART A - BRIDGE REHABILITATION</b>						

Ref. No.	Item No.	Item Description	Approx. Quantity	Unit	Unit Cost	Extended Bid Amount
<b>PART B - BRIDGE DECK REPLACEMENT AND REHABILITATION (Ref. Nos. 40 - 79)</b>						
40	SP 202	PORTIONS OF STRUCTURE REMOVED	1	LUMP		
41	202	PAVEMENT REMOVED	7	SQ. YD.		
42	202	CATCH BASIN REMOVED	1	EACH		
43	202	PIPE REMOVED	22	FOOT		
44	202	CURB REMOVED	190	FOOT		
45	202	GUARDRAIL REMOVED	712	FOOT		
46	203	EMBANKMENT	21	CU. YD.		
47	254	PAVEMENT PLANING, ASPHALT CONCRETE, VARIABLE DEPTH	485	SQ. YD.		
48	301	ASPHALT CONCRETE BASE, PG64-22	1	CU. YD.		
49	304	AGGREGATE BASE	1	CU. YD.		
50	407	TACK COAT	36	GAL		
51	407	TACK COAT FOR INTERMEDIATE COURSE	20	GAL		
52	448	ASPHALT CONCRETE SURFACE COURSE, TYPE 1, PG64-22	18	CU. YD.		
53	448	ASPHALT CONCRETE INTERMEDIATE COURSE, TYPE 2, PG64-22	28	CU. YD.		
54	SP 509	EPOXY COATED REINFORCING STEEL, GRADE 60	121,362	POUND		
55	510	DOWEL HOLES WITH NONSHRINK, NONMETALLIC GROUT	104	EACH		
56	SP 511B	CLASS HP4 CONCRETE, SUPERSTRUCTURE DECK SLAB	395	CU. YD.		
57	SP 511B	CLASS HP4 CONCRETE, ABUTMENT SLAB	57	CU. YD.		
58	SP 511B	CLASS S CONCRETE, BARRIERS AND PARAPETS, USING TYPE 1 CEMENT	141	CU. YD.		
59	SP 511B	CLASS HP4 CONCRETE, FOR PREPLACEMENT TESTING	3	CU. YD.		
60	513	WELDED STUD SHEAR CONNECTORS	5,103	EACH		
61	SP 516B	SEALING OF CONSTRUCTION JOINTS	931	FOOT		
62	SP 516G	REPLACE EXPANSION BEARING DEVICE	28	EACH		
63	SP 519	PATCHING CONCRETE STRUCTURES	12	SQ. FT.		
64	SP 527	FALSEWORK, TEMPORARY BRACING AND PROTECTIVE STRUCTURES	1	LUMP		
65	SP 533	THREE (3) INCH CONTINUOUS STRIP SEAL IN STRUCTURAL STEEL JOINT	122	FOOT		
66	SP 536	CONCRETE WEATHERPROOFING, DECK AND ABUTMENT SLABS	1,371	SQ. YD.		
67	SP 536	CONCRETE WEATHERPROOFING, BARRIERS AND PARAPETS	816	SQ. YD.		
68	SP 536	CONCRETE WEATHERPROOFING, SUBSTRUCTURE	655	SQ. YD.		
69	606	GUARDRAIL, TYPE MGS	400	FOOT		
70	606	MGS BRIDGE TERMINAL ASSEMBLY, TYPE 1	8	EACH		
71	SP 607	TYPE II FENCE, ALL ALUMINUM (6'-0" CHAIN LINK WITH SPECIALS)	896	FOOT		
72	609	CURB, TYPE 4-C	158	FOOT		
73	611	12" CONDUIT, TYPE B	6	FOOT		
74	611	12" CONDUIT, TYPE F	16	FOOT		
75	611	CATCH BASIN, NO. 3A	1	EACH		
76	611	CATCH BASIN ADJUSTED TO GRADE	7	EACH		
77	642	EDGE LINE, TYPE 1	0.22	MILE		
78	642	CENTER LINE, TYPE 1	0.11	MILE		
79	659	SEEDING AND MULCHING	168	SQ. YD.		
<b>TOTAL - PART B - BRIDGE DECK REPLACEMENT AND REHABILITATION</b>						

### BID SUMMARY

The total amount of the preceding Bid, based upon the approximate quantities given above, and the Unit Prices and Lump Sum specified by the undersigned, amounts to the sum of:

TOTAL BASE BID (INCLUDES REF. NO. 1 THRU REF. NO. 79) ----->

Item No.'s that do not have an IB or SP designation are items drawn from the 2010 ODOT CMS. Bidders should refer to the 2010 ODOT CMS for information and guidance concerning these items.