



**OHIO TURNPIKE AND
INFRASTRUCTURE COMMISSION**

ADDENDUM NO. 2

PROJECT NO. 43-19-07

BRIDGE REHABILITATION AND 3RD LANE WIDENING
OHIO TURNPIKE OVER AI CREEK M.P. 47.4,
OHIO TURNPIKE OVER S.R. 64 (N. MAIN ST.) M.P. 47.5
MILEPOST 46.50 TO MILEPOST 50.92
FULTON AND LUCAS COUNTIES, OHIO

EXTENDED TO 2:00 P.M. (EASTERN TIME), ~~JANUARY 4~~ *JANUARY 10*, 2019

ATTENTION OF BIDDERS IS DIRECTED TO:

ANSWERS TO QUESTIONS RECEIVED THROUGH 3:00 P.M. ON DECEMBER 21, 2018

-AND-

MODIFICATIONS TO THE CONTRACT DOCUMENTS

Plan Sheets: 8, 9, 11, and 122 of 349

Issued by the Ohio Turnpike and Infrastructure Commission by Anthony D. Yacobucci, Chief Engineer,
and Mark R. Musson, Director of Contracts Administration.

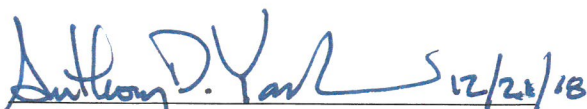
Anthony D. Yacobucci Date 12/21/18

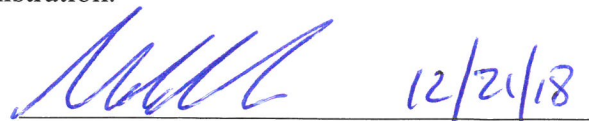
Mark R. Musson Date 12/21/18

ANSWERS TO QUESTIONS RECEIVED THROUGH 3:00 P.M. ON DECEMBER 21, 2018:

Q#14 Due to Project 49-19-03 letting on 12.21.18 and the likelihood of prebid questions taking place during the Holiday season, the Contractor does not have sufficient time to prepare the bid. Would OTIC consider delaying the bid date one week?

A#14 Through this Addendum No. 2, the Commission extends the Bid Opening to 2:00 P.M. (Eastern) on Thursday, January 10, 2019.

Q#15 Would it be permissible to place construction access points between the structures for Phases 3 & 4?

A#15 Temporary Access Deduct Alternate proposals will be considered on this Project. The Contractor shall comply with all requirements of the Contract Documents, including but not limited to SP104 and SP109. The Commission will amend the Bid Schedule of Items and Estimated Quantities Worksheet through Addendum No. 3.

Q#16 Would the Turnpike Commission please consider a week delay in regards to the bid date due to the focus of potential bidders being on project 43-19-03 (bids 12/21) while also providing some consideration to the Holiday Schedule preceding the bid date of 01/04/2019. Some of the bidders have not had a chance to submit many pre-bid questions as of yet, and a delay would also aid this scenario. Should this request be granted it would be greatly appreciated.

A#16 See the response to Q#14.

Q#17 Stormwater BMPS are all covered under line items in the proposal along with SWPPP Inspection and Management covered under SP 113. There is a lump sum line item for 832 Erosion Control, but no direction as to what work to include under this item. Please clarify the work to be completed under this line item.

A#17 This Addendum No. 2 revises the ADDITIONAL CONTROLS note on Plan Sheet 122 of 349 to reflect that the unit price bid shall be LUMP SUM. No quantity revisions are required as a result of this revision.

Q#18 Please provide all available bridge and roadway soil borings.

A#18 The Commission will respond to this question in Addendum No. 3.

Q#19 SP404A Joint Sealer is calculated for only 1 length of both Westbound & Eastbound. The note on sheet 8 of the Typical Sections say it is to be applied to the vertical face of both the SP402 & SP402 and the SP404A in the Special Provisions say to apply it to all cold longitudinal joints. Will this item be paid for each application of the joint sealer or will it be paid only for the length calculated regardless of how many cold longitudinal joints are placed (between lanes/shoulder, phase joints, etc.)?

A#19 The Commission revises Plan Sheets 8, 9 and 11 of 349 through this Addendum No. 2 to add Balloon 17, SP 404A – Joint Sealer to all vertical faces created by a saw cut. The item will be paid only for the calculated length of the vertical face regardless of the number of pavement courses placed adjacent to it. No quantity revisions are required as a result of this revision.

Q#20 Page 134 Please clarify where D-1 is not shown on the Plan and Profile

A#20 The Commission will respond to this question in Addendum No. 3.

Q#21 D-12 on sheet 139/349 shows an existing 15” cross over pipe, and Sheet 172 shows a 18” pipe? please confirm pipe size.

A#21 The Commission will respond to this question in Addendum No. 3.

Q#22 D-55 on sheet 147 It appears that the 50’ of Bore and Jack pipe is not enough length to get under both the ramp and the mainline pavements. How is pavement removed and replaced being paid for.

A#22 The Commission will respond to this question in Addendum No. 3.

Q#23 The Ref. No. show on sheet 154 of the plan and profile at station 126+64 shows D-70. Should this be D-71

A#23 The Commission will respond to this question in Addendum No. 3.

Q#24 Inlet at station 126+94 is missing the quantity for the 15” outlet pipe (4’) and also the removal of this pipe

A#24 The Commission will respond to this question in Addendum No. 3.

Q#25 Inlet shown at station 129+75 is missing from the Sub Summary page

A#25 The Commission will respond to this question in Addendum No. 3.

Q#26 X-Section sheet 164 Please review stations 1299+00 and 1300+00. It appears that the area in the center is listed as a fill, in the end area calculation and should be listed as a cut.

A#26 The Commission will respond to this question in Addendum No. 3.

Q#27 Please review the completion date for this project, looking at some of the major items of work you have 252 shifts. If the contractor is allowed to start work on February 1st there is 259 calendar days to the October 18th completion date. Per SP120A you are to build 42 weather days into your schedule from February to October, leaving you with 217 days to complete work on this project. Also, holiday restrictions could potentially cut this down by another 14 days.

A#27 The Commission will respond to this question in Addendum No. 3.

Q#28 Will the guardrail height need to be adjusted after placing Class A, Type 2 Pavement on the existing shoulder? If so, please add a bid item for this work.

A#28 The Commission will respond to this question in Addendum No. 3.

Q#29 Please provide more detail for Ref. 97 – Covering of Existing Catch Basin Grate. There are no notes or details for this work in the plan set.

A#29 The Commission will respond to this question in Addendum No. 3.

Q#30 Can ODOT asphalt mixes be used in lieu of OTIC asphalt mixes called out in OTIC Standard Drawing XOV-2?

A#30 The Commission will respond to this question in Addendum No. 3.

Q#31 Sheet 1 of the plans calls out ODOT Supplemental Specification 832 dated 10/19/18. This version of the supplemental spec requires the use of SWPPPTrack Software. Is the intent to mandate the Contractor use SWPPPTrack and the current ODOT 832 inspection requirements?

A#31 The Commission will respond to this question in Addendum No. 3.

Q#32 This project bids on January 4, 2019. The Commission's Award/Resolution meeting is scheduled for January 28, 2019. SP103 Items A through C are all time-sensitive milestone

dates for starting work on this project (item A calls for the NTP upon receipt of fully executed contract, item B calls for Baseline Schedule submitted within 14 days of NTP and accepted within 30 calendar days of NTP, and item C gives early access to the contractor on February 1, 2019 based on items A and B being in complete order. Will the Commission consider an earlier special award meeting date for this contract in order to give this schedule-critical project an opportunity for the February 1, 2019 start date?

A#32 The Commission will respond to this question in Addendum No. 3.

MODIFIED CONTRACT DOCUMENTS

With this Addendum No. 2, the Commission substitutes the enclosed material for the following Contract Documents:

Plan Sheets: 8, 9, 11, and 122 of 349 with additions to the Plan Drawings are called out with a cloud and a revision triangle as thus:



With this Addendum No. 2, the Commission revises the notice and coverpage to extend the bid opening to 2:00 P.M. (Eastern) on *January 10, 2019*.

Receipt of Addendum No. 2

Project No. 43-19-07 is hereby acknowledged:

(Firm Name) _____

(Signature) _____

(Printed Name) _____

(Date) _____

**BIDDERS MUST RETURN THE ABOVE ACKNOWLEDGEMENT
OF RECEIPT OF ADDENDUM NO. 2 WITH THEIR BID.**

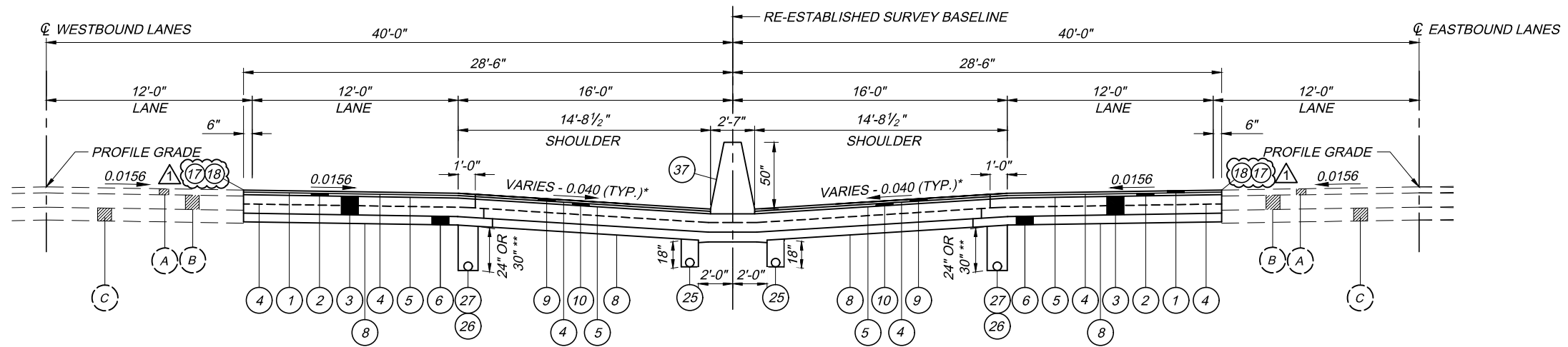

NORMAL SECTION

STA 1312+50.00 TO STA 1327+50.00 =	1,500.00 L.F.
STA 1345+50.00 TO STA 1384+16.60 (BACK) =	3,866.60 L.F.
STA EQ: 1384+16.60 (BACK) = STA 0+30.00 (AHEAD)	
STA 0+30.00 (AHEAD) TO STA 14+40.00 (BACK) =	1,410.00 L.F.
STA EQ: STA 14+40.00 (BACK) = STA 14+50.00 (AHEAD)	
STA 14+50.00 (AHEAD) TO STA 81+00.00 =	6,650.00 L.F.
STA 100+00.00 TO STA 118+40.00 =	1,840.00 L.F.
STA EQ: 118+40.00 (BACK) = STA 119+00.00 (AHEAD)	
STA 119+00.00 TO STA 125+00.00 =	600 L.F.

PROPOSED LEGEND

- 1 SP 404 ASPHALT CONCRETE SURFACE COURSE, USING CRUSHED SLAG, PG 76-22 (FR) (T=1-1/2")
- 2 SP 402 ASPHALT CONCRETE INTERMEDIATE COURSE OR RECYCLED ASPHALT CONCRETE INTERMEDIATE COURSE, PG 76-22 (FR) (T=1-3/4")
- 3 SP 302 ASPHALT CONCRETE BASE, PG 64-22 (T=12") (2 EQUAL LIFTS) (SEE NOTE 1)
- 4 ITEM 407 NON-TRACKING TACK COAT (APPLIED @ 0.06 GAL./S.Y.)
- 5 ITEM 407 NON-TRACKING TACK COAT (APPLIED @ 0.075 GAL./S.Y.)
- 6 SP 304 AGGREGATE BASE (T=6")
- 7 SP 304 AGGREGATE BASE (VAR. THICKNESS) (WITHOUT GUARDRAIL)
- 8 ITEM 206 CHEMICALLY STABILIZED SUBGRADE, AS PER PLAN, SEE SHEET 16.
- 9 SP 404 ASPHALT CONCRETE SURFACE COURSE, USING CRUSHED STONE, PG 64-22 (T=1-1/2")
- 10 SP 402 ASPHALT CONCRETE INTERMEDIATE COURSE OR RECYCLED ASPHALT CONCRETE INTERMEDIATE COURSE, PG 64-22 (T=1-3/4")
- 11 SP 302 ASPHALT CONCRETE BASE, PG 64-22 (SHOULDER) (T=8")
- 12 SP 304 AGGREGATE BASE (SHOULDER) (T=10") (2 EQUAL LIFTS)
- 13 ITEM 659 SEEDING AND MULCHING
- 14 SP 627 STONE SHOULDER PROTECTION (WITH GUARDRAIL) (T=3")
- 15 ITEM SPECIAL SONIC NAP ALERT PATTERN (SNAP)
- 16 ITEM 606 GUARDRAIL, TYPE MGS WITH LONG STEEL POSTS
- 17 SP 404A JOINT SEALER (APPLIED TO VERTICAL FACE, SP 402 AND SP 404)
- 18 ITEM 252 FULL DEPTH PAVEMENT SAWING
- 19 ITEM 659 TOPSOIL (T=3")
- 20 ITEM 209 LINEAR GRADING, AS PER PLAN
- 21 ITEM 526 REINFORCED CONCRETE APPROACH SLAB (T=12"), AS PER PLAN
- 22 SP 304 AGGREGATE BASE (T=9-1/4")
- 23 ITEM 204 SUBGRADE COMPACTION

- 24 ITEM 609 CURB, TYPE 4-A
- 25 SP 605 6" BASE PIPE UNDERDRAIN, WITH FABRIC WRAP (18")
- 26 SP 605 6" SHALLOW PIPE UNDERDRAIN, WITH FABRIC WRAP (24")
- 27 SP 605 6" SHALLOW PIPE UNDERDRAIN, WITH FABRIC WRAP (30")
- 28 ITEM 609 ASPHALT CONCRETE CURB, TYPE 1, PG 64-22
- 29 ITEM 622 CONCRETE BARRIER, SINGLE SLOPE, TYPE D, AS PER PLAN
- 30 ITEM 609 CURB, TYPE 4-C
- 31 SP 404 ASPHALT CONCRETE SURFACE COURSE, USING CRUSHED SLAG, PG 76-22 (FR) (T=1-1/4")
- 32 SP 403 ASPHALT CONCRETE LEVELING COURSE, USING CRUSHED STONE, PG 76-22 (FR) (T=3/4")
- 33 ITEM 254 PAVEMENT PLANING, ASPHALT CONCRETE (VARIABLE DEPTH)
- 34 SP 404 ASPHALT CONCRETE SURFACE COURSE, USING CRUSHED STONE, PG 64-22 (T=2")
- 35 ITEM 254 PAVEMENT PLANING, ASPHALT CONCRETE (T=2")
- 36 SP 404 ASPHALT CONCRETE SURFACE COURSE, USING CRUSHED SLAG, PG 76-22 (FR) (T=2")
- 37 ITEM 622 CONCRETE BARRIER, SINGLE SLOPE, TYPE B-50, AS PER PLAN
- 38 NOT USED NOT USED
- 39 ITEM 622 CONCRETE BARRIER, SINGLE SLOPE, TYPE C-50, AS PER PLAN

EXISTING LEGEND

- (A) ASPHALT CONCRETE (T=5"±)
- (B) CONCRETE PAVEMENT (T=10"±)
- (C) AGGREGATE BASE (T=6"±)
- (D) 6" UNDERDRAIN
- (E) REINFORCED CONCRETE APPROACH SLAB (T=10"±)
- (F) BITUMINOUS AGGREGATE BASE (T=10"±)
- (G) GUARDRAIL
- (H) CONCRETE BARRIER
- (J) AGGREGATE BASE (T=10 1/2"± AVERAGE)
- (K) ASPHALT CONCRETE (T=9"±)

COMMON NOTES

- NOTE 1: ITEM 407 - NON-TRACKING TACK COAT SHALL BE PLACED ON SURFACE OF SP 302 AND ITEM 407 - NON-TRACKING TACK COAT FOR INTERMEDIATE COURSE SHALL BE PLACED BETWEEN THE LIFTS OF SP 302.
- NOTE 2: THE TRAVELED LANE PAVEMENT COMPOSITION SHALL EXTEND 1 FOOT INTO THE SHOULDER.
- NOTE 3: ASPHALT OR CONCRETE CURB SHALL BE SEALED PER THE REQUIREMENTS OF SP 400.
- NOTE 4: ALL EXPOSED SUBGRADE SHALL HAVE SUBGRADE STABILIZATION PERFORMED USING ITEM 206 - CHEMICALLY STABILIZED SUBGRADE, AS PER PLAN. SEE GENERAL NOTES SHEET 16.
- NOTE 5: FOR PAVEMENT AND SHOULDER WIDTHS AND CROSS SLOPES, SEE PAVEMENT ELEVATION TABLES ON SHEETS 237 - 246.

* SLOPE VARIES. SEE PAVEMENT ELEVATION TABLE ON SHEETS 237 - 246 FOR SLOPES. (7% MAXIMUM ROLLOVER FOR SHOULDERS).

** SEE UNDERDRAIN SUBSUMMARY SHEET 118 FOR STATION LIMITS.

DESIGNED BY: J.M.P. / DRAWN BY: P.S.L.

CHECKED BY: W.D.B. / IN CHARGE BY: W.D.B.

NO. 1

REVISIONS: ADDENDUM NO. 2

DATE: 12/18/18

DESIGN AGENCY:

PROJECT 43-19-07

DATE: 12/06/18

1 / 6

8 / 349

OHIO TURNPIKE AND INFRASTRUCTURE COMMISSION

H:\2018\180192\DWG\SHEETS\SC - TYP1 - 12/21/2018 1:14:16 PM - KEVIN ABRAMS

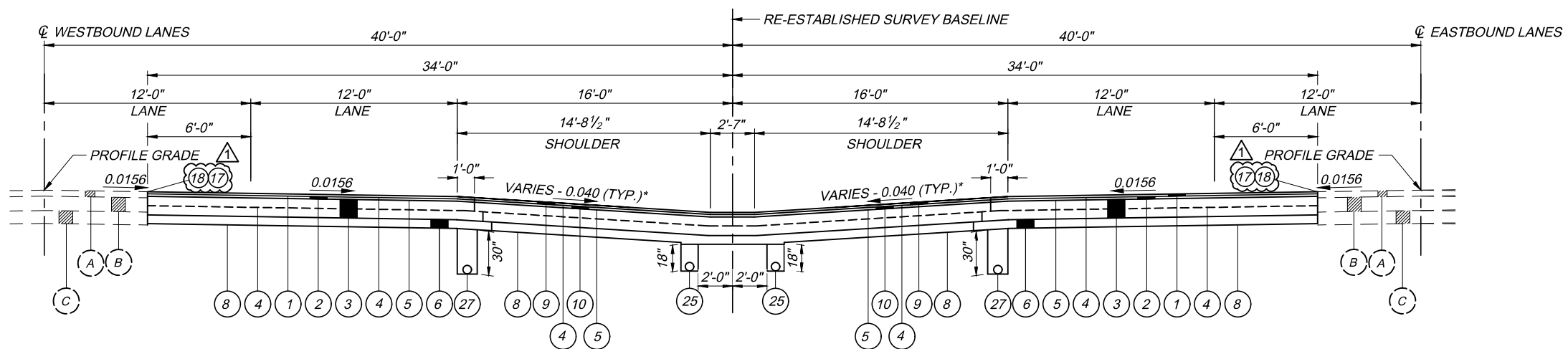

PATROL CROSSOVER SECTION

<u>WESTBOUND</u>	
STA 1306+32.35 TO STA 1307+16.83 =	84.84 L.F.
STA 130+00.00 TO STA 130+96.93 =	96.93 L.F.
<u>EASTBOUND</u>	
STA 1306+18.07 TO STA 1307+16.83 =	98.76 L.F.
STA 130+00.00 TO STA 130+82.65 =	82.65 L.F.

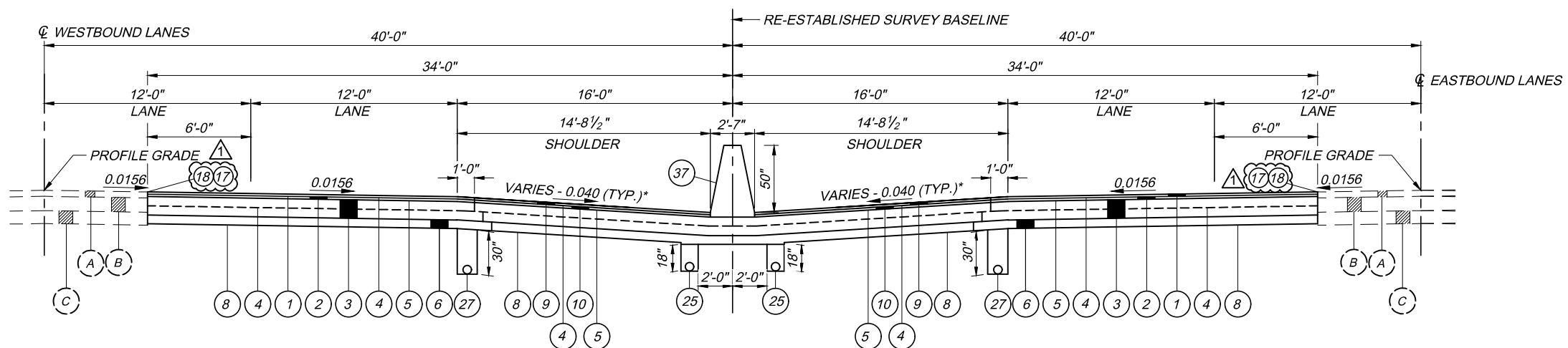

NORMAL SECTION

STA 1307+16.83 TO STA 1312+50.00 =	533.17 L.F.
STA 125+00.00 TO STA 130+00.00 =	500.00 L.F.

* SLOPE VARIES. SEE PAVEMENT ELEVATION TABLE ON SHEETS 237 - 246 FOR SLOPES. (7% MAXIMUM ROLLOVER FOR SHOULDERS).

FOR ADDITIONAL NOTES, EXISTING AND PROPOSED LEGENDS, SEE SHEET 8.

H:\2018\180192\DWG\SHEETS\C - TYP2 - 12/21/2018 1:14:45 PM - KEVIN ABRAMS

DESIGN AGENCY	
PROJECT 43-19-07	DATE: 12/06/18
TYPICAL SECTIONS	2 / 6
DESIGNED: J.M.P. DRAWN: P.S.L.	CHECKED: W.D.B. IN CHARGE: W.D.B.
NO. 1	REVISIONS
ADDENDUM NO. 2	BY DATE
KPA 12/21/18	KPA 12/21/18
OHIO TURNPIKE AND INFRASTRUCTURE COMMISSION	
OHIO TURNPIKE	

NOTES:
 * SLOPE VARIES. SEE PAVEMENT ELEVATION TABLE FOR SLOPES. (7% MAXIMUM ROLLOVER FOR SHOULDERS)

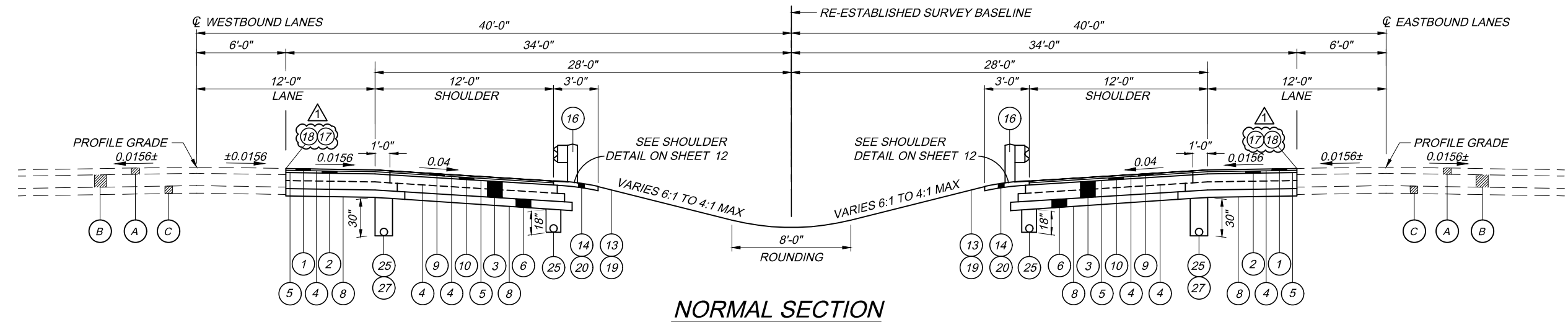

NORMAL SECTION

STA 1281+00.00 TO STA 1306+45.00 = 2,545.00 L.F.

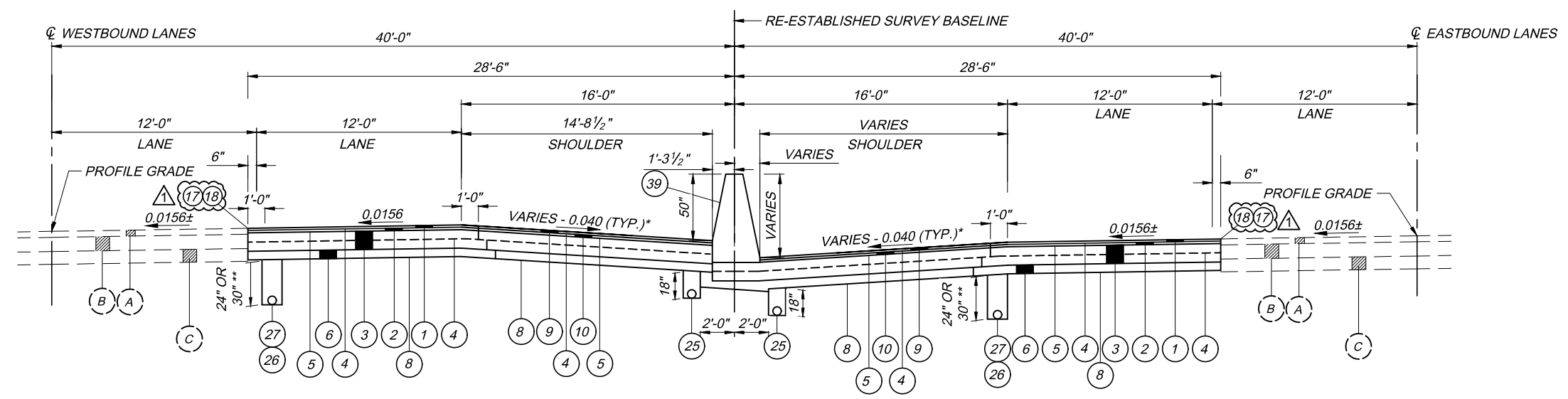

SUPERELEVATED SECTION (LEFT)

STA 81+00.00 TO STA 100+00.00 = 1,900.00 L.F.

* SLOPE VARIES. SEE PAVEMENT ELEVATION TABLE ON SHEETS 237 - 246 FOR SLOPES. (7% MAXIMUM ROLLOVER FOR SHOULDERS).
 ** SEE UNDERDRAIN SUB SUMMARY TABLE ON SHEET 118

FOR ADDITIONAL NOTES, EXISTING AND PROPOSED LEGENDS, SEE SHEET 8.

H:\2018\180192\DWG\SHEETS\180192 - TYPICAL SECTIONS.DWG - TYP4 - 12/21/2018 1:15:24 PM - KEVIN ABRAMS

DESIGN AGENCY		BY DATE	
		KPA 12/21/18	
DESIGNED		NO.	
J.M.P.	W.D.B.	1	
DRAWN	IN CHARGE		
P.S.L.	W.D.B.		
TYPICAL SECTIONS		PROJECT 43-19-07	
		DATE: 12/06/18	
		4 / 6	
		11	
		349	
OHIO TURNPIKE AND INFRASTRUCTURE COMMISSION		OHIO TURNPIKE	

OHIO TURNPIKE AND INFRASTRUCTURE COMMISSION

THE JAMES W. SHOCKNESSY OHIO TURNPIKE



PROJECT NO. 43-19-07 BRIDGE REHABILITATION AND 3RD LANE WIDENING OHIO TURNPIKE OVER AI CREEK M.P. 47.4, OHIO TURNPIKE OVER S.R. 64 (N. MAIN ST.) M.P. 47.5 MILEPOST 46.50 TO MILEPOST 50.92 FULTON AND LUCAS COUNTIES, OHIO

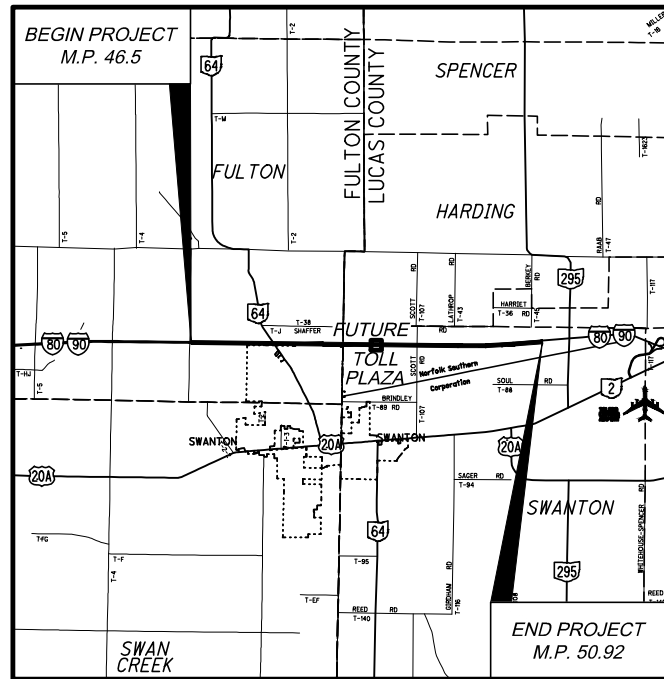

LATITUDE: 41° 36' 00" N LONGITUDE: 83° 52' 57" W

POST-CONSTRUCTION STORM WATER CONTROLS:

WATER QUALITY BASINS WILL BE INSTALLED TO MEET WATER QUALITY TREATMENT REQUIREMENTS AS A PART OF PROJECT 39-20-02. THE BASINS WILL BE SIZED TO MEET THE TREATMENT REQUIREMENTS OF BOTH PROJECTS. THE TOTAL WQV REQUIRED FOR PROJECTS 43-19-07 AND 39-20-02 IS APPROXIMATELY 1.62 ACRE FEET.

PROJECT DESCRIPTION:

CONSTRUCTION OF TEMPORARY PAVEMENT, CONSTRUCTION OF AN INSIDE THIRD LANE, MEDIAN BARRIER AND SHOULDER; AND WIDENING AND REDECKING OF BRIDGES AT MP 47.4 AND MP 47.5

PROJECT DATA

TOTAL AREA (RIGHT-OF-WAY)	165.0 AC.
PROJECT EARTH DISTURBED AREA	51.8 AC.
ESTIMATED CONTRACTOR EARTH DISTURBED AREA	5.0 AC.
NOTICE OF INTENT EARTH DISTURBED AREA	56.8 AC.
RUNOFF COEFFICIENT FOR PRE-CONSTRUCTION SITE	0.90
RUNOFF COEFFICIENT FOR POST-CONSTRUCTION SITE	0.90
TOTAL IMPERVIOUS AREA (PRE-CONSTRUCTION)	165.0 AC.
TOTAL IMPERVIOUS AREA (POST-CONSTRUCTION)	165.0 AC.
PERCENT IMPERVIOUS (POST-CONSTRUCTION)	100%
SOIL MAP REFERENCE	FULTON & LUCAS COUNTY SOIL SURVEY (NRCS WEB SOIL SURVEY)
IMMEDIATE RECEIVING WATERS	BEECHER DITCH, MURBACH DITCH, PRAIRIE DITCH, RUSHLAND DITCH, WIREGRASS DITCH, AI CREEK
SUBSEQUENT RECEIVING WATERS	SWAN CREEK, MAUMEE RIVER, LAKE ERIE
LATITUDE	41°36'00" N
LONGITUDE	83°52'57" W
USGS MAP REFERENCE	SWANTON, OH AND WHITEHOUSE, OH QUADRANGLES

DATE PREPARED: 11/02/18

SITE OPERATOR:

SWP3 AUTHORIZATION:

JAMES M. PETERS, P.E., CPESC
CT CONSULTANTS, INC.
8150 STERLING COURT
MENTOR, OHIO 44060
440.951.9000

INDEX OF SHEETS:

TITLE SHEET	1
GENERAL NOTES	2
SWPPP QUANTITIES AND SUBSUMMARY	3
STA. 1220+00 TO STA. 1277+00	4
STA. 1277+00 TO STA. 1334+00	5
STA. 1334+00 TO STA. 6+00	6
STA. 6+00 TO STA. 62+00	7
STA. 62+00 TO STA. 118+00	8
STA. 118+00 TO STA. 150+00	9
GRADING ACTIVITY AND AMENDMENT LOG	10

ITEM 832 - PERIMETER FILTER FABRIC FENCE

THE BOTTOM OF THE FENCE SHALL BE BURIED 6" BELOW THE GROUND. THE FENCE SHALL BE HIGH ENOUGH TO RETAIN SEDIMENT LADEN WATER AND ADEQUATELY SUPPORTED TO PREVENT COLLAPSE OR BURSTING. THE GROUND ELEVATION OF THE FENCE SHALL BE HELD CONSTANT EXCEPT THAT THE END ELEVATION SHALL BE RAISED TO PREVENT FLOW AROUND THE END OF THE FENCE.

THE FILTER FABRIC SHALL BE MAINTAINED TO BE FUNCTIONAL. THIS SHALL INCLUDE REMOVAL OF TRAPPED SEDIMENT AND REQUIRED CLEANING, REPAIR AND/OR REPLACEMENT OF THE FILTER FABRIC.

THE COST OF ALL MATERIALS, CONSTRUCTION, MAINTENANCE AND REMOVAL REQUIRED SHALL BE PAID FOR UNDER ITEM 832 - PERIMETER FILTER FABRIC FENCE.

APPLICABLE STANDARD DRAWINGS:

ODOT HYDRAULIC STANDARD CONSTRUCTION DRAWING DM-4.3
ODOT HYDRAULIC STANDARD CONSTRUCTION DRAWING DM-4.4

WATERS OF THE STATE PROTECTION:

IF CONSTRUCTION ACTIVITIES DISTURB AREAS ADJACENT TO WATERS OF THE STATE, STRUCTURAL PRACTICES SHALL BE IMPLEMENTED ON SITE TO PROTECT ALL ADJACENT WATERS OF THE STATE FROM THE IMPACTS OF SEDIMENT RUNOFF. NO STRUCTURAL SEDIMENT CONTROLS SHALL BE USED IN THE WATERS OF THE STATE. FOR ALL CONSTRUCTION ACTIVITIES IMMEDIATELY ADJACENT TO SURFACE WATERS OF THE STATE, A FIFTY (50) FOOT PERMANENT BUFFER SETBACK FROM AN INTERMITTENT STREAM AND A SEVENTY-FIVE (75) FOOT SETBACK FROM A PERENNIAL STREAM SHOULD BE MAINTAINED IN ITS NATURAL STATE AND LEFT UNDISTURBED ALONG WATERS OF THE STATE, AS MEASURED FROM THE ORDINARY HIGH WATER MARK OF THE SURFACE WATER. WHERE IMPACTS WITHIN THIS SETBACK ARE UNAVOIDABLE DUE TO THE NATURE OF THE CONSTRUCTION ACTIVITY, THE PROJECT SHALL BE DESIGNED SUCH THAT THE NUMBER OF STREAM CROSSINGS AND THE WIDTH OF THE DISTURBANCE WITHIN THE SETBACK AREA ARE MINIMIZED.

THE CONTRACTOR SHALL NOT PLACE ANY EQUIPMENT IN OR PERFORM ANY WORK IN ANY OF THE STREAMS CROSSING THE PROJECT AREA. EQUIPMENT SHALL BE MOVED ACROSS STREAM CHANNELS ON EXISTING BRIDGES. NO TEMPORARY STREAM CROSSINGS MAY BE CONSTRUCTED.

ADDITIONAL CONTROLS:

ANY ADDITIONAL SEDIMENT AND EROSION CONTROLS REQUIRED TO MANAGE SEDIMENT AND EROSION FOR THIS PROJECT, NOT SEPARATELY ITEMIZED IN THE PLANS, AND REQUIRED IN THE STORM WATER POLLUTION PREVENTION PLAN AND/OR REQUIRED AS PART OF SUPPLEMENTAL SPECIFICATION 832, SHALL BE PAID FOR AT THE UNIT BID PRICE FOR ITEM 832 - EROSION CONTROL.

REQUIRED SWP3 SUBMITTALS:

THE CONTRACTOR SHALL PREPARE AND SUBMIT THE FOLLOWING TO THE OHIO COMMISSION IN ORDER TO FINALIZE THE STORM WATER POLLUTION PREVENTION PLAN:

- NOI CO-PERMITTEE FORM (SUBMIT TO OHIO EPA).
- SCHEDULE OF DISTURBANCE.
- IDENTIFICATION OF ALL ON-SITE BATCH PLANTS (IF ANY).
- IDENTIFICATION OF PROPOSED WASTE AND BORROW AREAS.
- IDENTIFICATION OF PROPOSED ON-SITE FUELING AREAS.
- IDENTIFICATION OF STAGING AND MATERIAL STORAGE AREAS.
- IDENTIFICATION OF BATCHING AREAS AND MIXING AREAS.
- SPILL PREVENTION CONTROL AND COUNTER MEASURES PLAN (IF NEC.).
- WASTE HANDLING PLAN.
- HAZARDOUS WASTE SPILL PLAN.

SWP3 NOTES:

THIS SWP3 IS MEANT TO BE USED AS A BASE PLAN FOR THE CONTRACTOR AND IS REQUIRED TO BE MODIFIED, AS NECESSARY, AND CERTIFIED THAT THE PLAN IS APPROPRIATE FOR THE MEANS, METHODS, AND CONSTRUCTION SCHEDULE TO BE EMPLOYED BY THE CONTRACTOR DURING CONSTRUCTION OF THIS PROJECT. FURTHERMORE, ANY MODIFICATIONS TO THE SWP3 REQUIRED AS A RESULT OF A CONTROL(S) NOT PERFORMING AS INTENDED, NOT INITIALLY PROPOSED, OR NOT REQUIRED SHALL BE TREATED AS A CHANGE ORDER ITEM. ONCE A CHANGE ORDER IS APPROVED, THE CONTRACTOR IS RESPONSIBLE FOR MAKING SURE THE SWP3 IS REVISED AND LOGGED IN THE SWP3 REVISION LOG.

BASED ON SOIL MAPPING IN THE LUCAS AND FULTON COUNTY SOIL SURVEYS, MODERATELY UNSTABLE OR ERODIBLE COLWOOD LOAM (Co), DIGBY LOAM (DmA), HASKINS LOAM (Hka), MERMILL LOAM (Mf), NAPPANEE LOAM (Nna), SHOALS SILT LOAM (Sh), SISSON LOAM (Smc), SLOAN SILTY CLAY LOAM (So), AND UDORTHENTS LOAM (Uo) NATIVE SOILS ARE PRESENT. THE CONTRACTOR SHALL TAKE CARE TO AVOID UNNECESSARILY DISTURBING EMBANKMENTS IN THE PROJECT AREA.

DESIGN AGENCY: **CT CONSULTANTS**
 PROJECT 43-19-07
 DATE: 12/06/18
 STORM WATER POLLUTION PREVENTION PLAN
 TITLE SHEET
 1 / 10
 122
 349
 OHIO TURNPIKE AND INFRASTRUCTURE COMMISSION

H:\2018\180192\DWG\SHEETS\SC_180192 - SWPPP TITLE.DWG - LAYOUT1 - 12/21/2018 1:12:38 PM - KEVIN ABRAMS