

**OHIO TURNPIKE AND  
INFRASTRUCTURE COMMISSION**

**ADDENDUM NO. 1**

**CONTRACT NO. 43-14-08**

**BRIDGE DECK REPAIR AND REHABILITATION  
OHIO TURNPIKE OVER NORFOLK SOUTHERN RAILROAD M.P. 147.9  
LORAIN COUNTY, OHIO**

**OPENING DATE: 2:00 P.M. (E.D.T.), JULY 3, 2014**

**ATTENTION OF BIDDERS IS DIRECTED TO:**

**MODIFICATIONS TO THE CONTRACT DOCUMENTS  
PLAN DRAWING SHEET 7 OF 12**

**SPECIAL PROVISIONS  
Page SP-83**

Issued by the Ohio Turnpike and Infrastructure Commission on June 27, 2014. Issuance authorized by Robin Carlin, Deputy Executive Director, and Tommie Jo Marsilio, Director, Contracts Administration.

  
\_\_\_\_\_  
Robin Carlin Date

  
\_\_\_\_\_  
Tommie Jo Marsilio Date

**OHIO TURNPIKE AND INFRASTRUCTURE COMMISSION  
ADDENDUM NO. 1  
CONTRACT NO. 43-14-08**

**MODIFICATIONS VIA ADDENDUM NO. 1 TO THE CONTRACT DOCUMENTS FOR  
CONTRACT NO. 43-14-08**

**Modifications to the Plan Drawing**

Additions and deletions on Plan Drawings are indicated with a cloud and revision triangle thus:



The following plan sheet has been updated and the new plan sheet should be substituted for:  
- Sheet number 7 of 12.

**Modifications to the Special Provisions**

Deletions in are shown with ~~strikethrough~~ text.  
Changes/Additions are shown with ***bold italicized*** text.

The following Special Provision sheet has been updated and the sheet should be substituted for:  
- Page SP-83

Addendum No. 1 to Contract No. 43-14-08 is hereby acknowledged:

\_\_\_\_\_  
(Firm Name)

\_\_\_\_\_  
(Signature)

\_\_\_\_\_  
(Printed Name)

Date: \_\_\_\_\_

waterway of rivers, creeks, streams and reservoirs. The protective structures in all cases shall extend beyond the existing and/or new exterior structural beams a sufficient distance to protect under the existing and proposed parapets, and shall have sidewalls extending a minimum of four (4) feet upward. The flooring and sidewalls of the protective structures shall have no cracks or openings through which material particles may fall.

2. The protective structure shall be designed for a loading of 100 pounds per square foot.
3. The protective structure design shall incorporate at least one (1) layer of 3/4-inch plywood placed between the lower flanges of the structural steel beams or girders at the above-mentioned locations.

The calculations and details for the protective structures shall be prepared by the Contractor and shall be stamped by a Professional Engineer registered in the State of Ohio.

Sidewalls shall be braced substantially to resist wind loads. During sawcutting and deck removal operations, temporary shields attached to the side walls and extending one (1) foot above the top of parapet, shall be installed to limits as directed by the Chief Engineer. Temporary shields shall be removed immediately after they have served its purpose. Debris shall not be permitted to collect on the protective structures.

When supporting the protective structures from the steelwork of the bridge(s), all connections thereto shall be made by means of approved clamps on both sides of the beam flange. The drilling of holes in the steelwork, or welding thereto, for this purpose will not be permitted. No portion of the temporary support system and/or protective structures (including connection devices) shall extend more than ten (10) inches below the bottom flange of the steel stringers or cover plates that are over the traveled way (pavement and shoulders or tracks) of a highway or railroad on which traffic is being maintained. However, in no instance shall the underclearance be less than fourteen (14) feet for a highway and ~~twenty-one (21)~~ **twenty-two (22)** feet for a railroad.

After the falsework, temporary bracing and protective structures have served its purpose, and when so directed by the Chief Engineer, they shall be removed. Protective structures, including sidewalls, shall not be removed until the parapets and parapet fence (if applicable) are completed, including weatherproofing. All material shall become the property of the Contractor and shall be removed from the site and disposed of by the Contractor at its own expense.

Details of the falsework, temporary bracing and protective structures for catching broken concrete and other materials shall be submitted, in quadruplet, to the Chief Engineer for approval. Details shall include the existing and the proposed temporary underclearances to the traveled way of a highway or railroad on which traffic is being maintained. Approval of these plans by the Chief Engineer shall not relieve the Contractor of its responsibility of providing a safe protection system.

C. Measurement and Payment

Falsework, temporary bracing and protective structures will be measured as a unit and shall be paid for at the Contract lump sum price bid. This price shall be

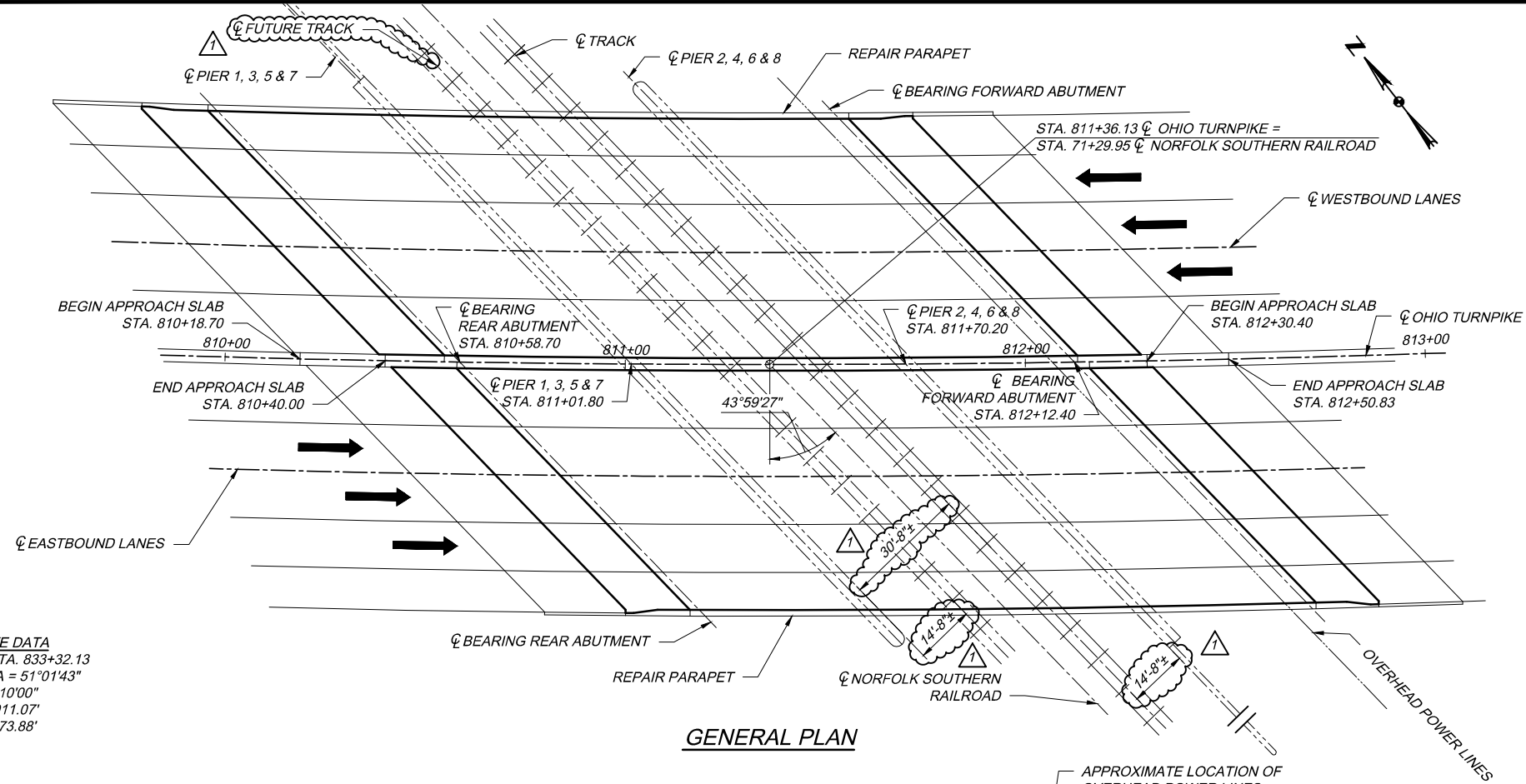

**GENERAL PLAN**

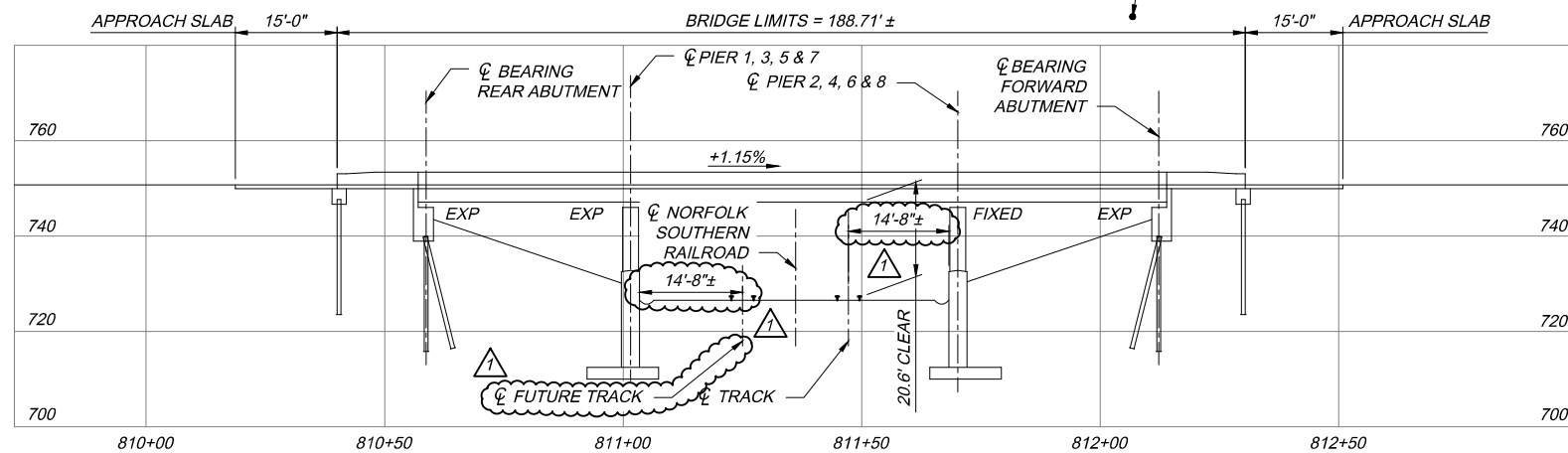

**ELEVATION**

M.P. 147.9 - OHIO TURNPIKE OVER NORFOLK SOUTHERN RAILROAD ESTIMATED QUANTITIES			
ITEM	TOTAL	UNIT	DESCRIPTION
SP 202	LUMP	LUMP SUM	PORTIONS OF STRUCTURE REMOVED
SP 509	100	LBS.	EPOXY COATED REINFORCING STEEL, GRADE 60
513	10	EACH	WELDED STUD SHEAR CONNECTORS, AS PER PLAN
SP 516A	50	LIN. FT.	CRACK REPAIR USING EPOXY INJECTION
SP 516B	1470	LIN. FT.	SEALING OF CONSTRUCTION JOINTS
SP 519	50	SQ. FT.	PATCHING CONCRETE STRUCTURES
SP 527	LUMP	LUMP SUM	FALSEWORK, TEMPORARY BRACING AND PROTECTIVE STRUCTURES
SP 533	340	LIN. FT.	CONTINUOUS STRIP SEAL IN STRUCTURAL STEEL JOINT
SP 536	1044	SQ. YD.	CONCRETE WEATHERPROOFING, DECK, ABUTMENT SLABS AND APPROACH SLABS
SP 536	515	SQ. YD.	CONCRETE WEATHERPROOFING, PARAPETS
SP 848	1267	SQ. YD.	CLASS S CONCRETE OVERLAY, USING SHRINKAGE COMPENSATING CEMENT, USING HYDRODEMOLITION
SP 848	1267	SQ. YD.	SURFACE PREPARATION USING HYDRODEMOLITION
SP 848	9	CU. YD.	CLASS S CONCRETE OVERLAY, USING SHRINKAGE COMPENSATING CEMENT (VARIABLE THICKNESS), MATERIAL ONLY
SP 848	3	CU. YD.	CLASS S CONCRETE, USING SHRINKAGE COMPENSATING CEMENT, FOR PRE-PLACEMENT TESTING
SP 848	1	CU. YD.	FULL-DEPTH REPAIR
SP 848	9	SQ. YD.	HAND CHIPPING
SPECIAL	378	LIN. FT.	REPLACEMENT OF PARAPET REINFORCING STEEL

**EXISTING/PROPOSED STRUCTURE**

TYPE: 3 SPAN NON-COMPOSITE STEEL BEAMS WITH REINFORCED CONCRETE DECK, REINFORCED CONCRETE ABUTMENTS, CAP AND COLUMN TYPE PIERS.  
 SPANS: 42'-4 5/16" ±, 67'-10 1/16" ±, AND 42'-4 5/16" ± C/C BEARINGS  
 ROADWAY: 59'-10" TOE/TOE OF PARAPETS  
 SKEW: 46°26'52" RIGHT FORWARD  
 WEARING SURFACE: MONOLITHIC CONCRETE  
 APPROACH SLABS: 15'-0" LONG  
 ALIGNMENT: 1°10'00" CURVE LEFT  
 BUILT: 1954 (REHABILITATED IN 1986, THIRD LANE ADDED IN 1996)  
 SFN: 4729587  
 OTIC MILEPOST: 147.9  
 COORDINATES: LATITUDE: 41°22'54" N, LONGITUDE: 82°04'07" W

**REQUIRED MINIMUM CLEARANCES:**  
 OHIO TURNPIKE OVER NORFOLK SOUTHERN RAILROAD M.P. 147.9

- VERTICAL  
 EXISTING = 20.6'  
 REQUIRED = 20.6'
- HORIZONTAL  
 EXISTING = 14'-8"  
 REQUIRED = 13'-0"

**PROPOSED REHABILITATION SCOPE OF WORK:**  
 OHIO TURNPIKE OVER NORFOLK SOUTHERN RAILROAD M.P. 147.9

- INSTALL TEMPORARY FALSEWORK BENEATH PORTIONS OF THE STRUCTURE TO BE REPAIRED OVER THE NORFOLK SOUTHERN RAILROAD IN ACCORDANCE WITH SP 527 AND SP 827B.
- REMOVE EXISTING CONCRETE WEARING SURFACE OF BRIDGE DECK AND ABUTMENT SLABS USING HYDRODEMOLITION AS PER SP 848.
- REPLACE REAR ABUTMENT AND FORWARD ABUTMENT EXPANSION JOINTS PER 533. SEE SHEET 11 FOR ADDITIONAL JOINT REPAIR DETAILS.
- EPOXY INJECT ALL CRACKS 1/8" WIDE OR LARGER PER SP 516A.
- PLACE CONCRETE OVERLAY PER SP 848.
- SEAL ALL TRANSVERSE JOINTS, CONSTRUCTION JOINTS, AND TOE OF PARAPET WITH HMWM RESIN PER SP 516B.
- REPAIR OUTSIDE PARAPETS IN ACCORDANCE WITH ITEM SPECIAL - REPLACEMENT OF PARAPET REINFORCING STEEL.
- REPAIR AREAS OF DETERIORATED PARAPET CONCRETE AS DIRECTED BY THE ENGINEER IN ACCORDANCE WITH SP 519.
- WEATHERPROOF SUPERSTRUCTURE CONCRETE AS SHOWN IN THE PLANS.
- PAINT EDGE AND LANE LINES PER ODOT CMS 642, AS PER PLAN.

**NOTES:**  
 • THE PLAN DETAILS SHOWN ARE FROM THE ORIGINAL CONSTRUCTION AND REHABILITATION PLANS, WHICH MAY NOT BE DRAWN TO SCALE AND ARE FOR INFORMATION ONLY.

ADDENDUM 1		CAC	6/2014
NO.	REVISIONS	BY	DATE
<b>OHIO TURNPIKE AND INFRASTRUCTURE COMMISSION</b>			
<b>GENERAL PLAN AND ELEVATION</b>			
OHIO TURNPIKE OVER NORFOLK SOUTHERN RR			
M.P. 147.9		LORAIN COUNTY	
DESIGNED:	CAC	CHECKED:	CMM
DRAWN:	CAC	IN CHARGE:	ADY
DATE:	4/01/2014	SCALE:	N.T.S.
<b>PROJECT 43-14-08 SHEET 7 OF 12</b>			