

OHIO TURNPIKE COMMISSION

ADDENDUM NO. 1

CONTRACT NO. 59-13-05

PAVEMENT & DRAINAGE IMPROVEMENTS
SWANTON MAINTENANCE BUILDING, MILEPOST 48.3
FULTON COUNTY, OHIO

OPENING DATE: 2:00 P.M. (E.D.T.), MAY 22, 2013

ATTENTION OF BIDDERS IS DIRECTED TO:

ANSWERS TO QUESTIONS RECEIVED THROUGH 12:00 P.M., MAY 16, 2013

MODIFICATIONS TO THE CONTRACT DRAWINGS

Plan Sheet 4 of 5

Issued by the Ohio Turnpike Commission May 16, 2013. Issuance authorized by Robin Carlin, Deputy Executive Director, and Kathleen Weiss, General Counsel.



Robin Carlin

5/16/13

Date



Kathleen Weiss

5/16/13

Date

**OHIO TURNPIKE COMMISSION
ADDENDUM NO. 1
CONTRACT NO. 59-13-05**

ANSWERS TO QUESTIONS RECEIVED THROUGH 12:00 P.M., MAY 16, 2013

Q#1 The note on sheet 4/5 for pavement fabric states that the fabric shall be installed with a 0.5" leveling Course and tack coat. I do not see a pay item for the leveling course is the cost of this leveling course of asphalt to be included in the cost of the fabric? Also is this 0.5" accounted for in the final elevation of the parking lot, or should the milling depth be 3.5"?

A#1 The Note referenced on Plan Sheet 4 of 5 is deleted via this Addendum No. 1. No leveling course is required. However, the paving fabric shall be installed in accordance with the SP 629 and the General Note, and any asphalt concrete material required to repair any milled areas will be paid under the applicable asphalt concrete Bid Item.

Q#2 Sheet 4/5 has a plan note requiring a 0.5" leveling course to be installed with the pavement fabric. Is this leveling course to be installed prior to the placement of the pavement fabric and then the installation of the 1.75" Intermediate Course? If so, what specific asphalt mix is required for the leveling course.

A#2 See response to Q#1.

Q#3 The plans call for 448 Type 2 Med. Surface, please confirm this mix specification.

A#3 Confirmed. Bid Item No. 448 for Asphalt Concrete Surface Course, Type 2 Medium, is the correct type of asphalt surface material to be provided.

Q#4 The pollution liability insurance requirement is very expensive and we have never bid a project with this requirement before. We is prequalified with ODOT and has successfully completed many road and parking lot reconstruction projects. Can this requirement be deleted from the scope of work?

A#4 No. Pollution liability insurance is required for this Project.

Modifications to the Plan Drawings

Deletions in Plan Notes are shown with ~~strikethrough~~ text.

Changes/Additions in the Plan Notes are shown with ***bold italicized*** text.

Additions and deletions on Plan Drawings are indicated with a cloud and revision triangle thus:



Plan Sheet 4 of 5

The Note for "Removal and Replacement of Concrete Median" is deleted as follows:

~~* PAVEMENT FABRIC SHALL BE INSTALLED WITH A 0.5" LEVELING COURSE AND TACK COAT. TACK COATING(S) ARE TO BE APPLIED IN ACCORDANCE WITH THE MANUFACTURER'S SPECIFICATIONS.~~

Receipt of Addendum No. 1 to Contract No. 59-13-05 is hereby acknowledged:

(Firm Name)

(Signature)

(Printed Name)

Date: _____

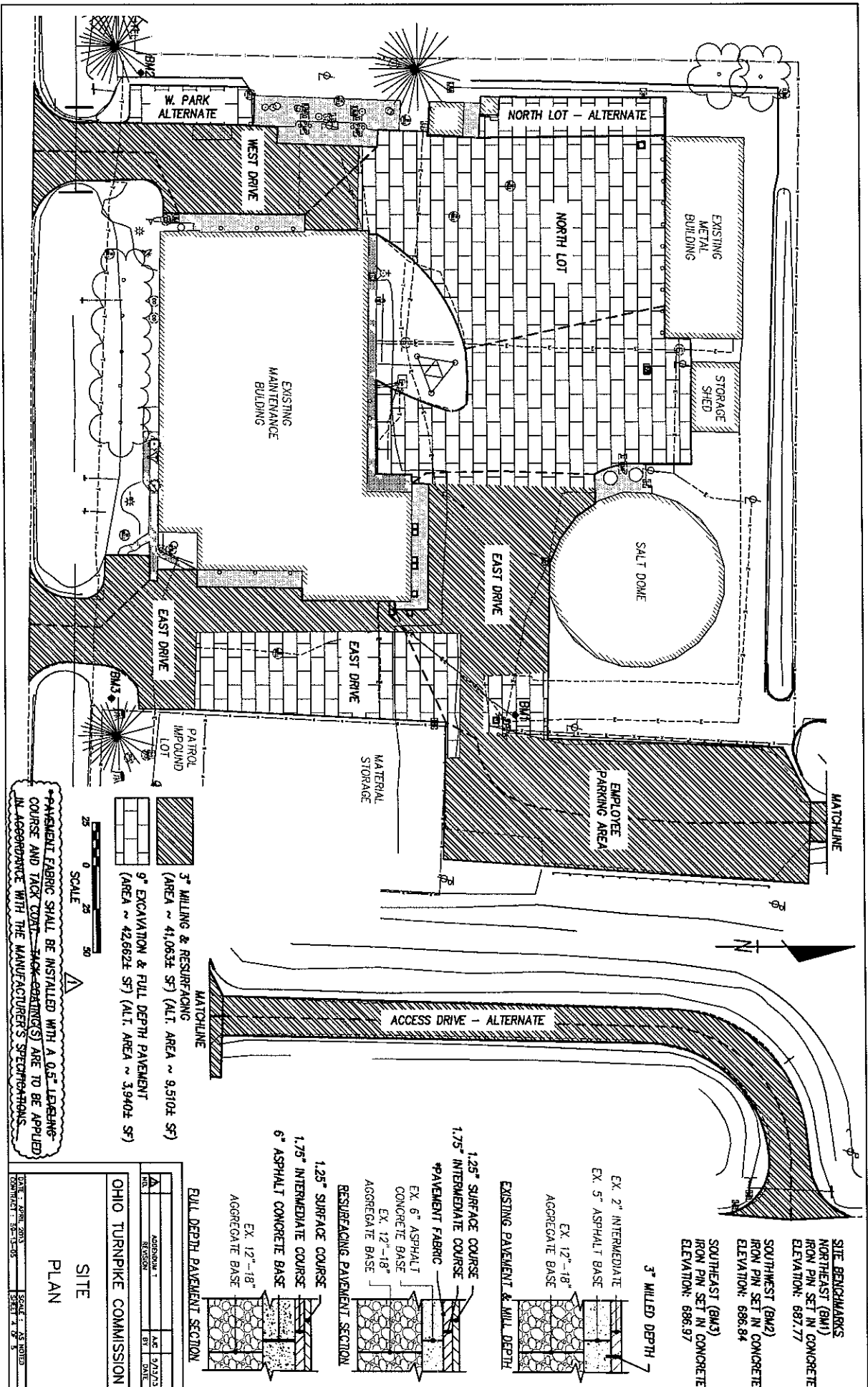

PAVEMENT FABRIC SHALL BE INSTALLED WITH A 0.5" LEAKING COURSE AND TACK COAT. JACK-BEATING(S) ARE TO BE APPLIED IN ACCORDANCE WITH THE MANUFACTURER'S SPECIFICATIONS.



- 3" MILLING & RESURFACING (AREA ~ 41,063± SF) (ALT. AREA ~ 9,510± SF)
- 9" EXCAVATION & FULL DEPTH PAVEMENT (AREA ~ 42,662± SF) (ALT. AREA ~ 3,940± SF)

MATCHLINE

OHIO TURNPIKE COMMISSION

- 1.25" SURFACE COURSE
- 1.75" INTERMEDIATE COURSE
- 6" ASPHALT CONCRETE BASE
- RESURFACING PAVEMENT SECTION
- EXIST. 12"-18" AGGREGATE BASE

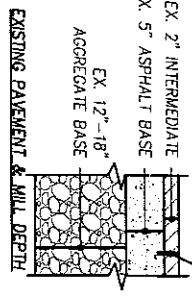
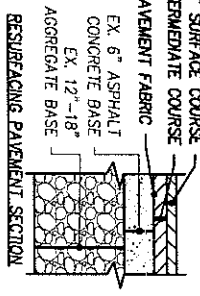

3" MILLED DEPTH

SITE BENCHMARKS
 NORTHEAST (BM1)
 IRON PIN SET IN CONCRETE
 ELEVATION: 687.77
 SOUTHWEST (BM2)
 IRON PIN SET IN CONCRETE
 ELEVATION: 686.84
 SOUTHEAST (BM3)
 IRON PIN SET IN CONCRETE
 ELEVATION: 686.97

NO.	DESCRIPTION	DATE
1	APPROVAL	3/23/73
2	REVISION	BY DATE

SITE PLAN

SCALE: AS NOTED
 SHEET 4 OF 3
 DATE: APR 2015
 DRAWN BY: [unintelligible]