



**OHIO TURNPIKE AND
INFRASTRUCTURE COMMISSION**

ADDENDUM NO. 1
ISSUED JANUARY 10, 2020

PROJECT NO. 39-20-02 (PART A)
MAINLINE PAVEMENT RECONSTRUCTION
MILEPOST 46.50 TO MILEPOST 50.92
FULTON & LUCAS COUNTIES, OHIO
ISSUED DECEMBER 30, 2019

PROJECT NO. 39-20-02 (PART B)
TOLL PLAZA 49 SITE CONSTRUCTION
MILEPOST 48.8 TO MILEPOST 49.1
LUCAS COUNTY, OHIO
ISSUED DECEMBER 30, 2019

OPENING DATE: 2:00 P.M. (EASTERN TIME), JANUARY 27, 2020

ATTENTION OF BIDDERS IS DIRECTED TO:
ANSWERS TO QUESTIONS RECEIVED THROUGH 5:00 PM ON JANUARY 9, 2020

MODIFICATIONS TO THE CONTRACT DOCUMENTS

Plan Sheets: 39-18-02A – 171, 177 and 178 of 505

39-18-02B – 11 of 59

-AND-

Special Provisions: SP103

-AND-

Bid Schedule of Items and Estimated Quantities Worksheet

Ref. Nos. 110 and 264 thru 315 of 315

-AND-

Excavation and Embankment Exhibit (2 Sheets)

Issued by the Ohio Turnpike and Infrastructure Commission through Jennifer L. Stueber, Esq., General Counsel.

Jennifer L. Stueber, Esq.,
General Counsel

1/10/2020
Date

ANSWERS TO QUESTIONS RECEIVED THROUGH 3:00 P.M. ON JANUARY 9, 2020:

Q#1 Are the CAD/design files available to the bidding contractors for this project?

A#1 No, the CAD files will be provide to the successful Bidder.

Q#2 The Estimated Quantities Work Sheet and online Bid Express proposal both have two each bid item #264, please get both revised.

A#2 This Addendum No. 1 removes the duplicated Reference Numbers and renumbers the Reference Numbers from Reference Number 265 through Reference Number 315 on both the Bid Schedule of Items and Estimated Quantities Worksheet.

Q#3 The Estimated Quantities Work Sheet and online Bid Express proposal both have two each bid items #272 and #273, please get both revised.

A#3 See the response to Q#2.

Q#4 Part B plan sheet 16 general summary gives quantities for excavation and embankment based on totals from sheets 7, 27, 28, and 54. The plan sheet 7 volumes are explained and the plan sheet 54 summary can be quantified from cross-sections but there are no sources of quantity for volumes on plan sheets 27 and 28. Please provide calculations for the volumes of excavation and embankment per plan sheets 27 and 28.

A#4 The calculations for excavation and embankment of the north and south sites shown on Plan Sheets 27 and 28 of 59 are from Civil 3D. An "Excavation and Embankment Exhibit" for each site is included with this Addendum No. 1 showing the vertical differences between surfaces using a color code. Each color represents 1 foot increments in excavation or embankment as shown in the legend on exhibit. These two (2) exhibit sheets are for information only!

Q#5 Does the contractor have the option of performing pre-phase 2 ORT slab work simultaneously with the pre-phase 1 ORT slab work?

A#5 Yes. The Contractor may perform the pre-phase 2 ORT slab and median wall / sign foundation work during the pre-phase 1. However, the ORT gantries shall be installed after the Pedestrian Bridge that is part of Project 58-20-01 is set above the Ohio Turnpike mainline lanes and before the Phase 2 work begins. The Pedestrian Bridge is scheduled to be installed during the 2020-21 Winter Shutdown Period as defined in SP 103. Refer to the Contract Coordination Plans located on Plan Sheets 9 thru 13 of 59 for additional Contract Coordination notes. The hatch on Plan Sheet 11 of 59 has been modified in this Addendum No. 1.

Q#6 Please see Plan Sheet 18 of 59 Subsummary, Pavement Calculations. Please review the quantity given for CAD Generated Surface Area for the Eastbound Shoulders/Parking Areas. The area of 36,155 sq ft seems to be overstated.

A#6 The Commission will respond to this question in Addendum No. 2.

Q#7 Bid item 92- Concrete Masonry: subsummary sheet 177 shows the volumes noted by D-35 and D-37. The volume noted by D-37 was found on sheet 398 but we cannot locate where volume noted by D-35 exists. Please provide this missing information.

A#7 The volume noted by D-37 can be found on Drainage Detail Sheet 398 of 505.

Q#8 Please provide a start and end date for the contractor to price bid reference 310 "Field Office" – 1 LS.

A#8 The Project durations are defined in SP 103 and the Field Office Start/End dates are defined in SP 619 A.1.

Q#9 Bid reference 166 "Existing Crossover to be Closed / Re-opened" currently appears as 2 LS. Should this reference be either 1 LS, or 2 EACH?

A#9 Yes, the pay item is Lump Sum and there are 2 Lump Sums required for this Project. The Ohio Turnpike and Infrastructure Commission Standard Drawing TCB-3 defines the requirements and the payment for this work.

Q#10 Bid item 110 - Catch Basin #8: proposal and general summary call these out as #8 catch basins. Plan sheets 207 (D-34) and 208 (D-42) show these as #6 Catch Basins. The attached ODOT standard drawings are for #6 but not #8 Catch Basins. Please review and clarify if these Catch Basins are to be #6 or #8.

A#10 This Addendum No. 1 revises General Summary Sheet No. 171 of 505 and Drainage Sub Summary Sheet Nos. 177 and 178 of 505 to change the Catch Basin No. 8 designation to Catch Basin No. 6.; and revises Reference No. 110 on the Estimated Quantities Worksheet to change the Catch Basin No. 8 designation to Catch Basin No. 6. There is no change in quantity for this item as a result of this Addendum No. 1.

Q#11 Bid item 102- there are two runs on the WB side (sheet 208, runs D-41 and D-42) which are to be core-drill connected to an existing 30" concrete pipe. Given the size of cores needed to accommodate the 15" RCP connections, these will most likely damage or destroy the existing 30" pipe. Please consider adding a new manhole at this junction of the new and existing pipes.

A#11 The Commission will respond to this question in Addendum No. 2.

Q#12 Please identify and indicate the existing pavement type and pavement thickness for Ramps A, B, C, and D at the old service plazas.

A#12 The Commission will respond to this question in Addendum No. 2.

Q#13 Please identify and indicate the existing pavement type and pavement thickness for the 2 drive aprons at the Maintenance Building on the WB side of the Turnpike @ stations 1379 and 1382.

A#13 The Commission will respond to this question in Addendum No. 2.

Q#14 Please verify that the excavation required for the 2 drive aprons at the Maintenance Building on the WB side of the Turnpike @ stations 1379 and 1382 has been accounted for as it appears that 21.25" inches of pavement is to be placed in this area.

A#14 The Commission will respond to this question in Addendum No. 2.

Q#15 Please identify and indicate the existing pavement type and pavement thickness for the drive apron EB side of the Turnpike @ station 1383.

A#15 The Commission will respond to this question in Addendum No. 2.

Q#16 Please verify that the excavation required for the 2 drive aprons at the Maintenance Building on the EB side of the Turnpike @ station 1383 82 has been accounted for as it appears that 21.25" inches of pavement is to be placed in this area.

A#16 The Commission will respond to this question in Addendum No. 2.

Q#17 Please consider delaying the bid 1 day to avoid submitting the bid on a Monday. This will allow additional time for material suppliers and subcontractors to provide quotes to Prime bidders on Monday afternoon and evening as opposed to a Sunday. This will tremendously aid Prime bidders in preparing and submitting their best and lowest bids.

A#17 The Commission will respond to this question in Addendum No. 2.

Q#18 Will the contractor be allowed to utilize the drives at MP 48.36 and 48.41 on the north side of the turnpike, and the drive at MP 48.43 on the south side of the turnpike as a means of ingress and/or egress for construction traffic? If the answer is yes where is this to be factored into the bid? Would this be factored in the base bid, in the temporary access deduct alternate, or a new alternate would be established?

A#18 The Commission will respond to this question in Addendum No. 2.

Q#19 Bid item 17- Removal Misc.: Temporary Sheeting Removed - Plan sheet 397 notes that there are a total of 26 panels of PZC-18 sheeting which are to be removed. Please clarify if the sheets need to be removed full depth and if so, how deep the sheets are.

A#19 The Commission will respond to this question in Addendum No. 2.

Q#20 Has the commission conducted a sub-surface geotechnical investigation on the site? If so, could that be provided to the contractors for review of the sub-surface conditions?

A#20 The Commission will respond to this question in Addendum No. 2.

Q#21 Does the commission provide CADD information to assist the contractors in the bidding process? If so, where could those files be obtained?

A#21 See the response to Q#1.

Q#22 Will the commission allow the contractor to place and utilize a Portable Asphalt Batch plant within the Commission Right-of Way. If so, please provide the location.

A#22 Yes, the requirements and the location will be provided in Addendum No. 2.

Q#23 Is the use of an MTD (Material Transfer Device) required for paving the lanes into & out of the toll plaza (PART B ONLY, Sta 118+70 to 133+70)?

A#23 The Commission will respond to this question in Addendum No. 2.

Q#24 SP103, Paragraph F states that all westbound asphalt paving shall be complete by 10/16/20. Does this exclude the asphalt paving within 39-20-02B Westbound Toll Plaza with the exception of the Pedestrian Bridge Staging Area, Laydown Areas, Parking Areas and Drives as depicted on Plan Sheet 9 of 59?

A#24 The Commission will respond to this question in Addendum No. 2.

Q#25 SP400.III.E.3.(h) states that the SP404 shall be placed either full width or in 2 parallel lanes. Please describe how you would like the SP404 to be placed in the areas into & out of the toll booths where the pavement is up to 92' wide.

A#25 The Commission will respond to this question in Addendum No. 2.

Receipt of Addendum No. 1

Project No. 39-20-02 (Part A & B) is hereby acknowledged:

(Firm Name) _____

(Signature) _____

(Printed Name) _____

(Date) _____

**BIDDERS MUST RETURN THE ABOVE ACKNOWLEDGEMENT
OF RECEIPT OF ADDENDUM NO. 1 WITH THEIR BID.**

H:\2018\180192\DWG\SHEETS-5 MILES.C - GENERAL SUMMARY-5 MILES.DWG - 3 - 1/9/2020 8:06:46 AM - KEVIN ABRAMS

SHEET NUMBER																ITEM	GRAND TOTAL	UNIT	DESCRIPTION	SEE SHEET NO.
23	24	178	179	181	183	396	397	PIS-1												
																			DRAINAGE	
		3.4														602	3.4	CY	CONCRETE MASONRY	
			42,536													SP 605	42,536	FT	6" BASE PIPE UNDERDRAIN, WITH FABRIC WRAP (18")	
			1,707													SP 605	1,707	FT	6" SHALLOW PIPE UNDERDRAIN, WITH FABRIC WRAP (24")	
			48,269													SP 605	48,269	FT	6" SHALLOW PIPE UNDERDRAIN, WITH FABRIC WRAP (30")	
			2,425													SP 605	2,425	FT	6" UNDERDRAIN OUTLET PIPE	
200																SP 605	200	FT	AGGREGATE DRAIN, TYPE 1, WITH FABRIC WRAP	
200																SP 605	200	FT	AGGREGATE DRAIN, TYPE 2, WITH FABRIC WRAP	
								255								SP 611	255	FT	4" CONDUIT, TYPE E, 707.31 (TYPE CP)	
								120								SP 611	120	FT	4" CONDUIT, TYPE F, 707.33	
		1,112														SP 611	1,112	FT	12" CONDUIT, TYPE F, 707.33	
		523														SP 611	523	FT	15" CONDUIT, TYPE B, 706.02	
		80														SP 611	80	FT	18" CONDUIT, TYPE B, 706.02	
		126														SP 611	126	FT	24" CONDUIT, TYPE B, 706.02	
		200														SP 611	200	FT	30" CONDUIT, TYPE B, 706.02	
							136									SP 611	136	FT	48" CONDUIT, TYPE A, 706.02, AS PER PLAN	22
			75					6								SP 611	81	EACH	PRECAST REINFORCED CONCRETE OUTLET	
		7														SP 611	7	EACH	CATCH BASIN, NO. CB-1	22
		17														SP 611	17	EACH	CATCH BASIN, NO. CB-1, AS PER PLAN	22
		2														SP 611	2	EACH	CATCH BASIN, NO. 6	22
		1														SP 611	1	EACH	CATCH BASIN, AS PER PLAN	22
		4														SP 611	4	EACH	INLET, NO. I-3C (ODOT)	
		2														SP 611	2	EACH	WATER QUALITY BASIN	
		1														SP 611	1	EACH	MANHOLE, NO. 3	
		25														SPECIAL	25	EACH	12" PRECAST CONCRETE END SECTION	22
		18														SPECIAL	18	EACH	15" PRECAST CONCRETE END SECTION	22
		8														SPECIAL	8	EACH	18" PRECAST CONCRETE END SECTION	22
		3														SPECIAL	3	EACH	30" PRECAST CONCRETE END SECTION	22
							2									SPECIAL	2	EACH	48" PRECAST CONCRETE END SECTION	22
																			PAVEMENT	
	1,000			45,932		468										252	47,400	FT	FULL DEPTH PAVEMENT SAWING	
	670															254	670	SY	PAVEMENT PLANING, ASPHALT CONCRETE (VARIABLE DEPTH)	
				9,975	364											SP 302	10,339	CY	ASPHALT CONCRETE BASE, PG64-22 (SHOULDER)	
				46,100												SP 302	46,100	CY	ASPHALT CONCRETE BASE, PG64-22	
				12,460	4,453											SP 304	16,913	CY	AGGREGATE BASE (SHOULDER)	
				23,883		126										SP 304	24,009	CY	AGGREGATE BASE	
					2,439											SP 304	2,439	CY	AGGREGATE BASE (VARIABLE THICKNESS)	
				2,797	14											SP 402	2,811	CY	ASPHALT CONCRETE INTERMEDIATE COURSE OR RECYCLED ASPHALT CONCRETE INTERMEDIATE COURSE, PG64-22	
				6,064												SP 402	6,064	CY	ASPHALT CONCRETE INTERMEDIATE COURSE OR RECYCLED ASPHALT CONCRETE INTERMEDIATE COURSE, PG76-22 (FR)	
	6			2,403	12											SP 404	2,421	CY	ASPHALT CONCRETE SURFACE COURSE, USING CRUSHED STONE, PG64-22	
	16			5,201												SP 404	5,217	CY	ASPHALT CONCRETE SURFACE COURSE, USING CRUSHED SLAG, PG76-22 (FR)	
				112,944												SP 404A	112,944	FT	JOINT SEALER	
	40			36,217	313											407	36,570	GAL	NON -TRACKING TACK COAT	
						752										452	752	SY	15-1/4" NON-REINFORCED PORTLAND CEMENT CONCRETE PAVEMENT, CLASS QC 1, AS PER PLAN	24
					356											SP 627	356	CY	STONE SHOULDER PROTECTION	
				18.35												SPECIAL	18.35	MILE	SONIC NAP ALERT PATTERN	

<div><div>171</div><div>505</div></div>		3 / 4		PROJECT 39-20-02A		GENERAL SUMMARY																																																																																																																																																																																																																																																																																																																																																																																																																																																																																																																																																																																																																																																																																																																																																																																																																																																																																																																																																																																																																																																																																																																																																																																																																					
---	--	-------	--	-------------------	--	-----------------	--	--	--	--	--	--	--	--	--	--	--	--	--	--	--	--	--	--	--	--	--	--	--	--	--	--	--	--	--	--	--	--	--	--	--	--	--	--	--	--	--	--	--	--	--	--	--	--	--	--	--	--	--	--	--	--	--	--	--	--	--	--	--	--	--	--	--	--	--	--	--	--	--	--	--	--	--	--	--	--	--	--	--	--	--	--	--	--	--	--	--	--	--	--	--	--	--	--	--	--	--	--	--	--	--	--	--	--	--	--	--	--	--	--	--	--	--	--	--	--	--	--	--	--	--	--	--	--	--	--	--	--	--	--	--	--	--	--	--	--	--	--	--	--	--	--	--	--	--	--	--	--	--	--	--	--	--	--	--	--	--	--	--	--	--	--	--	--	--	--	--	--	--	--	--	--	--	--	--	--	--	--	--	--	--	--	--	--	--	--	--	--	--	--	--	--	--	--	--	--	--	--	--	--	--	--	--	--	--	--	--	--	--	--	--	--	--	--	--	--	--	--	--	--	--	--	--	--	--	--	--	--	--	--	--	--	--	--	--	--	--	--	--	--	--	--	--	--	--	--	--	--	--	--	--	--	--	--	--	--	--	--	--	--	--	--	--	--	--	--	--	--	--	--	--	--	--	--	--	--	--	--	--	--	--	--	--	--	--	--	--	--	--	--	--	--	--	--	--	--	--	--	--	--	--	--	--	--	--	--	--	--	--	--	--	--	--	--	--	--	--	--	--	--	--	--	--	--	--	--	--	--	--	--	--	--	--	--	--	--	--	--	--	--	--	--	--	--	--	--	--	--	--	--	--	--	--	--	--	--	--	--	--	--	--	--	--	--	--	--	--	--	--	--	--	--	--	--	--	--	--	--	--	--	--	--	--	--	--	--	--	--	--	--	--	--	--	--	--	--	--	--	--	--	--	--	--	--	--	--	--	--	--	--	--	--	--	--	--	--	--	--	--	--	--	--	--	--	--	--	--	--	--	--	--	--	--	--	--	--	--	--	--	--	--	--	--	--	--	--	--	--	--	--	--	--	--	--	--	--	--	--	--	--	--	--	--	--	--	--	--	--	--	--	--	--	--	--	--	--	--	--	--	--	--	--	--	--	--	--	--	--	--	--	--	--	--	--	--	--	--	--	--	--	--	--	--	--	--	--	--	--	--	--	--	--	--	--	--	--	--	--	--	--	--	--	--	--	--	--	--	--	--	--	--	--	--	--	--	--	--	--	--	--	--	--	--	--	--	--	--	--	--	--	--	--	--	--	--	--	--	--	--	--	--	--	--	--	--	--	--	--	--	--	--	--	--	--	--	--	--	--	--	--	--	--	--	--	--	--	--	--	--	--	--	--	--	--	--	--	--	--	--	--	--	--	--	--	--	--	--	--	--	--	--	--	--	--	--	--	--	--	--	--	--	--	--	--	--	--	--	--	--	--	--	--	--	--	--	--	--	--	--	--	--	--	--	--	--	--	--	--	--	--	--	--	--	--	--	--	--	--	--	--	--	--	--	--	--	--	--	--	--	--	--	--	--	--	--	--	--	--	--	--	--	--	--	--	--	--	--	--	--	--	--	--	--	--	--	--	--	--	--	--	--	--	--	--	--	--	--	--	--	--	--	--	--	--	--	--	--	--	--	--	--	--	--	--	--	--	--	--	--	--	--	--	--	--	--	--	--	--	--	--	--	--	--	--	--	--	--	--	--	--	--	--	--	--	--	--	--	--	--	--	--	--	--	--	--	--	--	--	--	--	--	--	--	--	--	--	--	--	--	--	--	--	--	--	--	--	--	--	--	--	--	--	--	--	--	--	--	--	--	--	--	--	--	--	--	--	--	--	--	--	--	--	--	--	--	--	--	--	--	--	--	--	--	--	--	--	--	--	--	--	--	--	--	--	--	--	--	--	--	--	--	--	--	--	--	--	--	--	--	--	--	--	--	--	--	--	--	--	--	--	--	--	--	--	--	--	--	--	--	--	--	--	--	--	--	--	--	--	--	--	--	--	--	--	--	--	--	--	--	--	--	--	--	--	--	--	--	--	--	--	--	--	--	--	--	--	--	--	--	--	--	--	--	--	--	--	--	--	--	--	--	--	--	--	--	--	--	--	--	--	--	--	--	--	--	--	--	--	--	--	--	--	--	--	--	--	--	--	--	--	--	--	--	--	--	--	--	--	--	--	--	--	--	--	--	--	--	--	--	--	--	--	--	--	--	--	--	--	--	--	--	--	--	--	--	--	--	--	--	--	--	--	--	--	--	--	--	--	--	--	--	--	--	--	--	--	--	--	--	--	--	--	--	--	--	--	--	--	--	--	--	--	--	--	--	--	--	--	--	--	--	--	--	--	--	--	--	--	--	--	--	--	--	--	--	--	--	--	--	--	--	--	--	--	--	--	--	--	--	--	--	--	--	--	--	--	--	--	--	--	--	--	--	--	--	--	--	--	--	--	--	--	--	--	--	--	--	--	--	--	--	--	--	--	--	--	--	--	--	--	--	--	--	--	--	--	--	--	--	--	--	--	--	--	--	--	--	--	--	--	--	--	--	--	--	--	--	--	--	--	--	--	--	--	--	--	--	--	--	--	--	--	--	--	--	--	--	--	--	--	--	--	--	--	--	--	--	--	--	--	--	--	--	--	--	--	--	--	--

H:\2018\180192\DWG\SHEETS-5 MILES.C - ROADWAY SUBSUMMARY-5 MILES.DWG - DR-1 - 19/2020 8:05:31 AM - KEVIN ABRAMS

REF NO.	SHEET NO.	STATION TO STATION		SIDE	202	202	202	202	202	SPECIAL	SPECIAL		601	602	SP 611	SP 611	SP 611	SP 611	SP 611	SP 611	SP 611	SP 611	SP 611	SP 611	SP 611		SPECIAL	SPECIAL	SPECIAL	SPECIAL	
					HEADWALL REMOVED	PIPE REMOVED, 24" AND UNDER	PIPE REMOVED, OVER 24"	CATCH BASIN OR INLET REMOVED	REMOVAL MISC.: STEEL PLATE REMOVED	PIPE CLEANOUT, 24" AND UNDER	PIPE CLEANOUT, 27" TO 48"		ROCK CHANNEL PROTECTION, TYPE C WITH FILTER	CONCRETE MASONRY	12" CONDUIT, TYPE F, 707.33	15" CONDUIT, TYPE B, 706.02	18" CONDUIT, TYPE B, 706.02	24" CONDUIT, TYPE B, 706.02	30" CONDUIT, TYPE B, 706.02	CATCH BASIN, NO. CB-1	CATCH BASIN, NO. CB-1, AS PER PLAN	<div>CATCH BASIN, NO. 6</div>	INLET, NO. I-3C (ODOT)	WATER QUALITY BASIN	CATCH BASIN, AS PER PLAN	MANHOLE, NO. 3		12" PRECAST CONCRETE END SECTION	15" PRECAST CONCRETE END SECTION	18" PRECAST CONCRETE END SECTION	30" PRECAST CONCRETE END SECTION
D-1	195	1263+98.8		R	EACH	FT	FT	EACH	EACH	FT	FT		CY	CY	FT	FT	FT	FT	FT	EACH	EACH	EACH	EACH	EACH	EACH		EACH	EACH	EACH	EACH	
D-2	195	1268+99.3		R		34		1	1							4								1							
D-3	196	1277+83.0	1279+07.0	L							124																				
D-4	196	1277+78.0	1279+02.0	R						124																					
D-5	196	1281+90.0		R	1	12							1.33			8												1			
D-6	197	1287+60.0		R	1	8							1.33			8												1			
D-7	197	1293+19.0		R	1	8							1.33			8												1			
D-8	198	1303+19.0		R	1	12							1.33			8												1			
D-9	199	1313+18.0		R	1	8							1.33				8												1		
D-10	199	1321+03.0		R	1	9							1.33				8												1		
D-11	200	1324+00.0		R	1	14							1.33			8												1			
D-12	200	1324+10.0		L	1	41		1					1.33	36					1							1					
D-13	200	1326+08.0		L	1	56		1					1.33	48					1							1					
D-14	200	1326+08.0		R	1	43		1					1.33	38					1							1					
D-15	200	1328+54.0		R	1	80		1					1.33	46					1							1					
D-16	201	1346+90.0		R	1	52		1					1.33	46					1							1					
D-17	201	1346+98.0		L	1	40		1					1.33	34					1							1					
D-18	202	1348+89.0		L	1	46		1					1.33	40					1							1					
D-19	202	1352+02.0		R	1	14							1.33			8												1			
D-20	202	1357+42.0		R	1	12							1.33			8												1			
D-21	203	1364+00.0		R	1	12							1.33			8												1			
D-22	203	1370+59.0		R	1	9							1.33			8												1			
D-23	204	1377+17.0		R	1	9							1.33			8												1			
D-24	204	1378+91.0	1379+41.0	L							50																				
D-25	204	1381+55.0	1382+29.0	L							74																				
D-26	204	1382+61.0	1383+11.0	R							50																				
D-27	205	1383+54.0	0+92.0	L							124																				
D-28	205	1383+56.0	0+90.0	R	1		8				120								4											1	
D-29	205	6+50.0	6+50.0	R	1	8																									
D-30	207	25+85.0		R												36							1								
D-31	207	25+74.1	26+40.6	L/R	1	124																									
D-32	207	27+00.0		L												18															
D-33	207	33+45.0		R									1.33			82							1				1				
D-34	207	33+45.0	34+50.0	R												105						1									
D-35	207	34+91.0	35+00.9	R			4	1						1.64					68					1							
D-36	207	31+94.0		L									3.33						24											1	
D-37	207	34+13.6	35+34.5	L										1.70				126						1							
D-38	208	35+26.9	35+36.5	L	1		4												60												
D-39	208	35+36.5	35+81.4	L									3.33						44												
D-40	208	35+26.9	35+81.4	L	1		99	1																	1						1
D-41	208	35+00.0	35+23.5	L												24							1								
D-42	208	35+23.5	36+50.0	L												126						1									
D-43	209	57+87.0		R		10							1.33			8												1			
D-44	210	68+29.0		R		9							1.33				8												1		
D-45	211	75+21.0		L		8							1.33			8												1			
D-46	211	78+64.0		L		8							1.33				8												1		
D-47	212	85+47.5		L		8							1.33				8												1		
D-48	212	92+29.0		L		24							1.33			24													1		
D-49	213	99+11.0		L		8							1.33			8													1		
D-50	213	103+80.3	104+99.5	L							120		1.33																		
D-51	213	105+93.0		R		8							1.33				8													1	
D-52	214	112+74.5		R		8							1.33			8												1			
D-53	215	120+25.0		L		8							1.33			8												1			
D-54	215	126+95.0		R		11							1.33			8												1			
									</																						

DESIGN AGENCY				BY	DATE	REVISIONS		NO.		CHECKED		DESIGNED		DRAINAGE SUB SUMMARY				PROJECT 39-20-02A		5 / 11		177 / 505	
				JMP	10/2022	ADDENDUM NO. 1		1		W.D.B.		J.M.P.											
										IN CHARGE		DRAWN						DATE: 12/3/19					
										W.D.B.		K.P.A.											

H:\2018\180192\DWG\SHEETS-5 MILES.C - ROADWAY SUBSUMMARY-5 MILES.DWG - DR-2 - 18/2020 8:06:26 AM - KEVIN ABRAMS

REF NO.	SHEET NO.	STATION TO STATION		SIDE	202	202	202	202	202	SPECIAL	SPECIAL		601	602	SP 611	SP 611	SP 611	SP 611	SP 611	SP 611	SP 611	SP 611	SP 611	SP 611	SP 611	SP 611	SP 611	SP 611	SP 611	SP 611	SP 611	SP 611	SP 611	SP 611	SP 611	SP 611	SP 611	SP 611	SP 611	SP 611	SP 611	SP 611	SP 611	SP 611	SP 611	SP 611	SP 611	SP 611	SP 611	SP 611	SP 611	SP 611	SP 611	SP 611	SP 611	SP 611	SP 611	SP 611	SP 611	SP 611	SP 611	SP 611	SP 611	SP 611	SP 611	SP 611	SP 611	SP 611	SP 611	SP 611	SP 611	SP 611	SP 611	SP 611	SP 611	SP 611	SP 611	SP 611	SP 611	SP 611	SP 611	SP 611	SP 611	SP 611	SP 611	SP 611	SP 611	SP 611	SP 611	SP 611	SP 611	SP 611	SP 611	SP 611	SP 611	SP 611	SP 611	SP 611	SP 611	SP 611	SP 611	SP 611	SP 611	SP 611	SP 611	SP 611	SP 611	SP 611	SP 611	SP 611	SP 611	SP 611	SP 611	SP 611	SP 611	SP 611	SP 611	SP 611	SP 611	SP 611	SP 611	SP 611	SP 611	SP 611	SP 611	SP 611	SP 611	SP 611	SP 611	SP 611	SP 611	SP 611	SP 611	SP 611	SP 611	SP 611	SP 611	SP 611	SP 611	SP 611	SP 611	SP 611	SP 611	SP 611	SP 611	SP 611	SP 611	SP 611	SP 611	SP 611	SP 611	SP 611	SP 611	SP 611	SP 611	SP 611	SP 611	SP 611	SP 611	SP 611	SP 611	SP 611	SP 611	SP 611	SP 611	SP 611	SP 611	SP 611	SP 611	SP 611	SP 611	SP 611	SP 611	SP 611	SP 611	SP 611	SP 611	SP 611	SP 611	SP 611	SP 611	SP 611	SP 611	SP 611	SP 611	SP 611	SP 611	SP 611	SP 611	SP 611	SP 611	SP 611	SP 611	SP 611	SP 611	SP 611	SP 611	SP 611	SP 611	SP 611	SP 611	SP 611	SP 611	SP 611	SP 611	SP 611	SP 611	SP 611	SP 611	SP 611	SP 611	SP 611	SP 611	SP 611	SP 611	SP 611	SP 611	SP 611	SP 611	SP 611	SP 611	SP 611	SP 611	SP 611	SP 611	SP 611	SP 611	SP 611	SP 611	SP 611	SP 611	SP 611	SP 611	SP 611	SP 611	SP 611	SP 611	SP 611	SP 611	SP 611	SP 611	SP 611	SP 611	SP 611	SP 611	SP 611	SP 611	SP 611	SP 611	SP 611	SP 611	SP 611	SP 611	SP 611	SP 611	SP 611	SP 611	SP 611	SP 611	SP 611	SP 611	SP 611	SP 611	SP 611	SP 611	SP 611	SP 611	SP 611	SP 611	SP 611	SP 611	SP 611	SP 611	SP 611	SP 611	SP 611	SP 611	SP 611	SP 611	SP 611	SP 611	SP 611	SP 611	SP 611	SP 611	SP 611	SP 611	SP 611	SP 611	SP 611	SP 611	SP 611	SP 611	SP 611	SP 611	SP 611	SP 611	SP 611	SP 611	SP 611	SP 611	SP 611	SP 611	SP 611	SP 611	SP 611	SP 611	SP 611	SP 611	SP 611	SP 611	SP 611	SP 611	SP 611	SP 611	SP 611	SP 611	SP 611	SP 611	SP 611	SP 611	SP 611	SP 611	SP 611	SP 611	SP 611	SP 611	SP 611	SP 611	SP 611	SP 611	SP 611	SP 611	SP 611	SP 611	SP 611	SP 611	SP 611	SP 611	SP 611	SP 611	SP 611	SP 611	SP 611	SP 611	SP 611	SP 611	SP 611	SP 611	SP 611	SP 611	SP 611	SP 611	SP 611	SP 611	SP 611	SP 611	SP 611	SP 611	SP 611	SP 611	SP 611	SP 611	SP 611	SP 611	SP 611	SP 611	SP 611	SP 611	SP 611	SP 611	SP 611	SP 611	SP 611	SP 611	SP 611	SP 611	SP 611	SP 611	SP 611	SP 611	SP 611	SP 611	SP 611	SP 611	SP 611	SP 611	SP 611	SP 611	SP 611	SP 611	SP 611	SP 611	SP 611	SP 611	SP 611	SP 611	SP 611	SP 611	SP 611	SP 611	SP 611	SP 611	SP 611	SP 611	SP 611	SP 611	SP 611	SP 611	SP 611	SP 611	SP 611	SP 611	SP 611	SP 611	SP 611	SP 611	SP 611	SP 611	SP 611	SP 611	SP 611	SP 611	SP 611	SP 611	SP 611	SP 611	SP 611	SP 611	SP 611	SP 611	SP 611	SP 611	SP 611	SP 611	SP 611	SP 611	SP 611	SP 611	SP 611	SP 611	SP 611	SP 611	SP 611	SP 611	SP 611	SP 611	SP 611	SP 611	SP 611	SP 611	SP 611	SP 611	SP 611	SP 611	SP 611	SP 611	SP 611	SP 611	SP 611	SP 611	SP 611	SP 611	SP 611	SP 611	SP 611	SP 611	SP 611	SP 611	SP 611	SP 611	SP 611	SP 611	SP 611	SP 611	SP 611	SP 611	SP 611	SP 611	SP 611	SP 611	SP 611	SP 611	SP 611	SP 611	SP 611	SP 611	SP 611	SP 611	SP 611	SP 611	SP 611	SP 611	SP 611	SP 611	SP 611	SP 611	SP 611	SP 611	SP 611	SP 611	SP 611	SP 611	SP 611	SP 611	SP 611	SP 611	SP 611	SP 611	SP 611	SP 611	SP 611	SP 611	SP 611	SP 611	SP 611	SP 611	SP 611	SP 611	SP 611	SP 611	SP 611	SP 611	SP 611	SP 611	SP 611	SP 611	SP 611	SP 611	SP 611	SP 611	SP 611	SP 611	SP 611	SP 611	SP 611	SP 611	SP 611	SP 611	SP 611	SP 611	SP 611	SP 611	SP 611	SP 611	SP 611	SP 611	SP 611	SP 611	SP 611	SP 611	SP 611	SP 611	SP 611	SP 611	SP 611	SP 611	SP 611	SP 611	SP 611	SP 611	SP 611	SP 611	SP 611	SP 611	SP 611	SP 611	SP 611	SP 611	SP 611	SP 611	SP 611	SP 611	SP 611	SP 611	SP 611	SP 611	SP 611	SP 611	SP 611	SP 611	SP 611	SP 611	SP 611	SP 611	SP 611	SP 611	SP 611	SP 611	SP 611	SP 611	SP 611	SP 611	SP 611	SP 611	SP 611	SP 611	SP 611	SP 611	SP 611	SP 611	SP 611	SP 611	SP 611	SP 611	SP 611	SP 611	SP 611	SP 611	SP 611	SP 611	SP 611	SP 611	SP 611	SP 611	SP 611	SP 611	SP 611	SP 611	SP 611	SP 611	SP 611	SP 611	SP 611	SP 611	SP 611	SP 611	SP 611	SP 611	SP 611	SP 611	SP 611	SP 611	SP 611	SP 611	SP 611	SP 611	SP 611	SP 611	SP 611	SP 611	SP 611	SP 611	SP 611	SP 611	SP 611	SP 611	SP 611	SP 611	SP 611	SP 611	SP 611	SP 611	SP 611	SP 611	SP 611	SP 611	SP 611	SP 611	SP 611	SP 611	SP 611	SP 611	SP 611	SP 611	SP 611	SP 611	SP 611	SP 611	SP 611	SP 611	SP 611	SP 611	SP 611	SP 611	SP 611	SP 611	SP 611	SP 611	SP 611	SP 611	SP 611	SP 611	SP 611	SP 611	SP 611	SP 611	SP 611	SP 611	SP 611	SP 611	SP 611	SP 611	SP 611	SP 611	SP 611	SP 611	SP 611	SP 611	SP 611	SP 611	SP 611	SP 611	SP 611	SP 611	SP 611	SP 611	SP 611	SP 611	SP 611	SP 611	SP 611	SP 611	SP 611	SP 611	SP 611	SP 611	SP 611	SP 611	SP 611	SP 611	SP 611	SP 611	SP 611	SP 611	SP 611	SP 611	SP 611	SP 611	SP 611	SP 611	SP 611	SP 611	SP 611	SP 611	SP 611	SP 611	SP 611	SP 611	SP 611	SP 611	SP 611	SP 611	SP 611	SP 611	SP 611	SP 611	SP 611	SP 611	SP 611	SP 611	SP 611	SP 611	SP 611	SP 611	SP 611	SP 611	SP 611	SP 611	SP 611	SP 611	SP 611	SP 611	SP 611	SP 611	SP 611	SP 611	SP 611	SP 611	SP 611	SP 611	SP 611	SP 611	SP 611	SP 611	SP 611	SP 611	SP 611	SP 611	SP 611	SP 611	SP 611	SP 611	SP 611	SP 611	SP 611	SP 611	SP 611	SP 611	SP 611	SP 611	SP 611	SP 611	SP 611	SP 611	SP 611	SP 611	SP 611	SP 611	SP 611	SP 611	SP 611	SP 611	SP 611	SP 611	SP 611	SP 611	SP 611	SP 611	SP 611	SP 611	SP 611	SP 611	SP 611	SP 611	SP 611	SP 611	SP 611	SP 611	SP 611	SP 611	SP 611	SP 611	SP 611	SP 611	SP 611	SP 611	SP 611	SP 611	SP 611	SP 611	
---------	-----------	--------------------	--	------	-----	-----	-----	-----	-----	---------	---------	--	-----	-----	--------	--------	--------	--------	--------	--------	--------	--------	--------	--------	--------	--------	--------	--------	--------	--------	--------	--------	--------	--------	--------	--------	--------	--------	--------	--------	--------	--------	--------	--------	--------	--------	--------	--------	--------	--------	--------	--------	--------	--------	--------	--------	--------	--------	--------	--------	--------	--------	--------	--------	--------	--------	--------	--------	--------	--------	--------	--------	--------	--------	--------	--------	--------	--------	--------	--------	--------	--------	--------	--------	--------	--------	--------	--------	--------	--------	--------	--------	--------	--------	--------	--------	--------	--------	--------	--------	--------	--------	--------	--------	--------	--------	--------	--------	--------	--------	--------	--------	--------	--------	--------	--------	--------	--------	--------	--------	--------	--------	--------	--------	--------	--------	--------	--------	--------	--------	--------	--------	--------	--------	--------	--------	--------	--------	--------	--------	--------	--------	--------	--------	--------	--------	--------	--------	--------	--------	--------	--------	--------	--------	--------	--------	--------	--------	--------	--------	--------	--------	--------	--------	--------	--------	--------	--------	--------	--------	--------	--------	--------	--------	--------	--------	--------	--------	--------	--------	--------	--------	--------	--------	--------	--------	--------	--------	--------	--------	--------	--------	--------	--------	--------	--------	--------	--------	--------	--------	--------	--------	--------	--------	--------	--------	--------	--------	--------	--------	--------	--------	--------	--------	--------	--------	--------	--------	--------	--------	--------	--------	--------	--------	--------	--------	--------	--------	--------	--------	--------	--------	--------	--------	--------	--------	--------	--------	--------	--------	--------	--------	--------	--------	--------	--------	--------	--------	--------	--------	--------	--------	--------	--------	--------	--------	--------	--------	--------	--------	--------	--------	--------	--------	--------	--------	--------	--------	--------	--------	--------	--------	--------	--------	--------	--------	--------	--------	--------	--------	--------	--------	--------	--------	--------	--------	--------	--------	--------	--------	--------	--------	--------	--------	--------	--------	--------	--------	--------	--------	--------	--------	--------	--------	--------	--------	--------	--------	--------	--------	--------	--------	--------	--------	--------	--------	--------	--------	--------	--------	--------	--------	--------	--------	--------	--------	--------	--------	--------	--------	--------	--------	--------	--------	--------	--------	--------	--------	--------	--------	--------	--------	--------	--------	--------	--------	--------	--------	--------	--------	--------	--------	--------	--------	--------	--------	--------	--------	--------	--------	--------	--------	--------	--------	--------	--------	--------	--------	--------	--------	--------	--------	--------	--------	--------	--------	--------	--------	--------	--------	--------	--------	--------	--------	--------	--------	--------	--------	--------	--------	--------	--------	--------	--------	--------	--------	--------	--------	--------	--------	--------	--------	--------	--------	--------	--------	--------	--------	--------	--------	--------	--------	--------	--------	--------	--------	--------	--------	--------	--------	--------	--------	--------	--------	--------	--------	--------	--------	--------	--------	--------	--------	--------	--------	--------	--------	--------	--------	--------	--------	--------	--------	--------	--------	--------	--------	--------	--------	--------	--------	--------	--------	--------	--------	--------	--------	--------	--------	--------	--------	--------	--------	--------	--------	--------	--------	--------	--------	--------	--------	--------	--------	--------	--------	--------	--------	--------	--------	--------	--------	--------	--------	--------	--------	--------	--------	--------	--------	--------	--------	--------	--------	--------	--------	--------	--------	--------	--------	--------	--------	--------	--------	--------	--------	--------	--------	--------	--------	--------	--------	--------	--------	--------	--------	--------	--------	--------	--------	--------	--------	--------	--------	--------	--------	--------	--------	--------	--------	--------	--------	--------	--------	--------	--------	--------	--------	--------	--------	--------	--------	--------	--------	--------	--------	--------	--------	--------	--------	--------	--------	--------	--------	--------	--------	--------	--------	--------	--------	--------	--------	--------	--------	--------	--------	--------	--------	--------	--------	--------	--------	--------	--------	--------	--------	--------	--------	--------	--------	--------	--------	--------	--------	--------	--------	--------	--------	--------	--------	--------	--------	--------	--------	--------	--------	--------	--------	--------	--------	--------	--------	--------	--------	--------	--------	--------	--------	--------	--------	--------	--------	--------	--------	--------	--------	--------	--------	--------	--------	--------	--------	--------	--------	--------	--------	--------	--------	--------	--------	--------	--------	--------	--------	--------	--------	--------	--------	--------	--------	--------	--------	--------	--------	--------	--------	--------	--------	--------	--------	--------	--------	--------	--------	--------	--------	--------	--------	--------	--------	--------	--------	--------	--------	--------	--------	--------	--------	--------	--------	--------	--------	--------	--------	--------	--------	--------	--------	--------	--------	--------	--------	--------	--------	--------	--------	--------	--------	--------	--------	--------	--------	--------	--------	--------	--------	--------	--------	--------	--------	--------	--------	--------	--------	--------	--------	--------	--------	--------	--------	--------	--------	--------	--------	--------	--------	--------	--------	--------	--------	--------	--------	--------	--------	--------	--------	--------	--------	--------	--------	--------	--------	--------	--------	--------	--------	--------	--------	--------	--------	--------	--------	--------	--------	--------	--------	--------	--------	--------	--------	--------	--------	--------	--------	--------	--------	--------	--------	--------	--------	--------	--------	--------	--------	--------	--------	--------	--------	--------	--------	--------	--------	--------	--------	--------	--------	--------	--------	--------	--------	--------	--------	--------	--------	--------	--------	--------	--------	--------	--------	--------	--------	--------	--------	--------	--------	--------	--------	--------	--------	--------	--------	--------	--------	--------	--------	--------	--------	--------	--------	--------	--------	--------	--------	--------	--------	--------	--------	--------	--------	--------	--------	--------	--------	--------	--------	--------	--------	--------	--------	--------	--------	--------	--

DESIGN AGENCY				BY	DATE
				JMP	10/2022
REVISIONS				ADDENDUM NO. 1	
NO.				1	
CHECKED				W.D.B.	
DESIGNED				J.M.P.	
IN CHARGE				K.P.A.	
DRAWN					
PROJECT 39-20-02A				DATE: 12/3/19	
DRAINAGE SUB SUMMARY				6	11
178				505	

CHECKING PRINT

CHECKED: DATE: CORRECTED: DATE:

BACKCHECKED: DATE: APPROVED: DATE:

nnmmGY003.dwg: 1/09/20 - 10:24am

ORT GANTRY TRUSS

- TCS INTEGRATOR - TOLLING EQUIPMENT SHALL BE PROVIDED AND INSTALLED BY TCS INTEGRATOR.
- CONTRACT 39-20-02A - TRUSS FOUNDATIONS, MEDIAN BARRIER, PULL BOXES, CONDUIT STUB UPS FROM FOUNDATION TO TRUSS TOWER BOTTOM, AND TRUSS ARE TO BE PROVIDED AND INSTALLED BY THE 39-20-02 CONTRACTOR.
- CONTRACT 58-20-01 - TRUSS CONDUITS ARE TO BE PROVIDED AND INSTALLED BY THE 58-20-01 CONTRACTOR AS COORDINATED BY THE TCS INTEGRATOR . THE 58-20-01 CONTRACTOR WILL COORDINATE INSTALLATION OF TRUSS CONDUITS AND TCS EQUIPMENT SUPPORT FRAMES DIRECTLY AFTER ASSEMBLY OF TRUSS AND PRIOR TO ERECTION OF TRUSS BY 39-20-02 CONTRACTOR.
- CONTRACT 58-20-01 - CONTROLLER CABINET CONCRETE PAD SHALL BE PROVIDED AND INSTALLED BY THE 58-20-01 CONTRACTOR.
- CONTRACT 58-20-01 - TCS EQUIPMENT SUPPORT FRAME AND BRACKET DETAILS TO BE PROVIDED BY THE TCS INTEGRATOR. TCS EQUIPMENT SUPPORT FRAMES AND BRACKETS TO BE PROVIDED AND INSTALLED BY THE 58-20-01 CONTRACTOR.
- CONTRACT 58-20-01 - TCS EQUIPMENT WIRING AND CONDUCTOR DETAILS SHALL BE PROVIDED BY THE TCS INTEGRATOR. WIRING TO BE PROVIDED AND INSTALLED BY THE 58-20-01 CONTRACTOR IN COORDINATOIN WITH THE TCS INTEGRATOR.

CONSTRUCTION BY CONTRACT

- 58-20-01
- 39-20-02B
- 39-20-02A
- TOLL SYSTEM INTEGRATOR

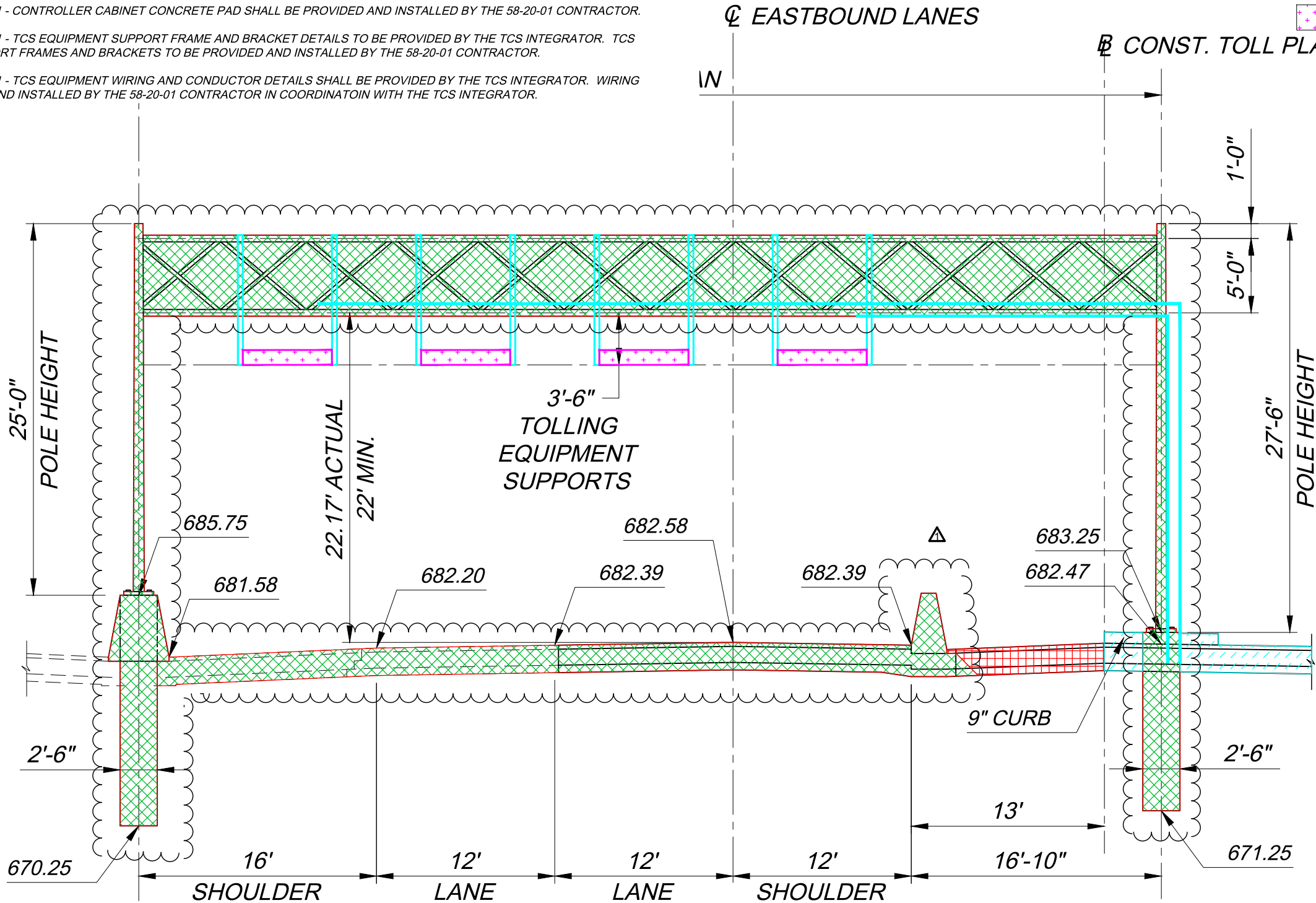

TCS INTEGRATOR EQUIPMENT SUPPORTS TO BE PROVIDED AND INSTALLED BY THE 58-20-01 CONTRACTOR ON THE TRUSS PRIOR TO ERECTION BY THE 39-20-02 CONTRACTOR. CONDUITS FOR THE TCS EQUIPMENT ARE TO BE PROVIDED AND INSTALLED BY THE 58-20-01 CONTRACTOR ON THE TRUSS PRIOR TO ERECTION. THE TRUSSES SHALL BE INSTALLED AFTER THE PEDESTRIAN BRIDGE HAS BEEN INSTALLED. THE 39-20-02 AND 58-20-01 CONTRACTORS ARE RESPONSIBLE FOR COORDINATING THIS WORK.

CONSTRUCTION CONTRACT BREAKOUT FOR INFORMATIONAL PURPOSES ONLY

DESIGN AGENCY

JACOBS

90 DE JAVELANE, FLOOR
BOSTON, MA 02118
OFFICE 617-252-8822

BY DATE

AMS 1/9/20

REVISIONS

ADDENDUM NO. 1

NO

Δ

CHECKED

CSM

IN CHARGE

AMS

DESIGNED

AMS

DRAWN

AMS

CONTRACT COORDINATION PLANS

OVERHEAD TOLL EQUIPMENT

LUCAS COUNTY

TP-49

PROJECT 39-20-02B

DATE: 12/20/2019

3 / 5

11 / 59

OHIO TURNPIKE

OHIO TURNPIKE AND INFRASTRUCTURE COMMISSION

SPECIAL PROVISIONS

- B. Baseline Construction Schedule:** The Baseline Construction Schedule for the 2020 Construction Season of this Project shall be submitted and acceptable prior to the Contractor performing the Work in accordance with General Condition Articles 4.2 and 4.3 and SP 120A to the extent made applicable through incorporation in the Contract Documents. Liquidated damages for failure to submit an acceptable Construction Schedule shall commence on the day the Contractor begins to perform the Work described in General Conditions Article 4.2.4.2. The 2020 Construction Access Date shall signify the **beginning of the Work**.
- C. 2020 Construction Access:** The Commission anticipates providing the Contractor access to the Turnpike as follows:
1. **March 1, 2020** - Tree Removal.
 2. **April 7, 2020** – Partial access from MP48.9 to MP 50.92 and full access to both the north and south Toll Plaza areas.
 3. **May 15, 2020** - Full access from MP 46.5 to MP 50.92.
- D. 2020 Toll Plaza Site Grading Completion Interim Milestone:** The 2020 Toll Plaza Site Grading Completion Interim Milestone shall be defined as having all the Toll Plaza Grading complete on both the north and south side of the Turnpike including the toll plaza site drainage, ditches and 58-20-01 Lay Down Areas in its entirety by August 31, 2020 in order to turn both the north and south sites over to the Building Contractor, Project 58-20-01. The Toll Plaza building sites and staging areas are defined on the Contractor Coordination Drawing located on Project 39-20-02B, Sheets **9 thru 13 of 59**. ~~xx of xx~~. Liquidated Damages for failure to complete this Interim Milestone as described above shall commence on September 1, 2020.
- E. 2020 Permanent Seeding Completion Interim Milestone:** The 2020 Permanent Seeding Completion Interim Milestone shall be defined as having all permanent seeding complete for all disturbed areas for the Westbound Mainline Part A and Part B for both the North and South Side Site Work, not including the Waste Site Areas, in its entirety by **September 30, 2020**. Liquidated Damages for failure to complete this Interim Milestone as described above shall commence on **October 1, 2020**.
- F. 2020 Westbound Pavement Completion Interim Milestone:** The 2020 Westbound Pavement Completion Interim Milestone shall be defined as completing all westbound asphalt paving and approach slabs by **October 16, 2020 with exception to the requirements listed for the 58-20-01 Lay Down Areas**. Liquidated Damages for failure to complete this Interim Milestone as described above shall commence on **October 17, 2020**.
- G. 2020 Westbound Substantial Completion Interim Milestone:** The 2020 Westbound Substantial Completion Interim Milestone shall be defined as having all traffic lanes and both shoulders open to Turnpike traffic in both directions including all traffic control and safety devices in place and approved by the Chief Engineer by **November 4, 2020**. Liquidated Damages for failure to complete this Interim Milestone as described above shall commence on **November 5, 2020**.

PROJECT NO. 39-20-02 - ESTIMATED QUANTITIES WORKSHEET

Ref. No.	Item No.	Item Description	Approx. Quantity	Unit	Unit Cost	Extended Bid Amount
		39-20-02A - ROADWAY (Ref. Nos. 1 - 67)				
1	201	CLEARING AND GRUBBING, AS PER PLAN	1	LS		\$ -
2	201	TREE REMOVED, 18" SIZE	119	EACH		\$ -
3	201	TREE REMOVED, 30" SIZE	58	EACH		\$ -
4	201	TREE REMOVED, 48" SIZE	6	EACH		\$ -
5	202	HEADWALL REMOVED	44	EACH		\$ -
6	202	PIPE REMOVED, 24" AND UNDER	2,104	FT		\$ -
7	202	PIPE REMOVED, OVER 24"	260	FT		\$ -
8	202	CATCH BASIN OR INLET REMOVED	26	EACH		\$ -
9	202	FENCE REMOVED	49,266	FT		\$ -
10	202	GUARDRAIL REMOVED, AS PER PLAN	13,057	FT		\$ -
11	202	PAVEMENT REMOVED, AS PER PLAN	180,740	SY		\$ -
12	202	CONCRETE BARRIER REMOVED	386	FT		\$ -
13	202	STRUCTURE REMOVED	2	EACH		\$ -
14	202	PORTIONS OF STRUCTURES REMOVED, AS PER PLAN	10	CY		\$ -
15	202	REMOVAL MISC.: CONCRETE CHANNEL REMOVED	200	SY		\$ -
16	202	REMOVAL MISC.: STEEL PLATE REMOVED	1	EACH		\$ -
17	202	REMOVAL MISC.: TEMPORARY SHEETING REMOVED	1	LS		\$ -
18	SPECIAL	PIPE CLEANOUT, 24" DIA AND UNDER	124	FT		\$ -
19	SPECIAL	PIPE CLEANOUT, 27" TO 48"	662	FT		\$ -
20	203	EXCAVATION	83,967	CY		\$ -
21	203	EMBANKMENT, AS PER PLAN	16,539	CY		\$ -
22	203	ROADWAY EXCAVATION AND EMBANKMENT	1,800	CY		\$ -
23	203	EXCAVATION INCLUDING EMBANKMENT CONSTRUCTION, AS PER PLAN	19,812	CY		\$ -
24	203	BORROW	9,906	CY		\$ -
25	203	GRANULAR MATERIAL, TYPE C	145	CY		\$ -
26	203	GRANULAR EMBANKMENT, AS PER PLAN (SHEAR KEY)	1,873	CY		\$ -
27	203	GRANULAR EMBANKMENT, AS PER PLAN (NO. 8 AGGREGATE)	60	CY		\$ -
28	204	SUBGRADE COMPACTION	227	SY		\$ -
29	204	EXCAVATION	178	CY		\$ -
30	204	GEOTEXTILE FABRIC, 712.09, TYPE A	600	SY		\$ -
31	204	GEOTEXTILE FABRIC, TYPE B	4,795	SY		\$ -
32	204	GEOTEXTILE FABRIC, 712.09, TYPE D	227	SY		\$ -
33	206	CEMENT STABILIZED SUBGRADE, 14 INCHES DEEP, AS PER PLAN	216,545	SY		\$ -
34	206	CEMENT STABILIZED SUBGRADE, 16 INCHES DEEP	12,000	SY		\$ -
35	206	CEMENT	10,280	TON		\$ -
36	206	CURING COAT, AS PER PLAN	13,470	GAL		\$ -
37	206	TEST ROLLING	140	HOUR		\$ -
38	206	PRE-PULVERIZATION, 10 INCHES DEEP, AS PER PLAN	6,785	SY		\$ -
39	206	FULL-DEPTH RECLAMATION, 12 INCHES, AS PER PLAN	6,785	SY		\$ -
40	206	FULL DEPTH RECLAMATION CURING COAT, AS PER PLAN	2,040	GAL		\$ -
41	209	LINER GRADING, AS PER PLAN	42,608	FT		\$ -
42	209	DITCH CLEANOUT, AS PER PLAN	2,000	FT		\$ -

PROJECT NO. 39-20-02 - ESTIMATED QUANTITIES WORKSHEET

Ref. No.	Item No.	Item Description	Approx. Quantity	Unit	Unit Cost	Extended Bid Amount
43	SP 304	GRANULAR MATERIAL	178	CY		\$ -
44	606	GUARDRAIL, TYPE MGS, WITH LONG STEEL POSTS	10,135	FT		\$ -
45	606	ANCHOR ASSEMBLY, MGS TYPE T	15	EACH		\$ -
46	606	ANCHOR ASSEMBLY, MGS TYPE A	1	EACH		\$ -
47	606	MGS BRIDGE TERMINAL ASSEMBLY, TYPE 1, WITH LONG STEEL POSTS	11	EACH		\$ -
48	606	MGS BRIDGE TERMINAL ASSEMBLY, TYPE 2	7	EACH		\$ -
49	SP 606A	ANCHOR ASSEMBLY, MGS TYPE E	15	EACH		\$ -
50	SP 606B	IMPACT ATTENUATOR, TYPE 2 (BI-DIRECTIONAL)	2	EACH		\$ -
51	607	FENCE, TYPE 47, AS PER PLAN	45,569	FT		\$ -
52	607	FENCELINE SEEDING AND MULCHING	49,266	FT		\$ -
53	SP 607	FENCE, TYPE CL, AS PER PLAN	3,697	FT		\$ -
54	SPECIAL	FENCELINE CLEARING AND GRUBBING	49,266	FT		\$ -
55	609	ASPHALT CONCRETE CURB, TYPE 1, PG64-22	3,795	FT		\$ -
56	609	CURB, TYPE 4-C	135	FT		\$ -
57	622	CONCRETE BARRIER, SINGLE SLOPE, TYPE B-50, AS PER PLAN	227	FT		\$ -
58	622	CONCRETE BARRIER, END ANCORAGE, REINFORCED, TYPE B-50, AS PER PLAN	4	EACH		\$ -
59	622	CONCRETE BARRIER, SINGLE SLOPE, TYPE C	3,248	FT		\$ -
60	622	CONCRETE BARRIER, END SECTION, TYPE C	2	EACH		\$ -
61	622	CONCRETE BARRIER, END ANCORAGE, REINFORCED, TYPE C	6	EACH		\$ -
62	622	CONCRETE BARRIER, SINGLE SLOPE, TYPE D, AS PER PLAN	200	FT		\$ -
63	622	CONCRETE BARRIER, END SECTION, TYPE D, AS PER PLAN	14	EACH		\$ -
64	622	CONCRETE BARRIER, END ANCORAGE, REINFORCED, TYPE D, AS PER PLAN	3	EACH		\$ -
65	SP 626	BARRIER REFLECTOR, TYPE A	175	EACH		\$ -
66	SP 626	BARRIER REFLECTOR, TYPE B	88	EACH		\$ -
67	861	GEOGRID FOR SUBGRADE STABILIZATION, AS PER PLAN, TENSAR TRIAX 160 GEOGRID	227	SY		\$ -
TOTAL - 39-20-02A - ROADWAY						\$ -

		39-20-02A - EROSION CONTROL (Ref. Nos. 68-91)				
68	SP 113	SWPPP MANAGEMENT	1	LS		\$ -
69	601	ROCK CHANNEL PROTECTION, TYPE B WITH FILTER	224	CY		\$ -
70	601	ROCK CHANNEL PROTECTION, TYPE C WITH FILTER	800	CY		\$ -
71	601	TIED CONCRETE BLOCK MAT, TYPE 1	136	SY		\$ -
72	659	SOIL ANALYSIS TEST	10	EACH		\$ -
73	659	TOPSOIL	12,080	CY		\$ -
74	659	SEEDING AND MULCHING	108,911	SY		\$ -
75	659	REPAIR SEEDING AND MULCHING	4,970	SY		\$ -
76	659	INTER-SEEDING	4,970	SY		\$ -
77	659	COMMERCIAL FERTILIZER	13.42	TON		\$ -
78	659	LIME	20.54	ACRE		\$ -
79	659	WATER	537	MGAL		\$ -
80	659	MOWING, AS PER PLAN	21.60	MILE		\$ -
81	660	DITCH EROSION PROTECTION MAT TYPE A	3,506	SY		\$ -

PROJECT NO. 39-20-02 - ESTIMATED QUANTITIES WORKSHEET

Ref. No.	Item No.	Item Description	Approx. Quantity	Unit	Unit Cost	Extended Bid Amount
82	671	EROSION CONTROL MAT, TYPE B	9,511	SY		\$ -
83	832	EROSION CONTROL	1	LS		\$ -
84	832	INLET PROTECTION	1,732	FT		\$ -
85	832	SLOPE DRAIN	200	FT		\$ -
86	832	CONSTRUCTION SEEDING AND MULCHING	183,714	SY		\$ -
87	832	PERIMETER FILTER FABRIC FENCE	8,580	FT		\$ -
88	832	FILTER FABRIC DITCH CHECK	3,840	FT		\$ -
89	832	CONSTRUCTION ENTRANCE	500	CY		\$ -
90	832	ROCK CHANNEL PROTECTION, TYPE C OR D, WITH FILTER	250	CY		\$ -
91	832	MISCELLANEOUS SEDIMENT REMOVAL	2,000	CY		\$ -
TOTAL - 39-20-02A - EROSION CONTROL						\$ -

39-20-02A - DRAINAGE (Ref. Nos. 92-119)						
92	602	CONCRETE MASONRY	3.4	CY		\$ -
93	SP 605	6" BASE PIPE UNDERDRAIN, WITH FABRIC WRAP (18")	42,536	FT		\$ -
94	SP 605	6" SHALLOW PIPE UNDERDRAIN, WITH FABRIC WRAP (24")	1,707	FT		\$ -
95	SP 605	6" SHALLOW PIPE UNDERDRAIN, WITH FABRIC WRAP (30")	48,269	FT		\$ -
96	SP 605	6" UNDERDRAIN OUTLET PIPE	2,425	FT		\$ -
97	SP 605	AGGREGATE DRAIN, TYPE 1, WITH FABRIC WRAP	200	FT		\$ -
98	SP 605	AGGREGATE DRAIN, TYPE 2, WITH FABRIC WRAP	200	FT		\$ -
99	SP 611	4" CONDUIT, TYPE E, 707.31 (TYPE CP)	255	FT		\$ -
100	SP 611	4" CONDUIT, TYPE F, 707.33	120	FT		\$ -
101	SP 611	12" CONDUIT, TYPE F, 707.33	1,112	FT		\$ -
102	SP 611	15" CONDUIT, TYPE B, 706.02	523	FT		\$ -
103	SP 611	18" CONDUIT, TYPE B, 706.02	80	FT		\$ -
104	SP 611	24" CONDUIT, TYPE B, 706.02	126	FT		\$ -
105	SP 611	30" CONDUIT, TYPE B, 706.02	200	FT		\$ -
106	SP 611	48" CONDUIT, TYPE A, 706.02, AS PER PLAN	136	FT		\$ -
107	SP 611	PRECAST REINFORCED CONCRETE OUTLET	81	EACH		\$ -
108	SP 611	CATCH BASIN, NO. CB-1	7	EACH		\$ -
109	SP 611	CATCH BASIN, NO. CB-1, AS PER PLAN	17	EACH		\$ -
110	SP 611	CATCH BASIN, NO. 6	2	EACH		\$ -
111	SP 611	CATCH BASIN, AS PER PLAN	1	EACH		\$ -
112	SP 611	INLET, NO. I-3C (ODOT)	4	EACH		\$ -
113	SP 611	WATER QUALITY BASIN	2	EACH		\$ -
114	SP 611	MANHOLE, NO. 3	1	EACH		\$ -
115	SPECIAL	12" PRECAST CONCRETE END SECTION	25	EACH		\$ -
116	SPECIAL	15" PRECAST CONCRETE END SECTION	18	EACH		\$ -
117	SPECIAL	18" PRECAST CONCRETE END SECTION	8	EACH		\$ -
118	SPECIAL	30" PRECAST CONCRETE END SECTION	3	EACH		\$ -
119	SPECIAL	48" PRECAST CONCRETE END SECTION	2	EACH		\$ -
TOTAL - 39-20-02A - DRAINAGE						\$ -

PROJECT NO. 39-20-02 - ESTIMATED QUANTITIES WORKSHEET

Ref. No.	Item No.	Item Description	Approx. Quantity	Unit	Unit Cost	Extended Bid Amount
		39-20-02A - PAVEMENT (Ref. Nos. 120-135)				
120	252	FULL DEPTH PAVEMENT SAWING	47,400	FT		\$ -
121	254	PAVEMENT PLANING, ASPHALT CONCRETE (VARIABLE DEPTH)	670	SY		\$ -
122	SP 302	ASPHALT CONCRETE BASE, PG64-22 (SHOULDER)	10,339	CY		\$ -
123	SP 302	ASPHALT CONCRETE BASE, PG64-22	46,100	CY		\$ -
124	SP 304	AGGREGATE BASE (SHOULDER)	16,913	CY		\$ -
125	SP 304	AGGREGATE BASE	24,009	CY		\$ -
126	SP 304	AGGREGATE BASE (VARIABLE THICKNESS)	2,439	CY		\$ -
127	SP 402	ASPHALT CONCRETE INTERMEDIATE COURSE OR RECYCLED ASPHALT CONCRETE INTERMEDIATE COURSE, PG64-22	2,811	CY		\$ -
128	SP 402	ASPHALT CONCRETE INTERMEDIATE COURSE OR RECYCLED ASPHALT CONCRETE INTERMEDIATE COURSE, PG76-22 (FR)	6,064	CY		\$ -
129	SP 404	ASPHALT CONCRETE SURFACE COURSE, USING CRUSHED STONE, PG64-22	2,421	CY		\$ -
130	SP 404	ASPHALT CONCRETE SURFACE COURSE, USING CRUSHED SLAG, PG76-22 (FR)	5,217	CY		\$ -
131	SP 404A	JOINT SEALER	112,944	FT		\$ -
132	407	NON -TRACKING TACK COAT	36,570	GAL		\$ -
133	452	15-1/4" NON-REINFORCED PORTLAND CEMENT CONCRETE PAVEMENT, CLASS QC 1, AS PER PLAN	752	SY		\$ -
134	SP 627	STONE SHOULDER PROTECTION	356	CY		\$ -
135	SPECIAL	SONIC NAP ALERT PATTERN	18.35	MILE		\$ -
		TOTAL - 39-20-02A - PAVEMENT				\$ -

		39-20-02A - MAINTENANCE OF TRAFFIC (Ref. Nos. 136-167)				
136	614	WORK ZONE CROSSOVER LIGHTING SYSTEM	2	EACH		\$ -
137	614	WORK ZONE IMPACT ATTENUATOR FOR 24" WIDE HAZARDS (UNIDIRECTIONAL)	8	EACH		\$ -
138	614	REPLACEMENT SIGN	20	EACH		\$ -
139	614	ASPHALT CONCRETE FOR MAINTAINING TRAFFIC	300	CY		\$ -
140	614	PORTABLE CHANGEABLE MESSAGE SIGN, AS PER PLAN	1,900	DAY		\$ -
141	614	WORK ZONE LANE LINE, CLASS I, 642 PAINT (4" WHITE)	6.44	MILE		\$ -
142	614	WORK ZONE EDGE LINE, CLASS I, 642 PAINT (4" WHITE)	23.71	MILE		\$ -
143	614	WORK ZONE EDGE LINE, CLASS I, 642 PAINT (4" YELLOW)	17.36	MILE		\$ -
144	614	WORK ZONE EDGE LINE, CLASS I, 642 PAINT (6" WHITE)	1.19	MILE		\$ -
145	614	WORK ZONE EDGE LINE, CLASS I, 642 PAINT (6" YELLOW)	7.64	MILE		\$ -
146	614	WORK ZONE EDGE LINE, CLASS I, 642 PAINT (8" WHITE)	3.95	MILE		\$ -
147	614	WORK ZONE EDGE LINE, CLASS I, 642 PAINT (8" YELLOW)	3.95	MILE		\$ -
148	614	WORK ZONE CHANNELIZING LINE, CLASS I, 642 PAINT (8" WHITE)	17,726	FT		\$ -
149	SP 614	ZONE PERSON	20,000	HOUR		\$ -
150	SP 614B	WORK ZONE WHITE LANE LINE, 4 INCH	0.08	MILE		\$ -
151	SP 614B	WORK ZONE WHITE EDGE LINE, 4 INCH	0.40	MILE		\$ -
152	SP 614B	WORK ZONE YELLOW EDGE LINE, 4 INCH	0.32	MILE		\$ -
153	SP 614B	WORK ZONE YELLOW EDGE LINE, 6 INCH	0.08	MILE		\$ -
154	SP 614C	REMOVAL OF PAVEMENT MARKING	94.78	MILE		\$ -
155	616	WATER	2,000	M GAL		\$ -
156	SP 621	RAISED PAVEMENT MARKER-STIMSONITE MODEL 101 LPCR	50	EACH		\$ -

PROJECT NO. 39-20-02 - ESTIMATED QUANTITIES WORKSHEET

Ref. No.	Item No.	Item Description	Approx. Quantity	Unit	Unit Cost	Extended Bid Amount
157	SP 621	REPLACEMENT PRISMATIC RETRO-REFLECTOR	50	EACH		\$ -
158	SP 621	REPLACEMENT RAISED PAVEMENT MARKER CASTING-STIMSONITE MODEL 101 LPCR	50	EACH		\$ -
159	SP 622	32" PORTABLE BARRIER (WITH GLARE SCREEN)	1	LS		\$ -
160	SP 622	32" PORTABLE BARRIER (WITHOUT GLARE SCREEN)	1	LS		\$ -
161	SP 626	BARRIER REFLECTOR, TYPE A (WHITE)	50	EACH		\$ -
162	SP 626	BARRIER REFLECTOR, TYPE B	450	EACH		\$ -
163	SP 626A	CONSTRUCTION ZONE MARKER, ONE-WAY MODEL, WHITE	5,406	EACH		\$ -
164	SP 626A	CONSTRUCTION ZONE MARKER, ONE-WAY MODEL, YELLOW	2,792	EACH		\$ -
165	630	SIGNING, MISC.: ADDITIONAL SIGNS WITH SUPPORTS, AS DIRECTED BY THE CHIEF ENGINEER	500	SF		\$ -
166	SPECIAL	EXISTING CROSSOVER TO BE CLOSED / RE-OPENED	2	LS		\$ -
167	SPECIAL	SPEED MEASUREMENT MARKING, AS PER PLAN	10	EACH		\$ -
TOTAL - 39-20-02A - MAINTENANCE OF TRAFFIC						\$ -

		39-20-02A - TRAFFIC CONTROL (Ref. Nos. 168-214)				
168	620	REMOVAL OF DELINEATOR	178	EACH		\$ -
169	620	DELINEATOR, POST MOUNTED, AS PER PLAN	178	EACH		\$ -
170	621	RAISED PAVEMENT MARKER REMOVED	470	EACH		\$ -
171	SP 621	REPLACEMENT PRISMATIC RETRO-REFLECTOR	550	EACH		\$ -
172	SP 621	RAISED PAVEMENT MARKER - STIMSONITE MODEL 101 LPCR	1,225	EACH		\$ -
173	625	GROUND ROD	32	EACH		\$ -
174	625	CONDUIT, 1 1/2", 725.051	960	FT		\$ -
175	625	CONDUIT, 4", 725.051	360	FT		\$ -
176	625	JUNCTION BOX, 12"x18"x24"	12	EACH		\$ -
177	SP 626	BARRIER REFLECTOR, TYPE B	540	EACH		\$ -
178	630	GROUND MOUNTED STRUCTURAL BEAM SUPPORT, S4x7.7	70.3	FT		\$ -
179	630	GROUND MOUNTED STRUCTURAL BEAM SUPPORT, W6x9	88.8	FT		\$ -
180	630	GROUND MOUNTED STRUCTURAL BEAM SUPPORT, W10x12	82.3	FT		\$ -
181	630	BARRIER MOUNTED STRUCTURAL BEAM SUPPORT, W8x18	48.9	FT		\$ -
182	630	GROUND MOUNTED STRUCTURAL BEAM SUPPORT FOUNDATION	12	EACH		\$ -
183	630	BREAKAWAY STRUCTURAL BEAM CONNECTION	12	EACH		\$ -
184	630	SIGN ERECTED, FLAT SHEET, AS PER PLAN	183	EACH		\$ -
185	630	SIGN ERECTED, EXTRUSHEET, AS PER PLAN	40	EACH		\$ -
186	630	CONCRETE MEDIAN BARRIER OVERHEAD SIGN SUPPORT FOUNDATION, TYPE TC-21.50, AS PER PLAN	4	EACH		\$ -
187	630	RIGID OVERHEAD SIGN SUPPORT FOUNDATION, AS PER PLAN	22	EACH		\$ -
188	630	OVERHEAD SIGN SUPPORT, TYPE 7.65, DESIGN 8	8	EACH		\$ -
189	630	OVERHEAD SIGN SUPPORT, TYPE 7.65, DESIGN 8, AS PER PLAN	4	EACH		\$ -
190	630	OVERHEAD SIGN SUPPORT, TYPE 12.30, DESIGN 8	2	EACH		\$ -
191	630	OVERHEAD SIGN SUPPORT, TYPE 12.30, DESIGN 10	5	EACH		\$ -
192	630	OVERHEAD SIGN SUPPORT, TYPE 16.21, DESIGN 13	1	EACH		\$ -
193	630	SIGN POST REFLECTOR	82	EACH		\$ -
194	630	REMOVAL OF POLE MOUNTED SIGN AND DISPOSAL	5	EACH		\$ -
195	630	REMOVAL OF GROUND MOUNTED SIGN AND DISPOSAL	118	EACH		\$ -

PROJECT NO. 39-20-02 - ESTIMATED QUANTITIES WORKSHEET

Ref. No.	Item No.	Item Description	Approx. Quantity	Unit	Unit Cost	Extended Bid Amount
196	630	REMOVAL OF GROUND MOUNTED POST SUPPORT AND DISPOSAL	94	EACH		\$ -
197	630	REMOVAL OF GROUND MOUNTED MAJOR SIGN AND DISPOSAL	7	EACH		\$ -
198	630	REMOVAL OF GROUND MOUNTED STRUCTURAL BEAM SUPPORT AND DISPOSAL	12	EACH		\$ -
199	630	REMOVAL OF OVERHEAD SIGN SUPPORT AND DISPOSAL, TYPE TC-7.65	2	EACH		\$ -
200	630	REMOVAL OF OVERHEAD SIGN SUPPORT AND DISPOSAL, TYPE TC-12.30	5	EACH		\$ -
201	630	REMOVAL OF OVERHEAD SIGN SUPPORT AND DISPOSAL, TYPE TC-17.10	1	EACH		\$ -
202	630	REMOVAL OF OVERHEAD MOUNTED SIGN AND DISPOSAL	18	EACH		\$ -
203	630	SIGNING, MISC.: MILEPOST AND TENTH MILEPOST SIGNS REMOVED	178	EACH		\$ -
204	630	SIGNING, MISC.: TENTH MILEPOST SIGN ERECTED	160	EACH		\$ -
205	631	SIGN LIGHTING MISC.: REMOVE SIGN LIGHTING AND SIGN SERVICE	2	EACH		\$ -
206	632	SAW CUTTING FOR PAVEMENT LOOPS	1,220	FT		\$ -
207	642	EDGE LINE, 6", TYPE 1	58.54	MILE		\$ -
208	642	LANE LINE, 6", TYPE 1	31.75	MILE		\$ -
209	642	DOTTED LINE, 6", TYPE 1	4,440	FT		\$ -
210	642	CHANNELIZING LINE, 12", TYPE 1	12,197	FT		\$ -
211	642	CHEVRON MARKING, 24", TYPE 1	970	FT		\$ -
212	642	LANE REDUCTION ARROW, TYPE 1	6	EACH		\$ -
213	642	WORD ON PAVEMENT, 96", TYPE 1	14	EACH		\$ -
214	SPECIAL	SPEED MEASUREMENT MARKING	20	EACH		\$ -
TOTAL - 39-20-02A - TRAFFIC CONTROL						\$ -
		39-20-02A - LIGHTING (Ref. Nos. 215-237)				
215	625	CONNECTION, UNFUSED, PERMANENT	102	EACH		\$ -
216	625	CONNECTION, FUSED, PULL APART	96	EACH		\$ -
217	625	PULL BOX 725.08, 24"	4	EACH		\$ -
218	625	GROUND ROD	49	EACH		\$ -
219	625	TRENCH, 24" DEEP	5,747	FT		\$ -
220	625	TRENCH IN PAVED AREA	436	FT		\$ -
221	625	MEDIAN JUNCTION BOX	6	EACH		\$ -
222	625	NO. 4 AWG 2400 VOLT DISTRIBUTION CABLE	20,610	FT		\$ -
223	625	NO. 4 AWG GROUND CONDUCTOR	9,928	FT		\$ -
224	625	NO. 10 AWG POLE AND BRACKET CABLE	7,000	FT		\$ -
225	625	2" CONDUIT	5,956	FT		\$ -
226	625	3" CONDUIT	120	FT		\$ -
227	625	3" CONDUIT, JACKED OR DRILLED	107	FT		\$ -
228	625	CONTROL CENTER CABINET, COMPLETE	1	EACH		\$ -
229	625	LIGHT POLE FOUNDATION, 24"X 10' DEEP	28	EACH		\$ -
230	625	MEDIAN LIGHT POLE FOUNDATION, 10' DEEP	20	EACH		\$ -
231	625	LIGHT POLE CONVENTIONAL, AT20B40	28	EACH		\$ -
232	625	LIGHT POLE CONVENTIONAL, A20BB40	20	EACH		\$ -
233	625	LUMINAIRE, CONVENTIONAL, 388W, LED, TYPE II, MVOLT, AS PER PLAN	10	EACH		\$ -
234	625	LUMINAIRE, CONVENTIONAL, 388W, LED, TYPE IV, MVOLT, AS PER PLAN	18	EACH		\$ -

PROJECT NO. 39-20-02 - ESTIMATED QUANTITIES WORKSHEET

Ref. No.	Item No.	Item Description	Approx. Quantity	Unit	Unit Cost	Extended Bid Amount
235	625	LUMINAIRE, CONVENTIONAL, 214W, LED, TYPE III, MVOLT, AS PER PLAN	20	EACH		\$ -
236	625	LUMINAIRE, CONVENTIONAL, 83W, LED, TYPE III, MVOLT, AS PER PLAN	20	EACH		\$ -
237	625	PLASTIC CAUTION TAPE	6,220	FT		\$ -
TOTAL - 39-20-02A - LIGHTING						\$ -

39-20-02A - STRUCTURES 20 FT SPAN AND UNDER (MP 48.7) (Ref. Nos. 238-258)						
238	202	PORTIONS OF STRUCTURE REMOVED	1	LS		\$ -
239	203	EXCAVATION	96	CY		\$ -
240	203	GRANULAR MATERIAL, TYPE C (703.16)	96	CY		\$ -
241	204	GEOTEXTILE FABRIC, TYPE A	256	SY		\$ -
242	204	GEOTEXTILE FABRIC, TYPE D	288	SY		\$ -
243	503	COFFERDAMS AND EXCAVATION BRACING	1	LS		\$ -
244	503	UNCLASSIFIED EXCAVATION (WINGWALL FOOTINGS)	150	CY		\$ -
245	SP509	EPOXY COATED REINFORCING STEEL	7,449	LB		\$ -
246	510	DOWEL HOLES WITH NON-SHRINK, NON-METALLIC GROUT	124	EACH		\$ -
247	511	CLASS QC1 CONCRETE, RETAINING/WINGWALL NOT INCLUDING FOOTING	23	CY		\$ -
248	511	CLASS QC1 CONCRETE, FOOTING	61	CY		\$ -
249	512	TYPE 2 MEMBRANE WATERPROOFING	350	SY		\$ -
250	512	SEALING OF CONCRETE SURFACES (NON-EPOXY)	48	SY		\$ -
251	516	1" PREFORMED EXPANSION JOINT FILLER	49	SF		\$ -
252	518	POROUS BACKFILL WITH FILTER FABRIC	30	CY		\$ -
253	SP519A	PATCHING CONCRETE, BOX STRUCTURES	5	SF		\$ -
254	601	ROCK CHANNEL PROTECTION, TYPE B WITH FILTER	30	CY		\$ -
255	602	CONCRETE MASONRY	18	CY		\$ -
256	611	12' X 6'-3" CONDUIT, TYPE A, 706.05, AS PER PLAN	96	FT		\$ -
257	613	LOW STRENGTH MORTAR BACKFILL (TYPE 2)	7	CY		\$ -
258	SPECIAL	PIPE CLEANOUT, 12' (SPAN) X 6'-3" (RISE)	173	FT		\$ -
TOTAL - 39-20-02A - STRUCTURES 20 FT SPAN AND UNDER (MP 48.7)						\$ -

39-20-02A - STRUCTURES OVER 20 FT SPAN (M.P. 47.4 AND M.P. 47.5) (Ref. Nos. 259-261)						
259	202	APPROACH SLAB REMOVED	494	SY		\$ -
260	526	APPROACH SLAB (T=12"), AS PER PLAN	529	SY		\$ -
261	SP536	CONCRETE WEATHERPROOFING, APPROACH SLABS	491	SY		\$ -
TOTAL - 39-20-02A - STRUCTURES OVER 20 FT SPAN (M.P. 47.4 AND M.P. 47.5)						\$ -

39-20-02B - ROADWAY (Ref. Nos. 262 - 277)						
262	201	CLEARING AND GRUBBING	1	LS		\$ -
263	202	HEADWALL REMOVED	1	EACH		\$ -
264	202	PIPE REMOVED, 4" AND UNDER, AS PER PLAN	1,480	FT		\$ -
265	202	PIPE REMOVED, 24" AND UNDER	70	FT		\$ -
266	202	PUMP STATION DEMOLISHED	1	LS		\$ -
267	202	CONCRETE CURB REMOVED	1,467	FT		\$ -
268	202	PAVEMENT REMOVED, AS PER PLAN	2,176	SY		\$ -
269	202	REMOVAL MISC.: CONCRETE CHANNEL REMOVED	110	SY		\$ -

PROJECT NO. 39-20-02 - ESTIMATED QUANTITIES WORKSHEET

Ref. No.	Item No.	Item Description	Approx. Quantity	Unit	Unit Cost	Extended Bid Amount
270	202	REMOVAL MISC.	1	LS		\$ -
271	203	EXCAVATION	40,798	CY		\$ -
272	203	EMBANKMENT	23,518	CY		\$ -
273	606	GUARDRAIL, TYPE MGS, WITH LONG STEEL POSTS	1,313.25	FT		\$ -
274	606	ANCHOR ASSEMBLY, MGS TYPE T	2	EACH		\$ -
275	607	FENCE, TYPE 47, AS PER PLAN	491	FT		\$ -
276	SP 626	BARRIER REFLECTOR, TYPE A	16	EACH		\$ -
277	SP 627	STONE SHOULDER PROTECTION (T=3")	38	CY		\$ -
TOTAL - 39-20-02B - ROADWAY						\$ -

39-20-02B - EROSION CONTROL (Ref. Nos. 278-285)						
278	651	TOPSOIL STOCKPILED	4,663	CY		\$ -
279	652	PLACING STOCKPILED TOPSOIL	4,256	CY		\$ -
280	659	SEEDING AND MULCHING	73,433	SY		\$ -
281	659	REPAIR SEEDING AND MULCHING	3,672	SY		\$ -
282	659	INTER-SEEDING	5,000	SY		\$ -
283	659	COMMERCIAL FERTILIZER	6.60	TON		\$ -
284	659	LIME	15.20	ACRE		\$ -
285	659	WATER	398	MGAL		\$ -
TOTAL - 39-20-02B - EROSION CONTROL						\$ -

39-20-02B - DRAINAGE (Ref. Nos. 286-297)						
286	601	ROCK CHANNEL PROTECTION TYPE C WITH FILTER	10	CY		\$ -
287	SP 605	6" BASE PIPE UNDERDRAIN, WITH FABRIC WRAP (18")	3,127	FT		\$ -
288	SP 605	6" SHALLOW PIPE UNDERDRAIN, WITH FABRIC WRAP (30")	5,804	FT		\$ -
289	SP 611	PRECAST REINFORCED CONCRETE OUTLET, AS PER PLAN	6	EACH		\$ -
290	SP 611	15" CONDUIT, TYPE B, 706.02	24	FT		\$ -
291	SP 611	12" CONDUIT, TYPE C, 707.33	145	FT		\$ -
292	SP 611	6" CONDUIT, TYPE B	200	FT		\$ -
293	SP 611	6" CONDUIT, TYPE E	200	FT		\$ -
294	SP 611	6" CONDUIT, TYPE F	200	FT		\$ -
295	611	MANHOLE, CATCH BASIN OR INLET ADJUST TO GRADE	2	EACH		\$ -
296	SPECIAL	12" PRECAST CONCRETE END SECTION	1	EACH		\$ -
297	SPECIAL	15" PRECAST CONCRETE END SECTION	2	EACH		\$ -
TOTAL - 39-20-02B - DRAINAGE						\$ -

39-20-02B - PAVEMENT (Ref. Nos. 298-309)						
298	209	LINEAR GRADING	5,981	FT		\$ -
299	SP 302	ASPHALT CONCRETE BASE, PG64-22 (SHOULDER)	1,955	CY		\$ -
300	SP 302	ASPHALT CONCRETE BASE, PG64-22	5,100	CY		\$ -
301	SP 302	ASPHALT CONCRETE BASE, PG64-22	787	CY		\$ -
302	SP 304	AGGREGATE BASE (SHOULDER)	2,674	CY		\$ -
303	SP 304	AGGREGATE BASE	2,550	CY		\$ -
304	SP 402	ASPHALT CONCRETE INTERMEDIATE COURSE OR RECYCLED ASPHALT CONCRETE INTERMEDIATE COURSE, PG64-22	423	CY		\$ -

PROJECT NO. 39-20-02 - ESTIMATED QUANTITIES WORKSHEET

Ref. No.	Item No.	Item Description	Approx. Quantity	Unit	Unit Cost	Extended Bid Amount
305	SP 402	ASPHALT CONCRETE INTERMEDIATE COURSE OR RECYCLED ASPHALT CONCRETE INTERMEDIATE COURSE, PG76-22 (FR)	744	CY		\$ -
306	SP 404	ASPHALT CONCRETE SURFACE COURSE, USING CRUSHED STONE, PG64-22	658	CY		\$ -
307	SP 404	ASPHALT CONCRETE SURFACE COURSE, USING CRUSHED SLAG, PG76-22 (FR)	637	CY		\$ -
308	SP 404A	JOINT SEALER	5,026	FT		\$ -
309	407	NON -TRACKING TACK COAT	4,813	GAL		\$ -
TOTAL - 39-20-02B - PAVEMENT						\$ -

39-20-02B - TRAFFIC CONTROL (Ref. Nos. 310)						
310	SP 642	EDGE LINE, 6", TYPE 1	1.12	MILE		\$ -
TOTAL - 39-20-02B - TRAFFIC CONTROL						\$ -

39-20-02 - GENERAL (Ref. Nos. 311-315)						
311	IB,ART.6	PREMIUM FOR CONTRACT PERFORMANCE BOND AND PAYMENT BOND	1	LS		\$ -
312	SP 614	MAINTAINING TRAFFIC	1	LS		\$ -
313	SP 619	FIELD OFFICE	1	LS		\$ -
314	SP 623	CONSTRUCTION LAYOUT SURVEY	1	LS		\$ -
315	624	MOBILIZATION	1	LS		\$ -
TOTAL - 39-20-02 - GENERAL						\$ -

PROJECT 39-20-02 - TOTAL BASE BID (REF. No. 1 THRU REF. No. 315)				
---	--	--	--	--

PROJECT NO. 39-20-02 - ESTIMATED QUANTITIES WORKSHEET

Ref. No.	Item No.	Item Description	Approx. Quantity	Unit	Unit Cost	Extended Bid Amount
-------------	-------------	------------------	---------------------	------	--------------	------------------------

NOTE: Bidders must complete following information below.

WASTE SITE 1 DEDUCT ALTERNATE

The Bidder may deposit waste material on the westbound side for the 39-20-02 Project as described on Plan Sheet 496 - 2/3. Such deduct alternate must be submitted with the Bidder's Bid, and all the requirements to fulfill the Alternate Work as described in the Plans. The Bidder must fill in "yes" or "no" in the space provided below as to whether a Waste Site Proposal is included with the Bid and must also enter an amount to be deducted from the Total Base Bid as a credit due to the Commission, should this Proposal be approved. (Refer to Articles 2.6.3 and 3.5.1 of the INSTRUCTIONS TO BIDDERS)

A **Waste Site 1 Deduct Alternate** Proposal is included in the Bid Submittal: _____. (yes or no)

Amount of **WASTE SITE 1 DEDUCT ALTERNATE**: _____

WASTE SITE 2 DEDUCT ALTERNATE

The Bidder may deposit waste material on the eastbound side for the 39-20-02 Project as described on Plan Sheet 497 - 3/3. Such deduct alternate must be submitted with the Bidder's Bid, and all the requirements to fulfill the Alternate Work as described in the Plans. The Bidder must fill in "yes" or "no" in the space provided below as to whether a Waste Site Proposal is included with the Bid and must also enter an amount to be deducted from the Total Base Bid as a credit due to the Commission, should this Proposal be approved. (Refer to Articles 2.6.3 and 3.5.1 of the INSTRUCTIONS TO BIDDERS)

A **Waste Site 2 Deduct Alternate** Proposal is included in the Bid Submittal: _____. (yes or no)

Amount of **WASTE SITE 2 DEDUCT ALTERNATE**: _____

TEMPORARY ACCESS DEDUCT ALTERNATE

The Bidder may request permission to construct one (1) or more Temporary Access entrances or exits at a site, sites of its own choice or either abandoned Service Plaza 2 (MP49). Such Deduct Alternate request must be submitted with the Bidder's Bid, and must include the information specified in SP 104 and will be considered subject to the conditions and provisions contained in said SP 104.

The Bidder must fill in "yes" or "no" in the space provided below as to whether a Temporary Access Proposal is included with the Bid and must also enter an amount to be deducted from the Total Base Bid as a credit due to the Commission, should this Proposal be approved. (Refer to Articles 2.6.3 and 3.5.1 of the INSTRUCTIONS TO BIDDERS)

A **Temporary Access Deduct Alternate** Proposal is included in the Bid Submittal: _____. (yes or no)

Amount of **TEMPORARY ACCESS DEDUCT ALTERNATE**: _____

PROJECT 39-20-02 - TOTAL BASE BID (REF. No. 1 THRU REF. No. 315) MINUS DEDUCT ALTERNATES

CHECKING PRINT











CHECKED: _____ DATE: _____ CORRECTED: _____ DATE: _____

BACKCHECKED: _____ DATE: _____ APPROVED: _____ DATE: _____

nnnnnXG03.dwg; 1/09/20 - 12:28pm



FOR INFORMATION ONLY!

Elevations Table			
Number	Minimum Elevation	Maximum Elevation	Color
1	-5.000	-4.000	
2	-4.000	-3.000	
3	-3.000	-2.000	
4	-2.000	-1.000	
5	-1.000	0.000	
6	0.000	1.000	
7	1.000	2.000	
8	2.000	3.000	
9	3.000	4.000	
10	4.000	5.000	

<div style="display: flex; justify-content: space-between;"> <div> <div style="border: 1px solid black; border-radius: 50%; width: 40px; height: 40px; display: flex; align-items: center; justify-content: center;"> <div style="border: 1px solid black; border-radius: 50%; width: 20px; height: 20px; display: flex; align-items: center; justify-content: center;">XX</div> </div> </div> <div> <div style="border: 1px solid black; padding: 2px;">1 / 2</div> </div> </div>	<div style="display: flex; justify-content: space-between;"> <div>PROJECT 39-20-02B</div> <div>EXCAVATION AND EMBANKMENT EXHIBIT</div> </div>	<div style="display: flex; justify-content: space-between;"> <div>TP 49</div> <div>SOUTH SITE</div> </div>	<div style="display: flex; justify-content: space-between;"> <div>DESIGNED</div> <div>CHECKED</div> <div>BY</div> <div>DATE</div> </div>	<div style="display: flex; justify-content: space-between;"> <div>NO.</div> <div>REVISIONS</div> </div>	<div style="display: flex; justify-content: space-between;"> <div>AMS</div> <div>AMS</div> </div>	<div style="display: flex; justify-content: space-between;"> <div>IN CHARGE</div> <div>CSM</div> </div>	<div style="display: flex; justify-content: space-between;"> <div>DESIGNED</div> <div>CHECKED</div> <div>BY</div> <div>DATE</div> </div>	<div style="display: flex; justify-content: space-between;"> <div>AMS</div> <div>AMS</div> </div>	<div style="display: flex; justify-content: space-between;"> <div>IN CHARGE</div> <div>CSM</div> </div>	<div style="display: flex; justify-content: space-between;"> <div>DESIGNED</div> <div>CHECKED</div> <div>BY</div> <div>DATE</div> </div>	<div style="display: flex; justify-content: space-between;"> <div>AMS</div> <div>AMS</div> </div>	<div style="display: flex; justify-content: space-between;"> <div>IN CHARGE</div> <div>CSM</div> </div>	<div style="display: flex; justify-content: space-between;"> <div>DESIGNED</div> <div>CHECKED</div> <div>BY</div> <div>DATE</div> </div>	<div style="display: flex; justify-content: space-between;"> <div>AMS</div> <div>AMS</div> </div>	<div style="display: flex; justify-content: space-between;"> <div>IN CHARGE</div> <div>CSM</div> </div>	<div style="display: flex; justify-content: space-between;"> <div>DESIGNED</div> <div>CHECKED</div> <div>BY</div> <div>DATE</div> </div>	<div style="display: flex; justify-content: space-between;"> <div>AMS</div> <div>AMS</div> </div>	<div style="display: flex; justify-content: space-between;"> <div>IN CHARGE</div> <div>CSM</div> </div>	<div style="display: flex; justify-content: space-between;"> <div>DESIGNED</div> <div>CHECKED</div> <div>BY</div> <div>DATE</div> </div>	<div style="display: flex; justify-content: space-between;"> <div>AMS</div> <div>AMS</div> </div>	<div style="display: flex; justify-content: space-between;"> <div>IN CHARGE</div> <div>CSM</div> </div>	<div style="display: flex; justify-content: space-between;"> <div>DESIGNED</div> <div>CHECKED</div> <div>BY</div> <div>DATE</div> </div>	<div style="display: flex; justify-content: space-between;"> <div>AMS</div> <div>AMS</div> </div>	<div style="display: flex; justify-content: space-between;"> <div>IN CHARGE</div> <div>CSM</div> </div>	<div style="display: flex; justify-content: space-between;"> <div>DESIGNED</div> <div>CHECKED</div> <div>BY</div> <div>DATE</div> </div>	<div style="display: flex; justify-content: space-between;"> <div>AMS</div> <div>AMS</div> </div>	<div style="display: flex; justify-content: space-between;"> <div>IN CHARGE</div> <div>CSM</div> </div>	<div style="display: flex; justify-content: space-between;"> <div>DESIGNED</div> <div>CHECKED</div> <div>BY</div> <div>DATE</div> </div>	<div style="display: flex; justify-content: space-between;"> <div>AMS</div> <div>AMS</div> </div>	<div style="display: flex; justify-content: space-between;"> <div>IN CHARGE</div> <div>CSM</div> </div>	<div style="display: flex; justify-content: space-between;"> <div>DESIGNED</div> <div>CHECKED</div> <div>BY</div> <div>DATE</div> </div>	<div style="display: flex; justify-content: space-between;"> <div>AMS</div> <div>AMS</div> </div>	<div style="display: flex; justify-content: space-between;"> <div>IN CHARGE</div> <div>CSM</div> </div>	<div style="display: flex; justify-content: space-between;"> <div>DESIGNED</div> <div>CHECKED</div> <div>BY</div> <div>DATE</div> </div>	<div style="display: flex; justify-content: space-between;"> <div>AMS</div> <div>AMS</div> </div>	<div style="display: flex; justify-content: space-between;"> <div>IN CHARGE</div> <div>CSM</div> </div>	<div style="display: flex; justify-content: space-between;"> <div>DESIGNED</div> <div>CHECKED</div> <div>BY</div> <div>DATE</div> </div>	<div style="display: flex; justify-content: space-between;"> <div>AMS</div> <div>AMS</div> </div>	<div style="display: flex; justify-content: space-between;"> <div>IN CHARGE</div> <div>CSM</div> </div>	<div style="display: flex; justify-content: space-between;"> <div>DESIGNED</div> <div>CHECKED</div> <div>BY</div> <div>DATE</div> </div>	<div style="display: flex; justify-content: space-between;"> <div>AMS</div> <div>AMS</div> </div>	<div style="display: flex; justify-content: space-between;"> <div>IN CHARGE</div> <div>CSM</div> </div>	<div style="display: flex; justify-content: space-between;"> <div>DESIGNED</div> <div>CHECKED</div> <div>BY</div> <div>DATE</div> </div>	<div style="display: flex; justify-content: space-between;"> <div>AMS</div> <div>AMS</div> </div>	<div style="display: flex; justify-content: space-between;"> <div>IN CHARGE</div> <div>CSM</div> </div>	<div style="display: flex; justify-content: space-between;"> <div>DESIGNED</div> <div>CHECKED</div> <div>BY</div> <div>DATE</div> </div>	<div style="display: flex; justify-content: space-between;"> <div>AMS</div> <div>AMS</div> </div>	<div style="display: flex; justify-content: space-between;"> <div>IN CHARGE</div> <div>CSM</div> </div>	<div style="display: flex; justify-content: space-between;"> <div>DESIGNED</div> <div>CHECKED</div> <div>BY</div> <div>DATE</div> </div>	<div style="display: flex; justify-content: space-between;"> <div>AMS</div> <div>AMS</div> </div>	<div style="display: flex; justify-content: space-between;"> <div>IN CHARGE</div> <div>CSM</div> </div>	<div style="display: flex; justify-content: space-between;"> <div>DESIGNED</div> <div>CHECKED</div> <div>BY</div> <div>DATE</div> </div>	<div style="display: flex; justify-content: space-between;"> <div>AMS</div> <div>AMS</div> </div>	<div style="display: flex; justify-content: space-between;"> <div>IN CHARGE</div> <div>CSM</div> </div>	<div style="display: flex; justify-content: space-between;"> <div>DESIGNED</div> <div>CHECKED</div> <div>BY</div> <div>DATE</div> </div>	<div style="display: flex; justify-content: space-between;"> <div>AMS</div> <div>AMS</div> </div>	<div style="display: flex; justify-content: space-between;"> <div>IN CHARGE</div> <div>CSM</div> </div>	<div style="display: flex; justify-content: space-between;"> <div>DESIGNED</div> <div>CHECKED</div> <div>BY</div> <div>DATE</div> </div>	<div style="display: flex; justify-content: space-between;"> <div>AMS</div> <div>AMS</div> </div>	<div style="display: flex; justify-content: space-between;"> <div>IN CHARGE</div> <div>CSM</div> </div>	<div style="display: flex; justify-content: space-between;"> <div>DESIGNED</div> <div>CHECKED</div> <div>BY</div> <div>DATE</div> </div>	<div style="display: flex; justify-content: space-between;"> <div>AMS</div> <div>AMS</div> </div>	<div style="display: flex; justify-content: space-between;"> <div>IN CHARGE</div> <div>CSM</div> </div>	<div style="display: flex; justify-content: space-between;"> <div>DESIGNED</div> <div>CHECKED</div> <div>BY</div> <div>DATE</div> </div>	<div style="display: flex; justify-content: space-between;"> <div>AMS</div> <div>AMS</div> </div>	<div style="display: flex; justify-content: space-between;"> <div>IN CHARGE</div> <div>CSM</div> </div>	<div style="display: flex; justify-content: space-between;"> <div>DESIGNED</div> <div>CHECKED</div> <div>BY</div> <div>DATE</div> </div>	<div style="display: flex; justify-content: space-between;"> <div>AMS</div> <div>AMS</div> </div>	<div style="display: flex; justify-content: space-between;"> <div>IN CHARGE</div> <div>CSM</div> </div>	<div style="display: flex; justify-content: space-between;"> <div>DESIGNED</div> <div>CHECKED</div> <div>BY</div> <div>DATE</div> </div>	<div style="display: flex; justify-content: space-between;"> <div>AMS</div> <div>AMS</div> </div>	<div style="display: flex; justify-content: space-between;"> <div>IN CHARGE</div> <div>CSM</div> </div>	<div style="display: flex; justify-content: space-between;"> <div>DESIGNED</div> <div>CHECKED</div> <div>BY</div> <div>DATE</div> </div>	<div style="display: flex; justify-content: space-between;"> <div>AMS</div> <div>AMS</div> </div>	<div style="display: flex; justify-content: space-between;"> <div>IN CHARGE</div> <div>CSM</div> </div>	<div style="display: flex; justify-content: space-between;"> <div>DESIGNED</div> <div>CHECKED</div> <div>BY</div> <div>DATE</div> </div>	<div style="display: flex; justify-content: space-between;"> <div>AMS</div> <div>AMS</div> </div>	<div style="display: flex; justify-content: space-between;"> <div>IN CHARGE</div> <div>CSM</div> </div>	<div style="display: flex; justify-content: space-between;"> <div>DESIGNED</div> <div>CHECKED</div> <div>BY</div> <div>DATE</div> </div>	<div style="display: flex; justify-content: space-between;"> <div>AMS</div> <div>AMS</div> </div>	<div style="display: flex; justify-content: space-between;"> <div>IN CHARGE</div> <div>CSM</div> </div> </
--	---	--	--	---	---	---	--	---	---	--	---	---	--	---	---	--	---	---	--	---	---	--	---	---	--	---	---	--	---	---	--	---	---	--	---	---	--	---	---	--	---	---	--	---	---	--	---	---	--	---	---	--	---	---	--	---	---	--	---	---	--	---	---	--	---	---	--	---	---	--	---	---	--	---	---	--	---	---	--	---	--

OHIO TURNPIKE AND INFRASTRUCTURE COMMISSION

CHECKING PRINT

CHECKED: DATE: CORRECTED: DATE: BACKCHECKED: DATE: APPROVED: DATE:

nnnnnXG03.dwg: 1/09/20 - 12:31pm

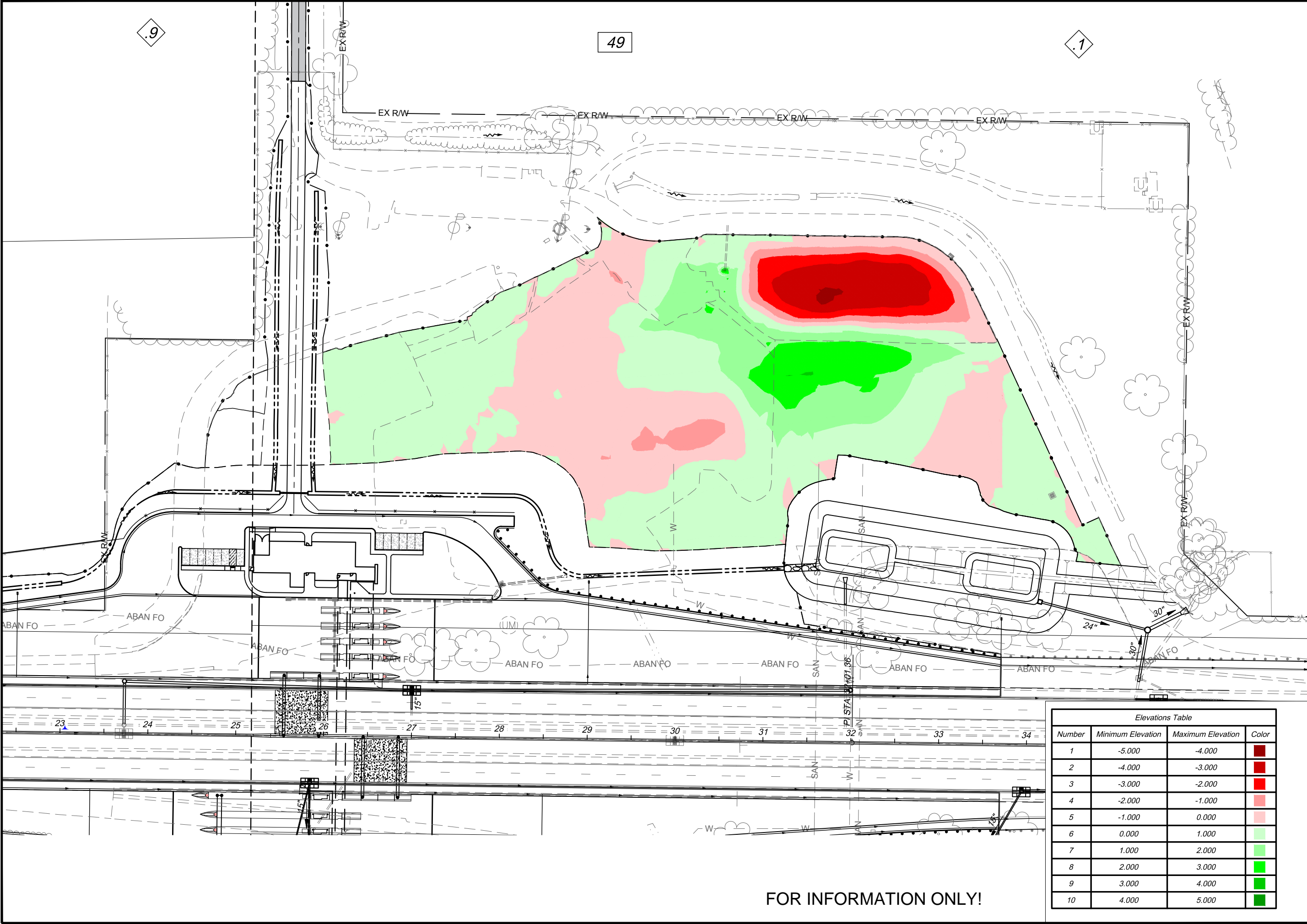

FOR INFORMATION ONLY!

Elevations Table			
Number	Minimum Elevation	Maximum Elevation	Color
1	-5.000	-4.000	Dark Red
2	-4.000	-3.000	Red
3	-3.000	-2.000	Light Red
4	-2.000	-1.000	Pink
5	-1.000	0.000	Light Pink
6	0.000	1.000	Light Green
7	1.000	2.000	Green
8	2.000	3.000	Dark Green
9	3.000	4.000	Very Dark Green
10	4.000	5.000	Black

PROJECT 39-20-02B

DATE: 12/20/2019

2 / 2

XX
59

EXCAVATION AND EMBANKMENT EXHIBIT

NORTH SITE

LUCAS COUNTY

TP 49

DESIGN AGENCY

JACOBS

1231 JAMES AVENUE 8 FLOOR
OFFICE 61743-922

OHIO TURNPIKE

OHIO TURNPIKE AND INFRASTRUCTURE COMMISSION

OHIO TURNPIKE