

### CONCRETE BARRIER DELINEATION

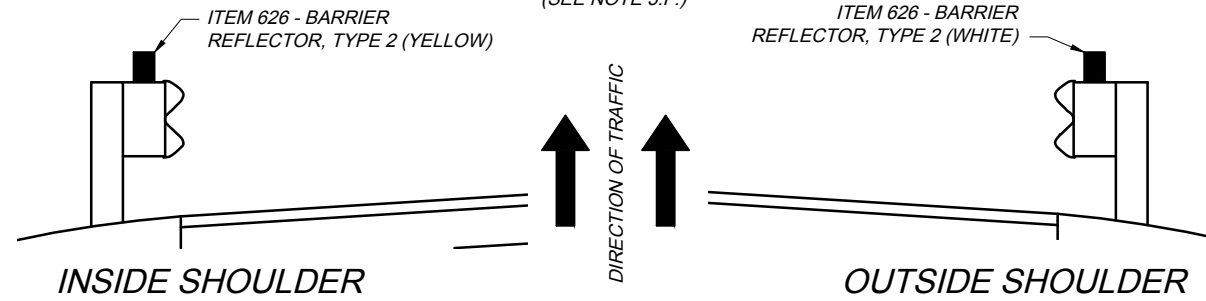

### GUARDRAIL DELINEATION

(SEE NOTE 3.F.)



### DELINEATOR POST

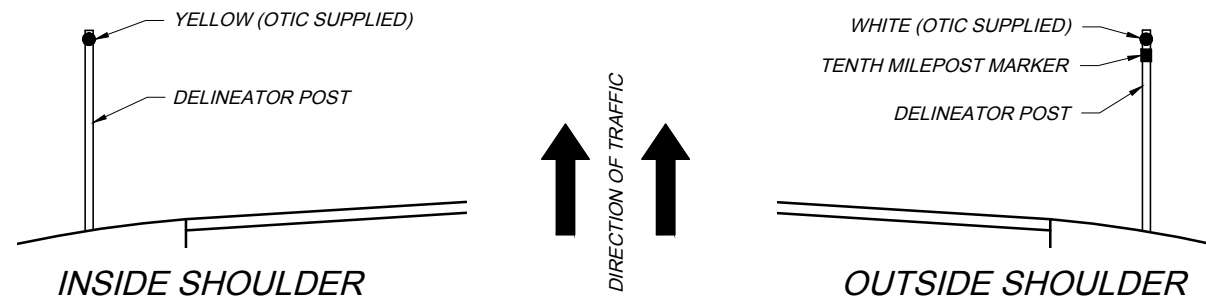

### FIGURE 1

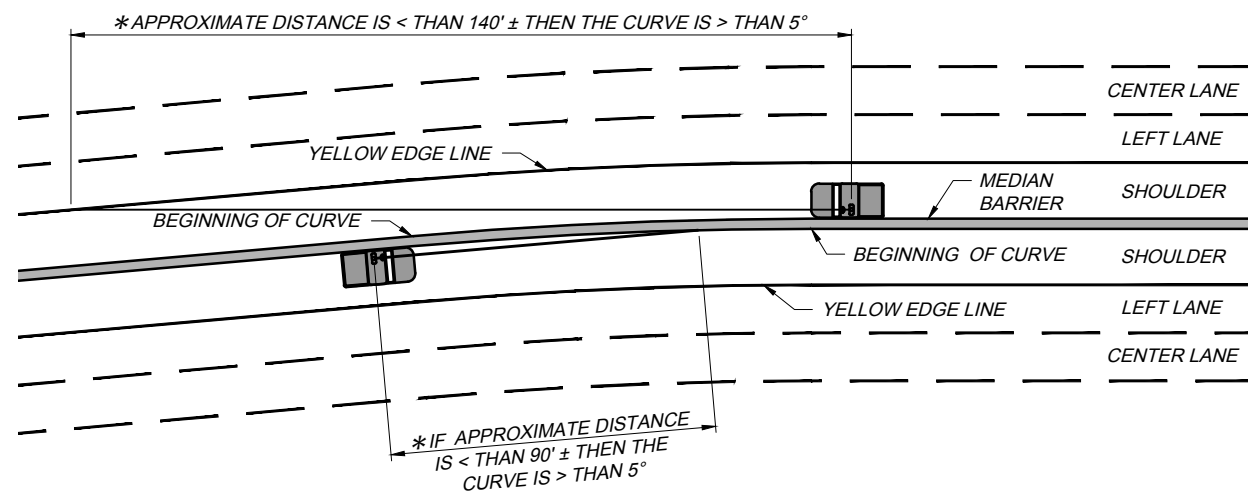

#### NOTE:

\* WORK VEHICLE MUST BE APPROXIMATELY ONE (1) FOOT FROM THE FACE OF THE BARRIER WITH THE FRONT OF THE WORK VEHICLE AT THE BEGINNING OF THE CURVE. THE APPROXIMATE DISTANCE IS TO BE MEASURED FROM THE DRIVERS POSITION IN WORK VEHICLE STRAIGHT AHEAD TO WHERE THE YELLOW EDGELINE OR CONCRETE BARRIER FACE INTERSECTS THE VIEWER'S LINE OF SIGHT. THE VIEWER'S BODY SHOULD BE PERPENDICULAR WITH THE TANGENT OF THE CURVE.

#### NOTES:

DELINEATION SHALL BE CONSISTENT IN SPACING, MOUNTING HEIGHT, ORIENTATION, AND RETROREFLECTIVITY.

#### 1. DELINEATOR POSTS

A. STEEL DELINEATOR POSTS SHALL BE INSTALLED EVERY TWENTIETH OF A MILE WITH THE APPROPRIATE REFLECTOR. "TENTH" DELINEATOR POSTS SHALL HAVE THE PROPER MARKER INSTALLED WITH A WHITE NUMBER ON A BLACK BACKGROUND.

#### 2. GUARDRAIL AND BARRIER DELINEATION LAYOUT, SPACING AND HEIGHT

A. THE CONTRACTOR SHALL LAYOUT ALL LOCATIONS TO ASSURE PROPER PLACEMENT. THE LAYOUT SHALL BE APPROVED BY THE CHIEF ENGINEER PRIOR TO INSTALLATION OF THE REFLECTORS.

B. ON 50-INCH CONCRETE BARRIERS, RETAINING WALLS AND BRIDGE PARAPETS, THE HEIGHT OF THE TOP OF THE REFLECTOR SHALL BE 44-INCHES ABOVE THE NEAR EDGE OF PAVEMENT, EXCEPT THAT THE TOP OF THE REFLECTOR SHALL NOT BE LESS THAN 3-INCHES BELOW THE TOP OF THE CONCRETE BARRIER, RETAINING WALL OR BRIDGE PARAPET, AND FOR 32-INCH CONCRETE BARRIERS, RETAINING WALLS AND BRIDGE PARAPETS, THE HEIGHT OF THE TOP OF THE REFLECTOR SHALL BE 26-INCHES ABOVE THE NEAR EDGE OF PAVEMENT, EXCEPT THAT THE TOP OF THE REFLECTOR SHALL NOT BE LESS THAN 3-INCHES BELOW THE TOP OF THE CONCRETE BARRIER, RETAINING WALL OR BRIDGE PARAPET. THE REFLECTORS SHALL BE MOUNTED AT A 5-DEGREE ANGLE.

C. ALL BARRIERS SHALL HAVE A REFLECTOR AT THE BEGINNING AND THE END OF THE RUN AND AT LEAST ONE (1) EVENLY SPACED BETWEEN THE TERMINI. THE REFLECTORS SHALL BE SPACED AT 100 FEET ALONG TANGENTS AND ON CURVES OF LESS THAN 5-DEGREES. THE REFLECTORS SHALL BE SPACED AT 50 FEET FOR CURVES OF 5-DEGREES OR GREATER.

D. THE SPACING ON TANGENTS AND CURVES LESS THAN 5-DEGREES MAY VARY FROM 75 FEET TO 125 FEET IN THE FINAL 250 FEET TO ACHIEVE EVEN SPACING OF THE REFLECTORS.

E. WHEN GUARDRAIL, BARRIERS, RETAINING WALLS, OR BRIDGE PARAPETS ARE TIED TOGETHER IN A CONTINUOUS RUN, THE TOTAL LENGTH OF THE RUN SHALL BE USED FOR DETERMINING THE NUMBER AND LOCATION OF REFLECTORS.

F. WHEN A RUN OF BARRIER IS INSTALLED THAT IS AT VARYING DISTANCES FROM THE EDGE OF PAVEMENT, A REFLECTOR SHALL BE PLACED WHERE THE RUN FIRST APPROACHES CLOSEST TO THE PAVEMENT. IF THIS RESULTS IN SPACING GREATER THAN 125 FEET, OR 65 FEET IN CASES WHERE 50 FOOT STANDARD SPACING IS REQUIRED, AN ADDITIONAL REFLECTOR SHALL BE INSTALLED.

G. MEDIAN WALL DELINEATION: REDUCE SPACING TO 20 FEET WHERE BARRIER WALL IS WIDER AT BRIDGE PIERS AND OVERHEAD SIGN SUPPORTS. THE 20 FOOT SPACING SHALL BEGIN WHERE THE SHOULDER BEGINS TO NARROW.

H. BARRIER DELINEATION (BRIDGE PARAPET WALLS): ONE (1) PLACED 14 FEET FROM EACH END AND THEN EVENLY SPACED (50 FOOT MAXIMUM) BETWEEN THE ENDS. IF THERE ISN'T GUARDRAIL AT THE TRAILING END OF THE BRIDGE PARAPET, ADD A DELINEATOR TO THE END OF THE PARAPET.

I. BARRIER DELINEATION (PIER PROTECTION): ONE (1) PLACED 14 FEET FROM EACH END AND EVENLY SPACED (50 FOOT MAXIMUM) BETWEEN THE ENDS. A MINIMUM OF THREE (3) DELINEATORS SHALL BE PLACED ON EACH PIER PROTECTION RUN. IF THERE ISN'T GUARDRAIL AT THE TRAILING END OF THE PIER PROTECTION, ADD A DELINEATOR TO THE END OF THE PIER PROTECTION.

J. WHEN A NON-REFLECTORIZED IMPACT ATTENUATOR IS IN PLACE, AN ADDITIONAL REFLECTOR SHALL BE PLACED ON THE FACE OF THE ATTENUATOR NEAREST TO, AND DIRECTED TOWARD, APPROACHING TRAFFIC.

#### 3. BARRIER DELINEATION INSTALLATION

A. ATTACH THE REFLECTOR USING A SUITABLE ADHESIVE CONFORMING TO THE MANUFACTURER'S RECOMMENDATIONS.

B. THE SURFACE OF THE CONCRETE BARRIER SHALL BE WIRE BRUSHED TO REMOVE ANY LOOSE CONCRETE, DIRT OR OTHER LOOSE MATERIAL. DUST CREATED BY WIRE BRUSHING SHALL BE REMOVED PRIOR TO APPLICATION OF ADHESIVE. ADHESIVE SHALL BE APPLIED TO CLEAN AND MOISTURE-FREE SURFACES IN ACCORDANCE WITH THE MANUFACTURER'S RECOMMENDATIONS.

C. THE REFLECTIVE FACE SHALL BE CLEAN AND FREE OF DUST, DIRT, ADHESIVES OR ANY FOREIGN MATERIAL AFTER INSTALLATION.

D. WHEN REPLACING REFLECTORS ON A CONCRETE SURFACE, THE NEW LOCATION OF THE REFLECTOR SHALL BE APPROXIMATELY 3-INCHES HORIZONTALLY IN EITHER DIRECTION FROM THE OLD LOCATION.

E. THE BARRIER REFLECTORS SHALL BE THE SAME COLOR AS THE ADJACENT EDGE LINE.

F. GUARDRAIL REFLECTORS SHALL BE INSTALLED IN ACCORDANCE WITH CMS 626 AND ODOT STANDARD DRAWING TC-61.30.

#### 4. BARRIER REFLECTORS DURING CONSTRUCTION

A. WHEN TRAFFIC IS WITHIN (5) FEET OF THE ADJACENT BARRIER WALL, RETAINING WALL OR BRIDGE PARAPET, REFLECTORS SHALL BE INSTALLED AT A 25 FOOT NORMAL SPACING AND AT 10 FOOT SPACING IN ALL LOCATIONS WHERE THE MEDIAN SHOULDER NARROWS AT MEDIAN BRIDGE PIERS AND SIGN FOUNDATIONS, ETC. UPON COMPLETION OF THE PROJECT, THE CONTRACTOR SHALL CAREFULLY REMOVE, SO AS NOT TO OVERLY DAMAGE THE BARRIER FACE. THE APPROPRIATE NUMBER OF INSTALLED BARRIER REFLECTORS SHALL REMAIN SO THAT THE NUMBER AND SPACING COMPLY WITH THE REQUIREMENTS OF SP 626. THIS ITEM SHALL ALSO CONSIST OF REMOVING EXISTING REFLECTORS THAT ARE NOT PLACED AT THE APPROPRIATE LOCATION ON THE MEDIAN WALL AS SPECIFIED IN SP 626.

B. WHEN TRAFFIC IS WITHIN (5) FEET OF THE ADJACENT GUARDRAIL, REFLECTORS SHALL BE INSTALLED AT A 25 FOOT NORMAL SPACING. UPON COMPLETION OF THE PROJECT, THE CONTRACTOR SHALL REMOVE THE EXTRA REFLECTORS TO PRE-CONSTRUCTION LOCATIONS. THE APPROPRIATE NUMBER OF INSTALLED BARRIER REFLECTORS SHALL REMAIN SO THAT THE NUMBER AND SPACING COMPLY WITH THE REQUIREMENTS OF ITEM 626.

STANDARD DRAWING

TRAFFIC CONTROL  
MAINLINE DELINEATION

TC-3

1 / 2

DATE: JUNE 10, 2025

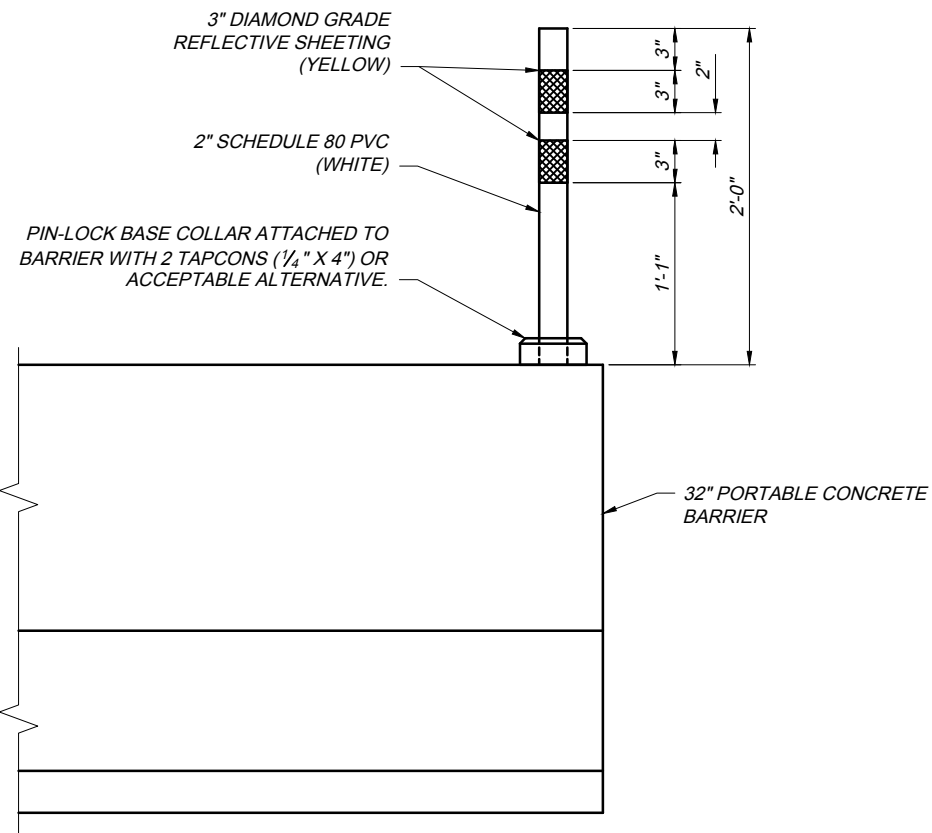

**MEDIAN BARRIER CROSS-OVER DELINEATOR**

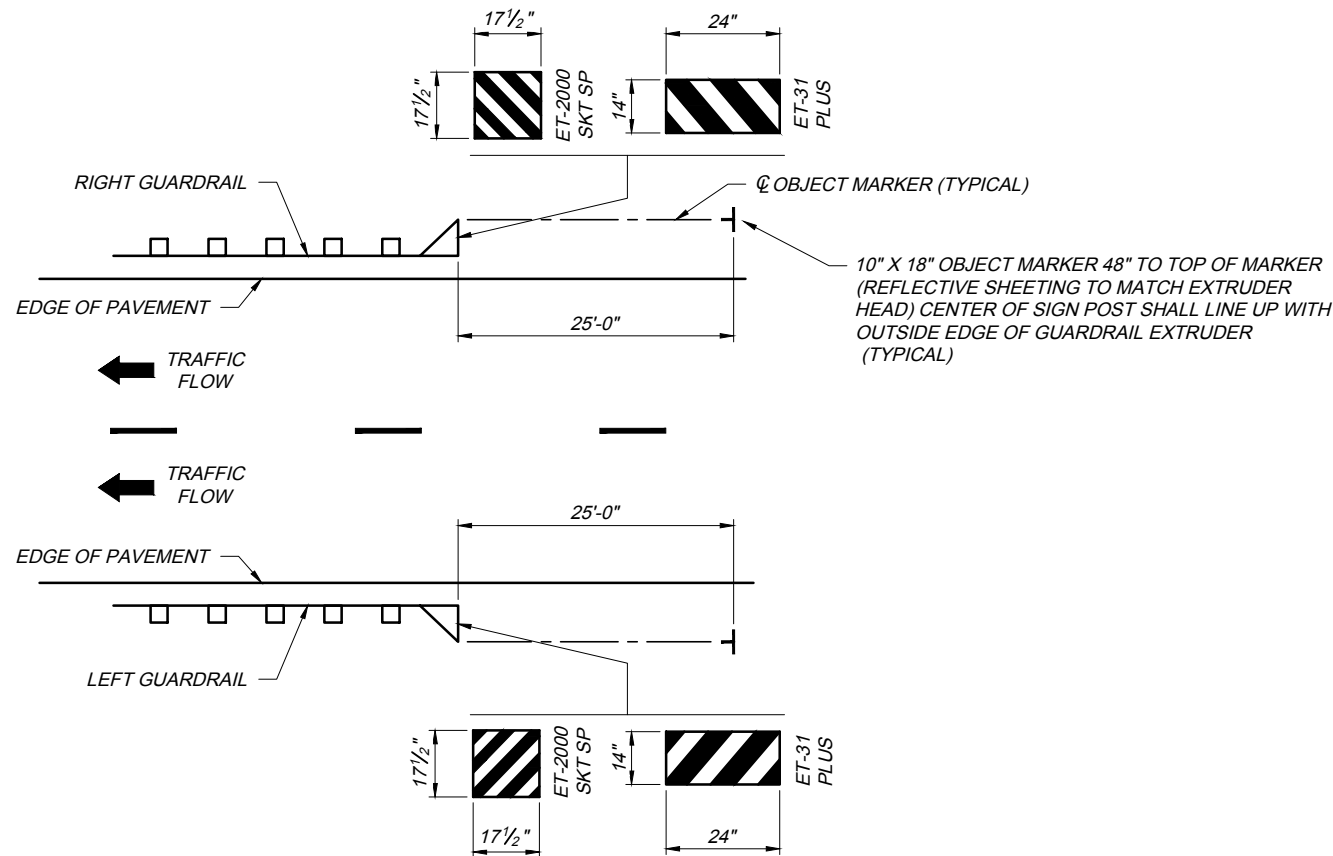
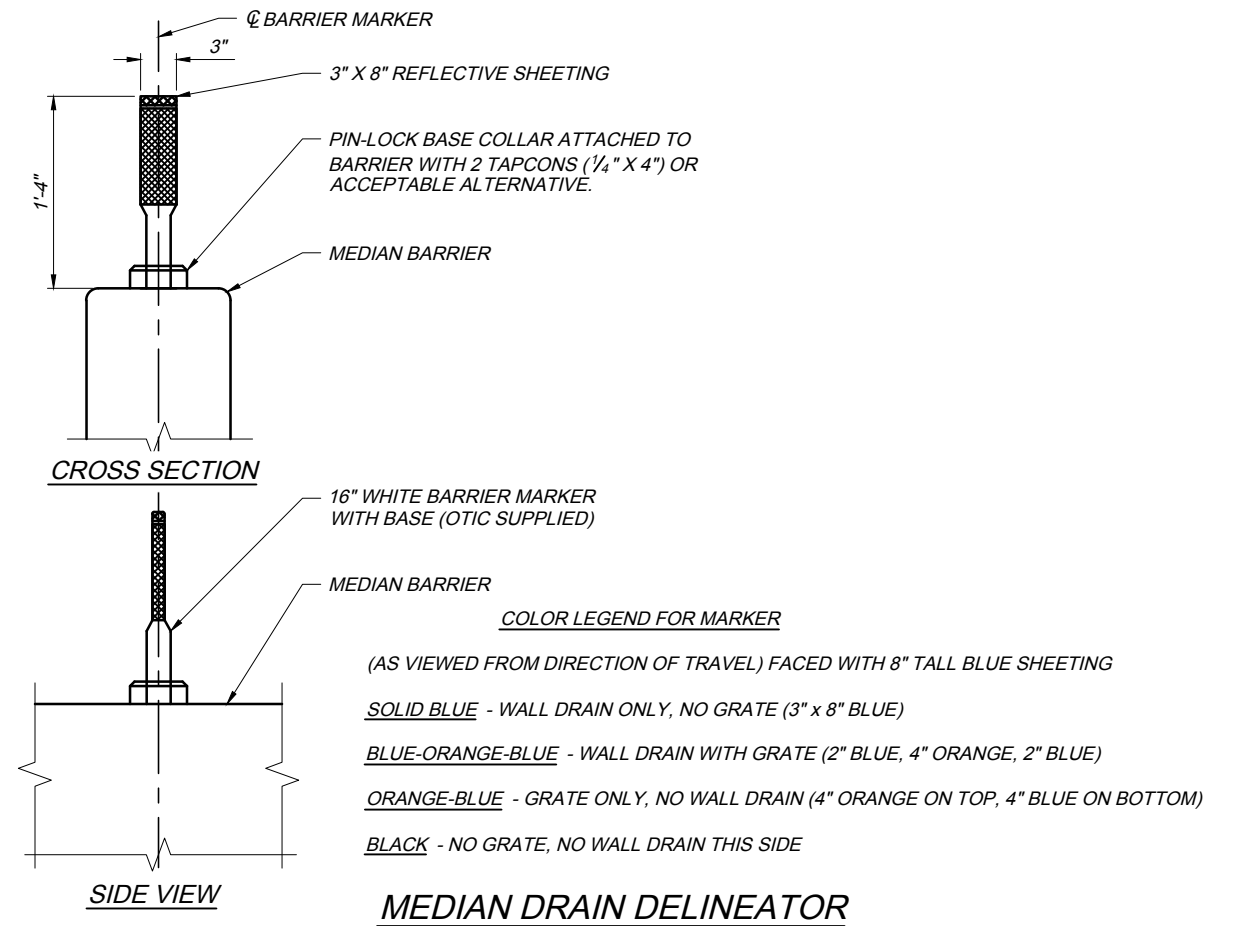

**GUARDRAIL EXTRUDER DELINEATOR**

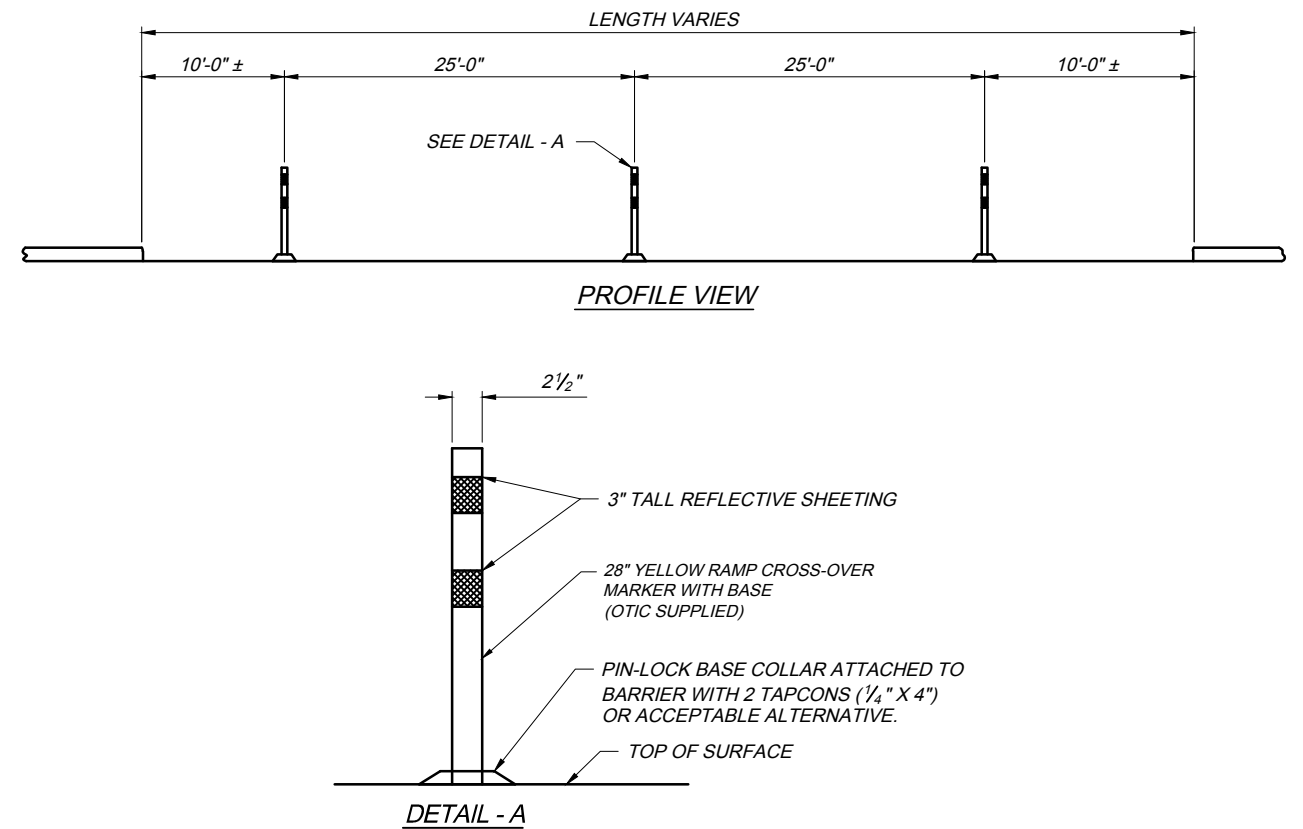

**TURNPIKE RAMP CROSS-OVER DELINEATORS**

TC-3 2025.06.10.dwg; 6/12/25 - 3:49pm

STANDARD DRAWING

DATE: JUNE 10, 2025

TRAFFIC CONTROL  
MISCELLANEOUS DELINEATION

TC-3

2 / 2

